

## EXECUTIVE SUMMARY



### OFFERING SUMMARY

Lease Rate:	Negotiable
Building Size:	33,989 SF
Available SF:	4,918 - 6,300 SF
Number of Units:	8
Market:	Edmond

### PROPERTY OVERVIEW

Danforth Square sits at the southeast corner of Danforth & Kelly. Over 47,000 vehicles pass the site daily. Ideal for shipping, warehouse, or studios that do not require store front visibility. Access provided in the common hallway. Co-tenants include: Hallmark, Los Arcos Mexican Restaurant, Impact Dance Studio, E & J's Liquor and Wine, No Limits Health & Fitness, and Oklaboba. Surrounding businesses include: Hobby Lobby, Walmart, Dollar General, Dollar Tree, Starbucks, MidFirst Bank, Ace Hardware, McDonald's and more.

### PROPERTY HIGHLIGHTS

- 840 W Danforth - 6,300 SF
- Former restaurant, end cap suite with a private loading dock. Large kitchen with two massive vent hoods, 3 walk ins, and plenty of room for washing, food prep, etc. In the kitchen area are three rooms good for management offices, conference rooms, etc. Suite is ready to be finished per tenant requirements.
- 844 W Danforth - 4,918 SF
- Access through the common area hallway with two large open areas, private loading dock, etc.

troy@creekcre.com  
405.219.7500  
**TROY HUMPHREY**

## AERIAL



Available Suite



troy@creekcre.com  
405.219.7500  
TROY HUMPHREY

## SITE PLAN

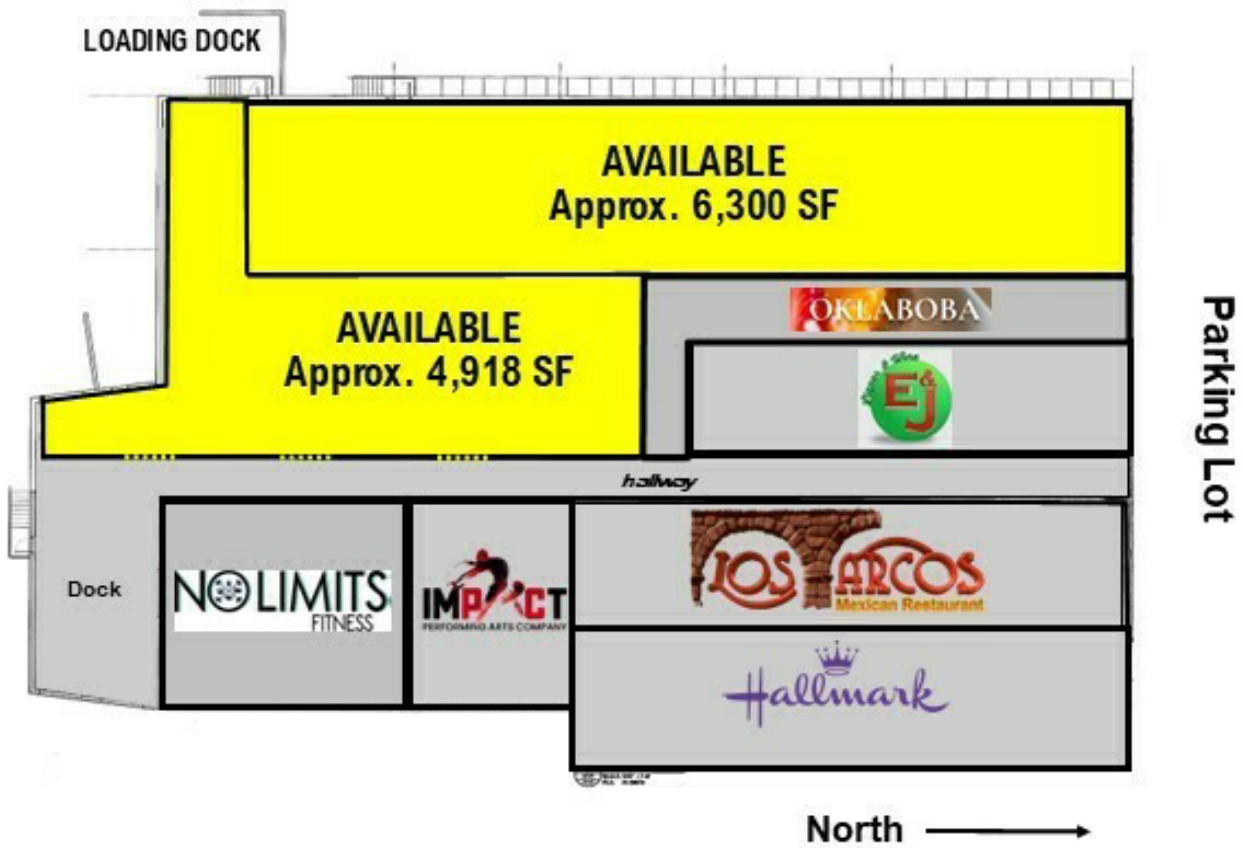

troy@creekcre.com  
405.219.7500  
TROY HUMPHREY

PHOTOS- 4,918 SF SUITE



troy@creekcre.com  
405.219.7500  
**TROY HUMPHREY**

## 6,300 SF SUITE FLOOR PLAN

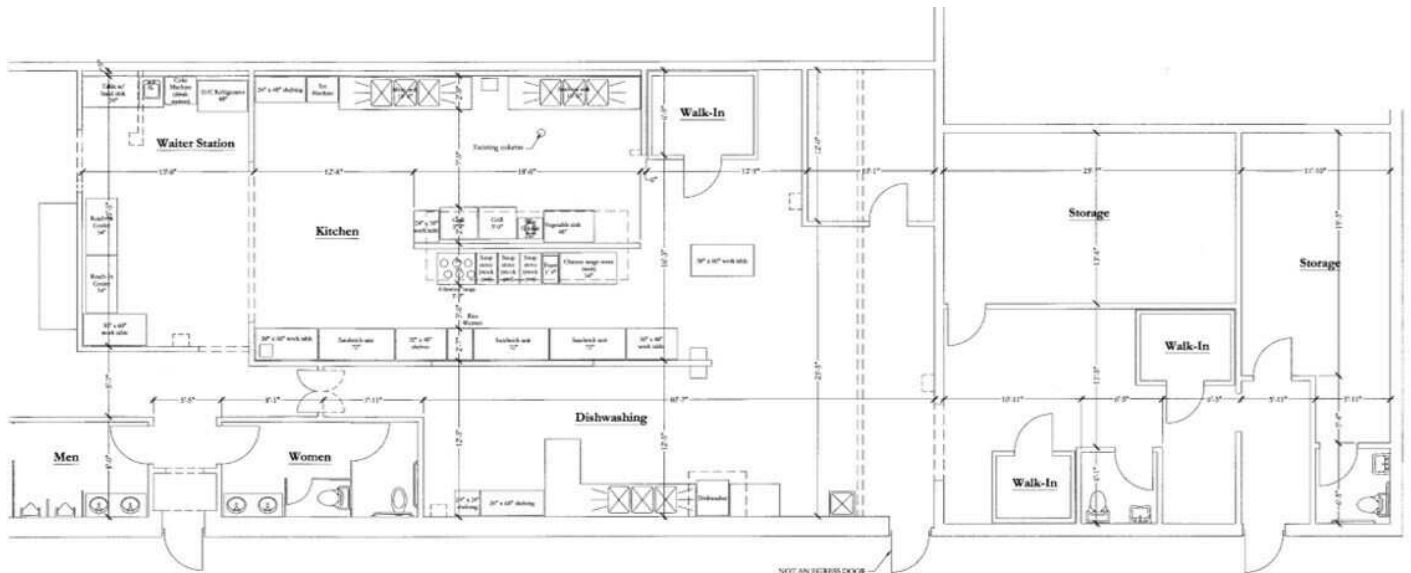
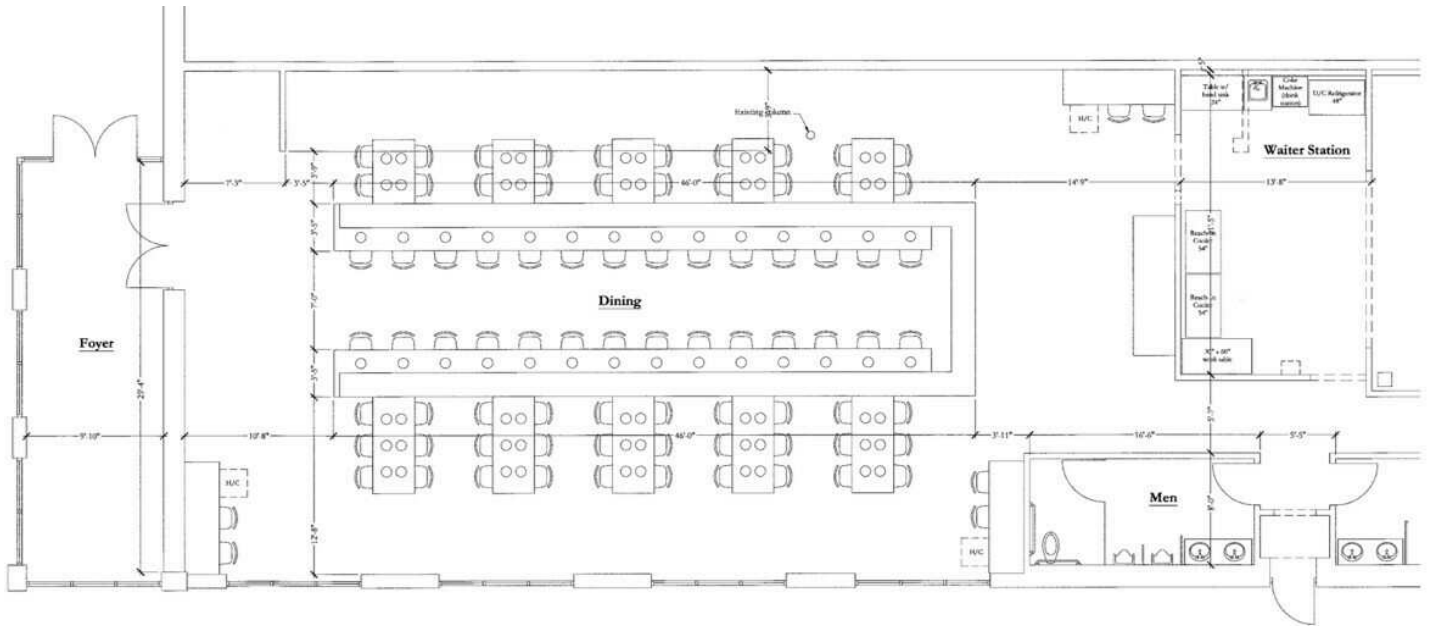

troy@creekcre.com  
405.219.7500  
TROY HUMPHREY

## LOCATION MAP



troy@creekcre.com  
405.219.7500  
**TROY HUMPHREY**

## DEMOGRAPHICS MAP & REPORT

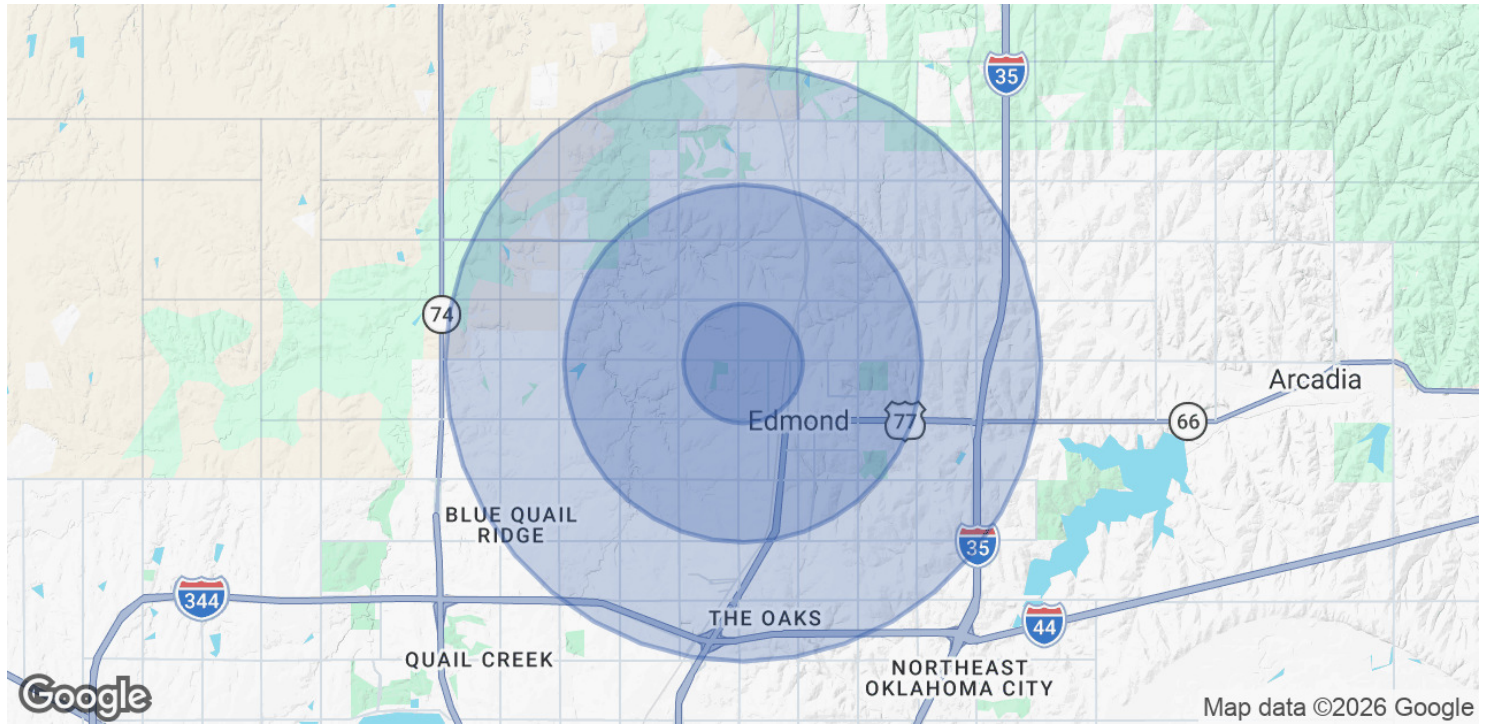

POPULATION	1 MILE	3 MILES	5 MILES
Total Population	10,727	79,143	160,746
Average Age	37	38	38
Average Age (Male)	35	37	37
Average Age (Female)	38	40	39
HOUSEHOLDS & INCOME	1 MILE	3 MILES	5 MILES
Total Households	4,387	30,567	61,432
# of Persons per HH	2.4	2.6	2.6
Average HH Income	\$81,063	\$119,264	\$131,733
Average House Value	\$240,354	\$323,939	\$360,324

2020 American Community Survey (ACS)

troy@creekcre.com  
405.219.7500  
**TROY HUMPHREY**