







## Marshall Business Center

4491 Whiting Road, Marshall, Virginia 20115



### PROPERTY HIGHLIGHTS

-  83,600 SF available featuring 30' Clear Ceiling
-  ESFR sprinkler system
-  Warehouse space featuring office area, reception, break room, restrooms
-  Located off Route 66 with access to Highway 17 (Winchester Rd) and Highway 55 (John Marshall Hwy)
-  1.5 miles from downtown Marshall, with local shops and restaurants on Main Street
-  Convenient access to Manassas Regional and Dulles International Airports

### LOCATION

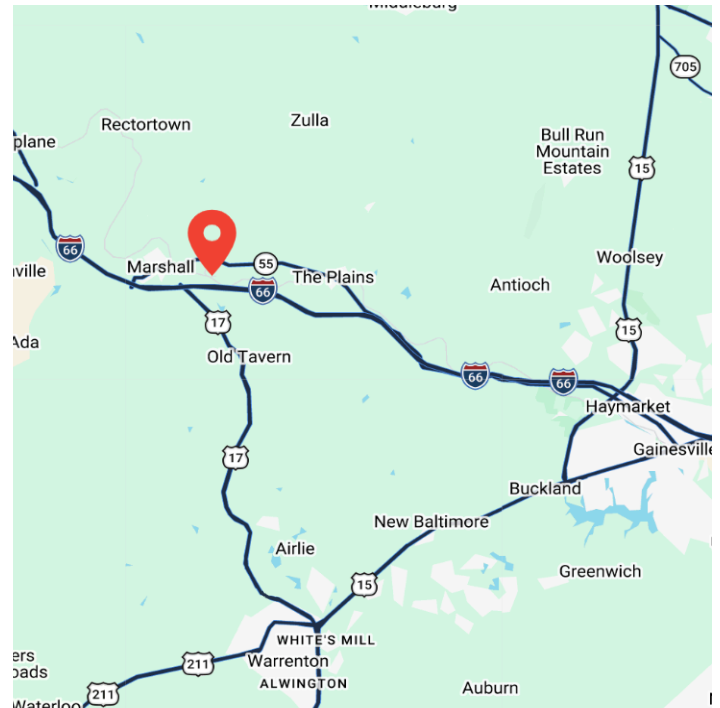

**PETE MCCABE**

 (703)631-9307(p) | (703)906-9947(m)

 pmccabe@pruittcorp.com  [www.pruittcorp.com](http://www.pruittcorp.com)

# Marshall Business Center

4491 Whiting Road, Marshall, Virginia 20115

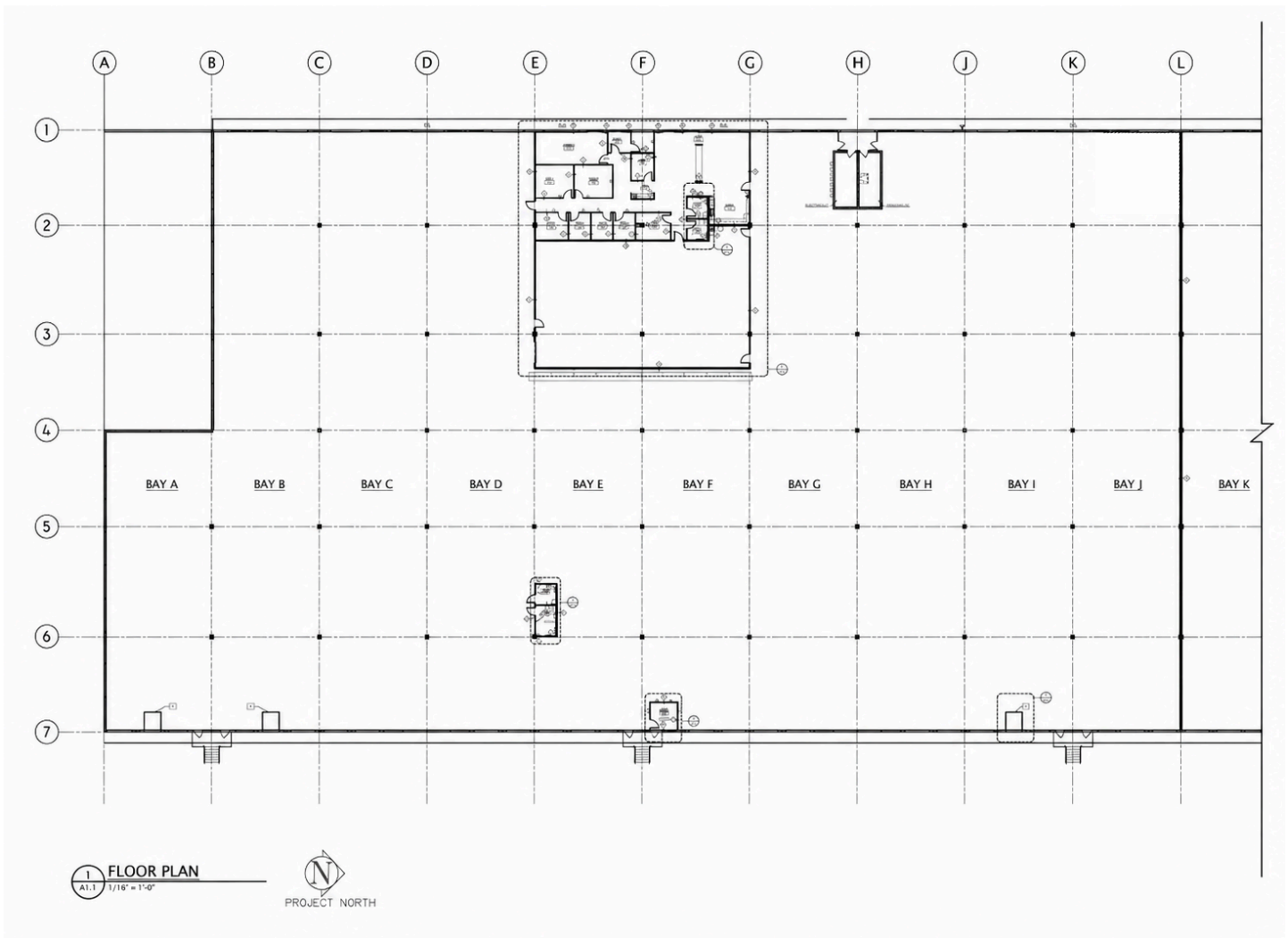

**PETE MCCABE**

(703)631-9307(p) | (703)906-9947(m)

pmccabe@pruittcorp.com [www.pruittcorp.com](http://www.pruittcorp.com)