

Property



Property Address: 498 Delaware Ave
Municipality: City of kingston
Tax ID: 56.27-7-14

Summary

SWIS 510800
 Status Active
 Roll Section Taxable
 Property Class 483 - Converted Res
 Ownership Code
 In Ag District No
 Zoning T4MS - T4 Main Street
 Neighborhood 8005 Midtown
 School District KINGSTON CONSOLIDA
 Property Description
 Total Acreage/Size 61 x 100
 Deed Book 02442
 Deed Page 00213
 Grid East 632881
 Grid North 1127307



05/17/2007 - Photo

Owners

[Michael Wolff](#)
 15 Purvis St
 Kingston, NY 12401

Valuation

Assessed Year	2025	2024
Equalization Rate	47.00%	57.00%
Land Assessment	\$27,000	\$27,000
Total Assessment	\$160,000	\$160,000
Full Market Value	\$340,426	\$280,702

Special Districts

Year	Description	Type	Units	Percent	Value
2025	LB009 - Kingston Libry Debt		0	0%	\$0
2025	LB008 - Kingston library		0	0%	\$0
2024	LB008 - Kingston library		0	0%	\$0
2024	LB009 - Kingston Libry Debt		0	0%	\$0

Land

Site	Land Type	Size
Com 1	Primary	0.11 acres

Historic Deed

Book/Page	Prior Printkey
02442 / 00213	000000000

Inventory

Site Com 1
 Overall EFF Year Built 1890
 Overall Condition Normal
 Overall Grade Average
 Overall Desirability Superior

Commercial Buildings

Site	Com 1
Air Cond. %	0
Sprinkler %	0
Alarm %	0
Elevators	0
Basement Type	Unfinished
Year Built	1890

Eff Year Built	
Condition	Normal
Quality	Average
Gross Floor Area	2,488
Stories	2
Nbr Identical Bldgs	1

Utilities

Site	Com 1
Sewer Type	Comm/public

Water Supply	Comm/public
Utilities	Gas & elec

Site Uses

Site	Use	Rentable Area	Total Units
Com 1	Nbhd tavern	991	0
Com 1	Row apt	1,487	2

Improvements

Site	Structure	Size	Grade	Condition	Year Built	Replacement Cost
Com 1	Shed-machine	28 sq ft	Economy	Fair	1890	\$0
Com 1	Porch-coverd	121 sq ft	Economy	Fair	1890	\$0

Historical Tax Summary

Tax Year	Tax Type	Original Bill	Total Assessed Value	Full Market Value	Uniform %	Roll Section
2026	County	\$3,623.07	\$160,000.00	\$340,426.00	47.00%	1
2025	School	\$6,316.84	\$160,000.00	\$340,426.00	47.00%	1
2025	County	\$3,289.20	\$160,000.00	\$280,702.00	57.00%	1
2024	School	\$5,662.51	\$160,000.00	\$280,702.00	57.00%	1
2024	County	\$3,013.86	\$160,000.00	\$262,295.00	61.00%	1
2023	School	\$5,463.55	\$160,000.00	\$262,295.00	61.00%	1
2023	County	\$2,990.58	\$160,000.00	\$228,571.00	70.00%	1
2022	School	\$5,255.77	\$160,000.00	\$228,571.00	70.00%	1
2022	County	\$3,076.80	\$160,000.00	\$197,531.00	81.00%	1
2021	School	\$5,153.50	\$160,000.00	\$197,531.00	81.00%	1
2021	County	\$3,058.36	\$160,000.00	\$177,778.00	90.00%	1
2020	School	\$5,059.81	\$160,000.00	\$177,778.00	90.00%	1
2020	County	\$3,035.92	\$160,000.00	\$160,000.00	100.00%	1
2019	School	\$4,818.27	\$160,000.00	\$160,000.00	100.00%	1
2019	County	\$2,976.48	\$145,000.00	\$145,000.00	100.00%	1
2018	School	\$4,586.61	\$145,000.00	\$145,000.00	100.00%	1
2018	County	\$2,970.73	\$132,000.00	\$132,000.00	100.00%	1
2017	School	\$4,240.41	\$132,000.00	\$132,000.00	100.00%	1
2017	County	\$3,075.10	\$132,000.00	\$132,000.00	100.00%	1
2016	School	\$4,225.16	\$132,000.00	\$132,000.00	100.00%	1
2016	County	\$3,100.90	\$132,000.00	\$132,000.00	100.00%	1
2015	School	\$4,150.16	\$132,000.00	\$132,000.00	100.00%	1
2015	County	\$3,017.24	\$132,000.00	\$132,000.00	100.00%	1
2014	School	\$4,044.91	\$132,000.00	\$132,000.00	100.00%	1
2014	County	\$2,923.18	\$132,000.00	\$132,000.00	100.00%	1

Taxes reflect exemptions, but may not include recent changes in assessment.

Taxable Values

Tax Year	2025	2024
County Taxable	\$160,000	\$160,000
County Taxable Exemptions	\$0	\$0
Municipality Taxable	\$160,000	\$160,000
Municipality Taxable Exemptions	\$0	\$0
Village Taxable		
Village Taxable Exemptions		
School Taxable	\$160,000	\$160,000
School Taxable Exemptions	\$0	\$0

Documents

Property Record Card (PDF)

Photos



05/17/2007 - Photo

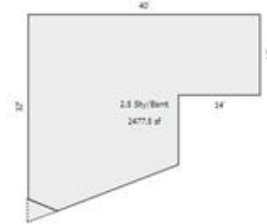

Sketch by Acon Viteira™

07/28/2008 - Sketch

Real Property Transfer Application

RP-5217 Form

No data available for the following modules: Comparable Search (Res), Sales, Residential Buildings, Exemptions.

Ulster County has compiled the data and images contained on this site for the sole purpose of assessing property for taxation. The information contained on this site is generated from various sources and is a reflection of the information submitted to Ulster County Assessment Office. All information contained on this site constitutes public records and is otherwise available to the public pursuant to freedom of information laws.
[User Privacy Policy](#) | [GDPR Privacy Notice](#)
Last Data Upload: 4/23/2026, 8:52:27 PM

Contact Us

Developed by
 **SCHNEIDER**
GEOSPATIAL