

41745

ELM STREET, SUITE 201
MURRIETA, CA 92562

FOR SALE
±2,397 SF INDUSTRIAL
CONDO



FEATURES:

- ONE (1) 10'X12' AUTOMATIC GROUND LEVEL ROLL UP DOOR
- 200 AMP, 120/208 V / 3 PHASE (VERIFY)
- 16' WAREHOUSE CLEAR HEIGHT
- **INTERIOR FEATURES:**
 - RECEPTION AREA
 - ONE (1) PRIVATE OFFICE
 - RESTROOM
- EXCELLENT LOCATION NEAR JEFFERSON AVENUE AND THE I-15 FREEWAY
- ZONING: GENERAL INDUSTRIAL (GI) - CITY OF MURRIETA (VERIFY)
- PROFESSIONAL MANAGED OWNERS ASSOCIATION
 - LOW ASSOCIATION FEES
- CALL TO TOUR

ASKING PRICE:
\$695,000.00

GORDON MIZE

951.445.4504
gmize@leetemecula.com
DRE#: 01275376

BEN WELLER

951.445.4561
bweller@leetemecula.com
DRE#: 02254521

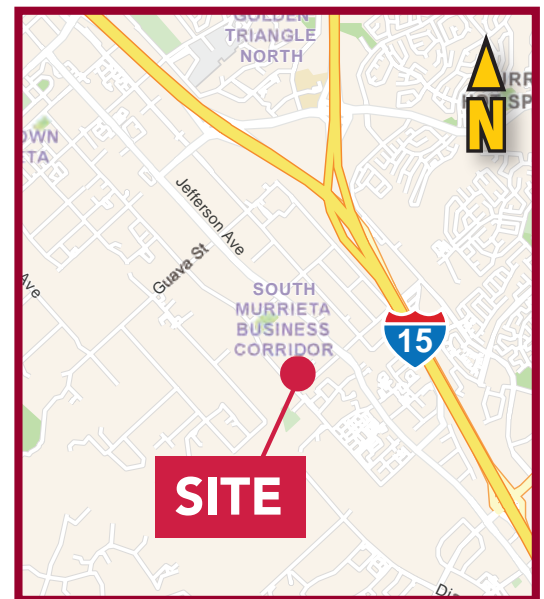

41745

ELM STREET, SUITE 201
MURRIETA, CA 92562

FOR SALE
±2,397 SF INDUSTRIAL
CONDO

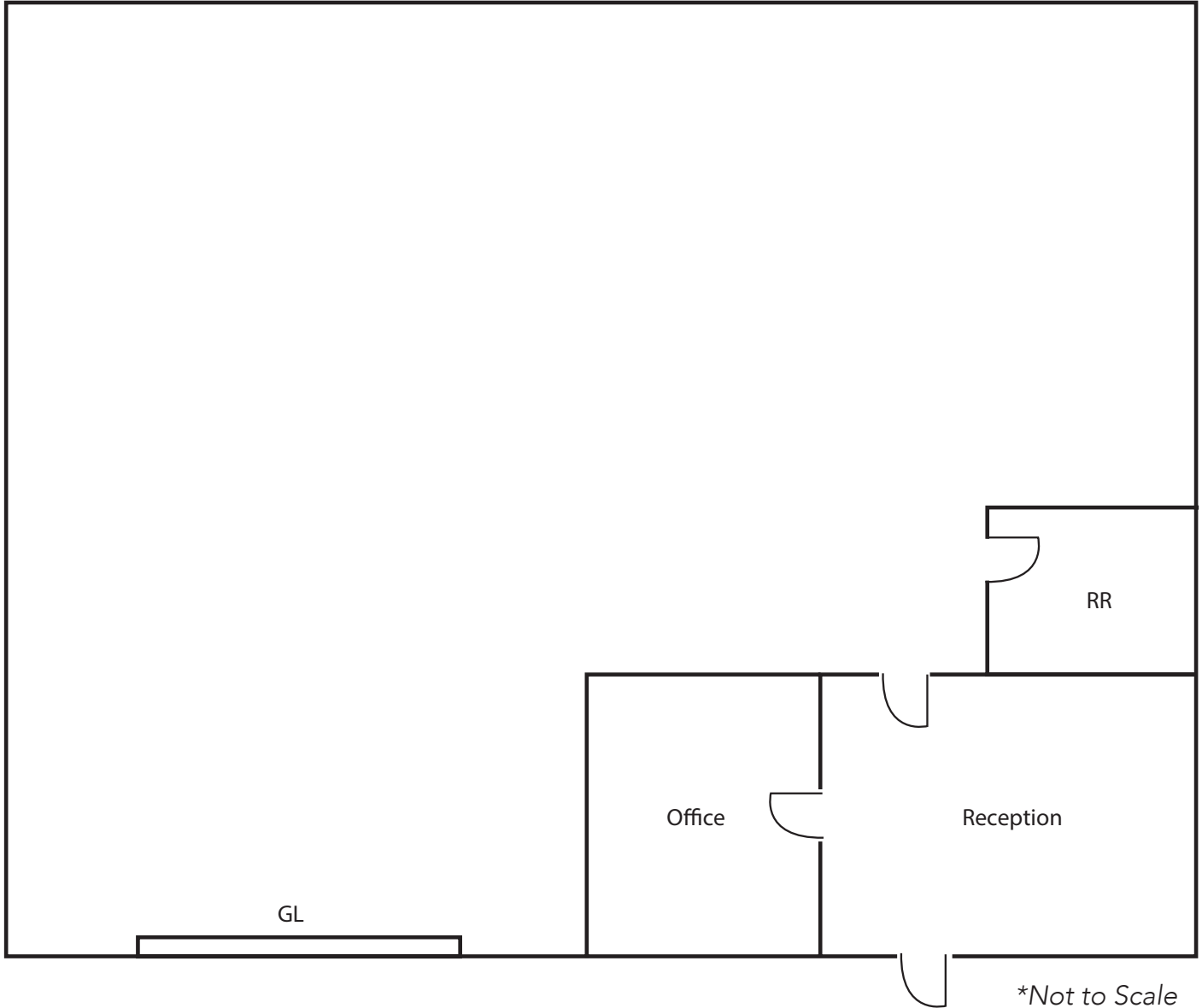

GORDON MIZE

951.445.4504
gmize@leetemecula.com
DRE#: 01275376

BEN WELLER

951.445.4561
bweller@leetemecula.com
DRE#: 02254521

41745

ELM STREET, SUITE 201
MURRIETA, CA 92562

FOR SALE
±2,397 SF INDUSTRIAL
CONDO



GORDON MIZE

951.445.4504
gmize@leetemecula.com
DRE#: 01275376

BEN WELLER

951.445.4561
bweller@leetemecula.com
DRE#: 02254521



No warranty or representation has been made to the accuracy of the foregoing information. Terms of sale or lease and availability are subject to change or withdrawal without notice. Lee & Associates Commercial Real Estate Services, Inc. - Riverside. 25240 Hancock Avenue, Suite 100 - Murrieta, CA 92562 Corporate ID# 01048055

41745

ELM STREET, SUITE 201
MURRIETA, CA 92562

FOR SALE
±2,397 SF INDUSTRIAL
CONDO



GORDON MIZE

951.445.4504
gmize@leetemecula.com
DRE#: 01275376

BEN WELLER

951.445.4561
bweller@leetemecula.com
DRE#: 02254521