

# Regional Distribution Space

Serving The Northeast & Mid-Atlantic

736 Addison Road  
Painted Post, NY 14870

408,000 Square Foot Warehouse & Logistics Facility On Interstate-99



## Property Overview

CBRE Upstate NY is pleased to offer for sale or lease a 408,000 square foot industrial warehouse with superior access to Interstate-99. The building features 39'-45' clear height and outstanding loading with 27 dock height doors and an additional 4 drive-in doors. Built in 2006, the property is sprinklered and heated throughout. Two entry/exit points to I-99 are located less than 5 minutes from the building.

## Offering Details

- + 408,000± Square Feet, Expandable by 195,000 SF
- + Minutes From I-99
- + 39'-45' Clear Height
- + Sale Price: Negotiable
- + Lease Rate: \$7.25/sf NNN

## Industrial Space

736 Addison Road | Painted Post, NY 14870

# For Sale or Lease

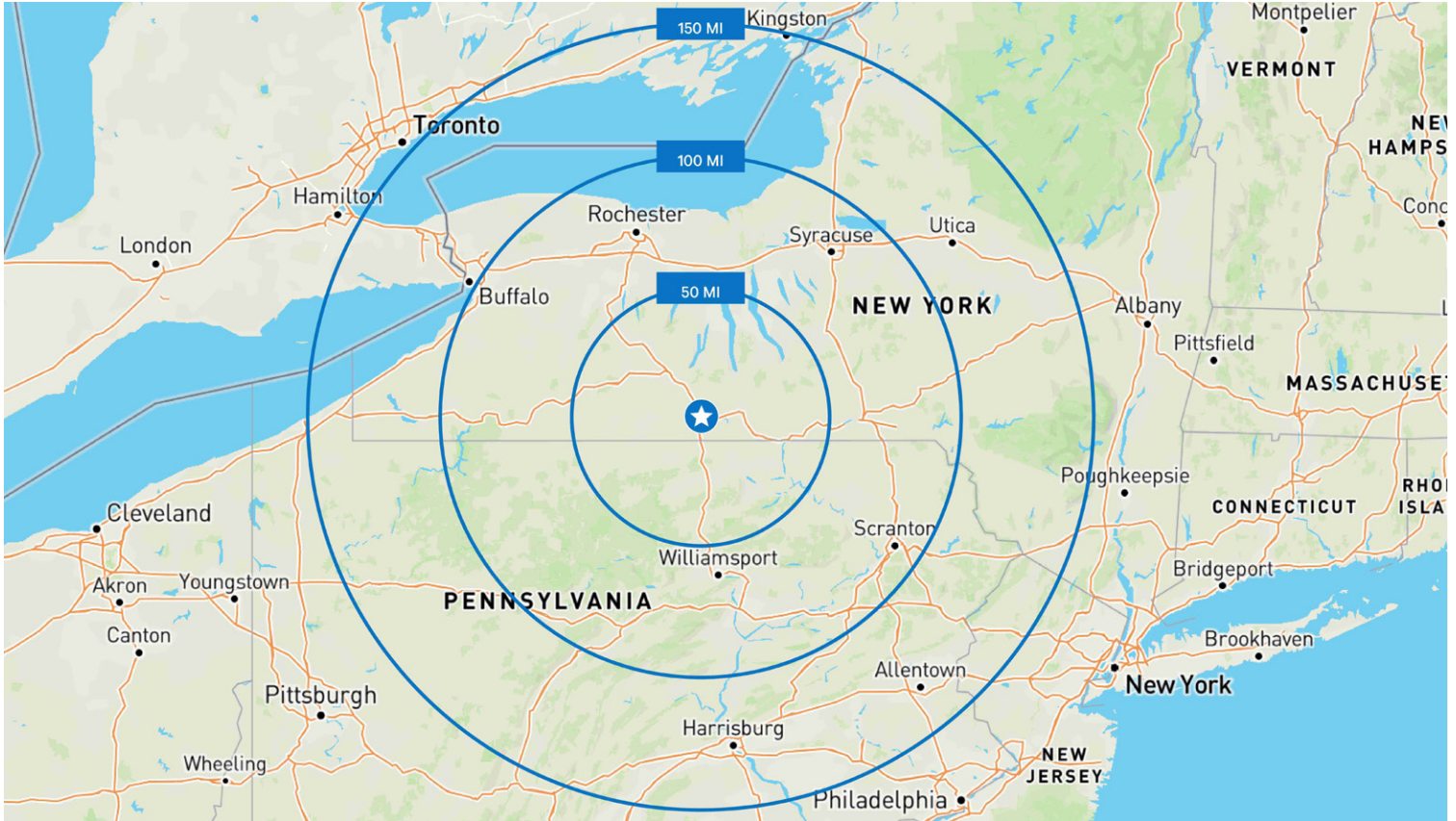

# Property Details

- + 408,000± SF Total, With 3,200± SF Office, Expandable by 195,000± SF
- + 65 Acre Site
- + 27 Dock Height Doors with Dock Bumpers, Shelters and Levelers
- + 4 Drive-In Doors
- + 300 KVA
- + 39'-45' Clear Height
- + 50' x 50' Column Spacing
- + T-5 and LED Lighting
- + Sprinklers Throughout
- + 64 Parking Spaces
- + Zoned I-2 Industrial
- + Built in 2006
- + Adjacent to I-99, Multiple Exits Located Minutes From Building

## Contact Us

### Patrick Wahl

+1 585 784 3633

patrick.wahl@cbre-rochester.com

Licensed Real Estate Salesperson

### Harry Gleason, SIOR

+1 585 784 3639

harry.gleason@cbre-rochester.com

Licensed Associate Real Estate Broker

© 2026 CBRE Upstate NY, part of the CBRE Affiliate Network. All rights reserved. This information has been obtained from sources believed reliable, but has not been verified for accuracy or completeness. You should conduct a careful, independent investigation of the property and verify all information. Any reliance on this information is solely at your own risk. CBRE Upstate NY and the CBRE Upstate NY logo are service marks of CBRE Upstate NY. All other marks displayed on this document are the property of their respective owners, and the use of such logos does not imply any affiliation with or endorsement of CBRE Upstate NY. Photos herein are the property of their respective owners. Use of these images without the express written consent of the owner is prohibited.

### CBRE Upstate NY

1350 University Ave, Ste 100

Rochester, NY 14607

+1 585 240 8080

www.cbre.com/rochester

# CBRE Upstate NY

PART OF THE AFFILIATE NETWORK

# Industrial Space

736 Addison Road | Painted Post, NY 14870

# For Sale or Lease

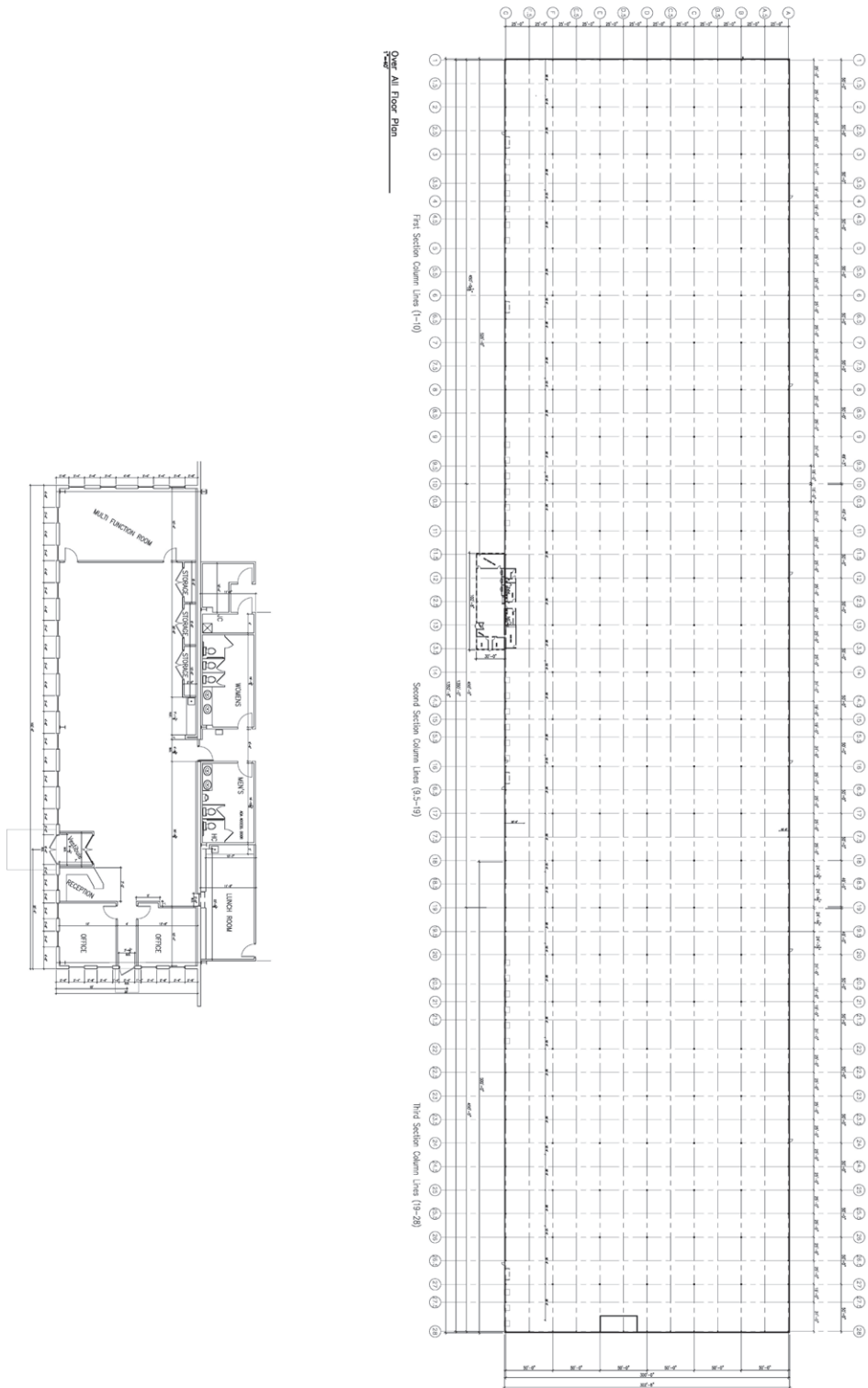

## Contact Us

**Patrick Wahl**  
+1 585 784 3633  
patrick.wahl@cbre-rochester.com  
Licensed Real Estate Salesperson

**Harry Gleason, SIOR**  
+1 585 784 3639  
harry.gleason@cbre-rochester.com  
Licensed Associate Real Estate Broker

**CBRE Upstate NY**  
PART OF THE AFFILIATE NETWORK

