

# SUITE 110

1700 PERIMETER PARK DRIVE | MORRISVILLE, NC 27560

conceptual suite layout

# 1700 PERIMETER



**SUITE 110**  
8,670 RSF

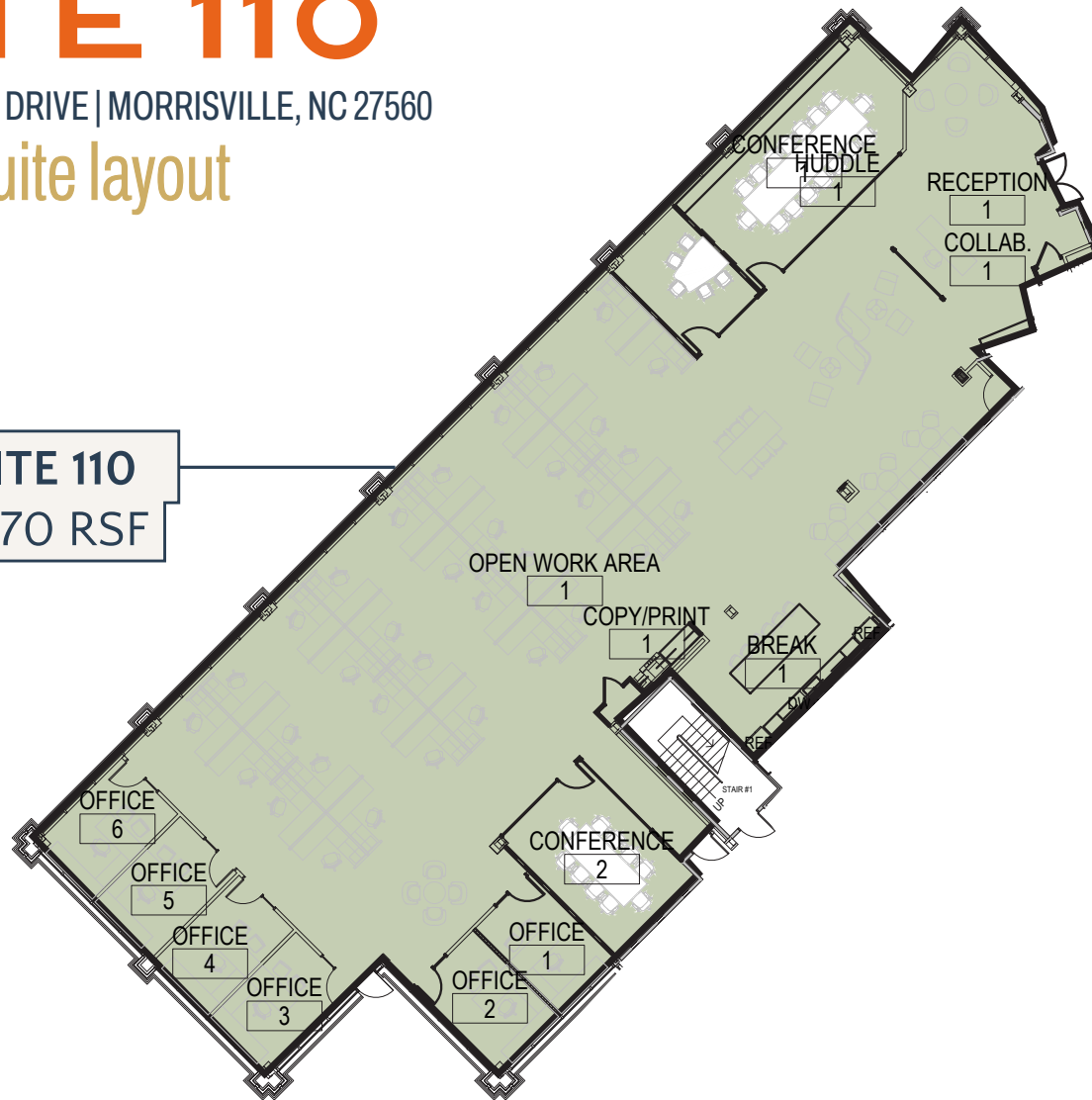

## LEASING CONTACTS

**William Allen**

Managing Partner

919.415.4390 | wallen@trinity-partners.com

**Alex Dunn**

Director, Office Leasing

919.415.4405 | adunn@trinity-partners.com