



THE PARK AT SAN TAN

3075 W RAY ROAD, CHANDLER, AZ

Suite 300 | 44,985 SF - Divisible

CLICK FOR
INTERACTIVE TOUR



Matterport

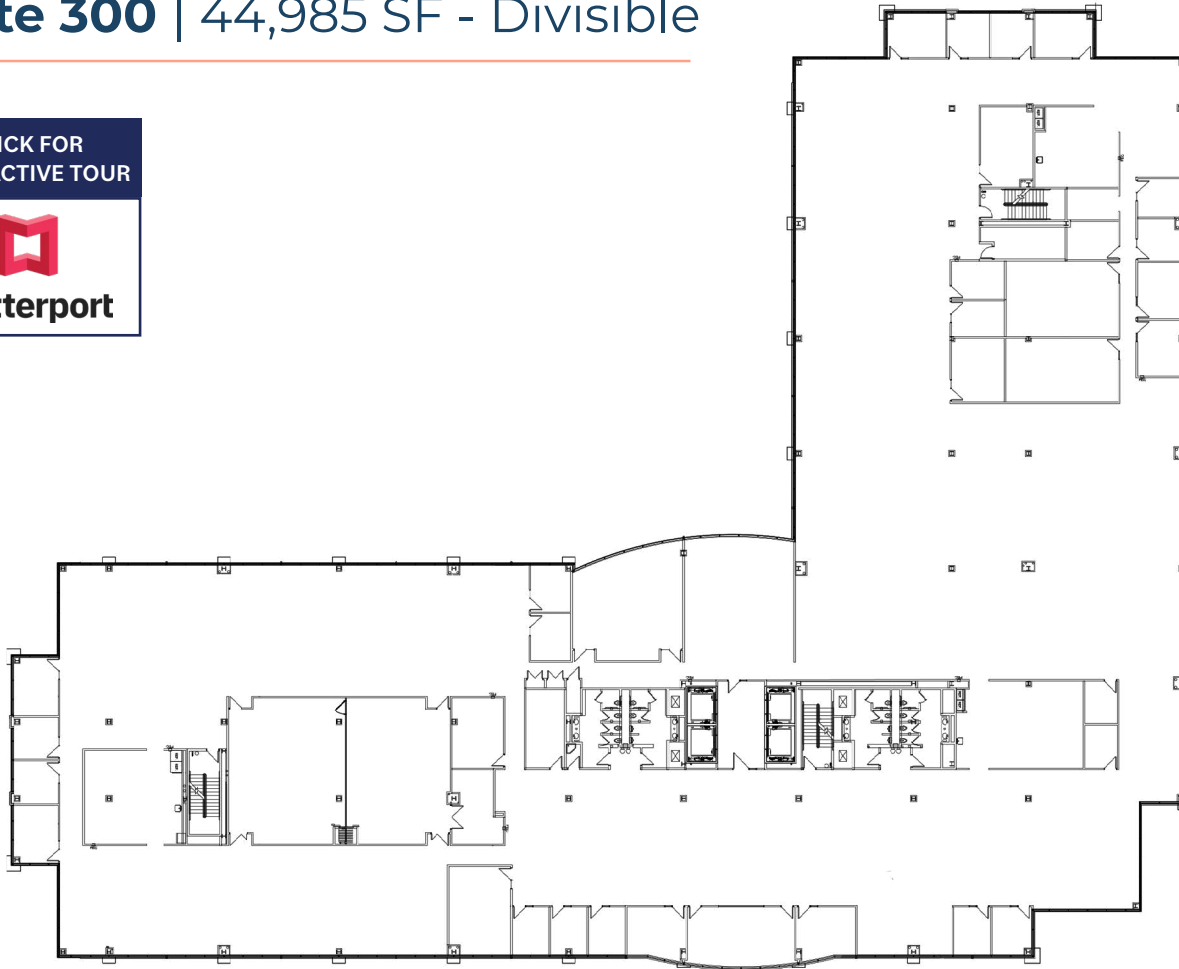

- 1** Large Training Room w/ Demisable Partition
- 3** Kitchen/Break Rooms
- 2** Wellness Rooms
- 6** Office/Focus Rooms
- 2** 12-Person Conference Rooms
- 2** 18-Person Conference Rooms
- 1** 10-Person Conference Room
- 16** Huddle Rooms

NEWMARK



HARRISON STREET
ASSET MANAGEMENT

EXCLUSIVE ADVISORS

MIKE GARLICK

t 602-952-3825

mike.garlick@nmrk.com

PAT DEVINE

t 602-952-3859

patrick.devine@nmrk.com