

31207 KEATS WAY Evergreen, Colorado 80439



PROPERTY FEATURES

- Modern Office Space
- Great North Evergreen Location
- Lewis Ridge Rd and Evergreen Parkway
- On a Hillside with Views
- Local Ownership
- Plenty of Parking

PROPERTY SPECIFICATIONS

Available:	Suite 102	808 RSF
	Suite 103	939 RSF
	Suite 102/103	1,747 RSF
Lease Rate:		\$18.50/RSF Gross
Stories:		Two
Year Built:		2003

FOR MORE INFORMATION CONTACT:

RENÉE SPICER

rspicer@gcgcre.com | 720.476.5226

JAMIE MACBETH

jmacbeth@gcgcre.com | 720.476.5229

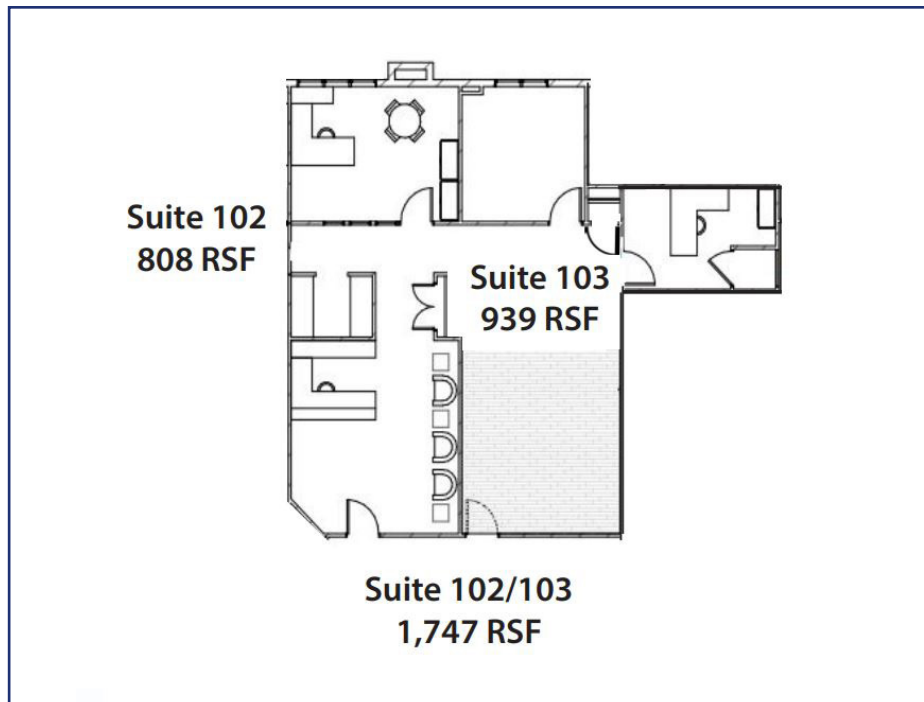

FOR MORE INFORMATION CONTACT:

RENÉE SPICER
rspicer@gcgcre.com 720.476.5226

JAMIE MACBETH
jmacbeth@gcgcre.com 720.476.5229