

FOR LEASE

7192 Kalaniana'ole Highway • Honolulu, HI 96825



KOKO MARINA CENTER

make life fun!



PROPERTY DESCRIPTION

East O'ahu's premier shopping center offering a vibrant mix of retail and service tenants. With exposure to more than 2 million visitors annually, the center is ideally positioned to serve both the local community and visitor markets, and just minutes from Hanauma Bay. Set against a relaxing marina backdrop, Koko Marina offers convenient access directly off Kalaniana'ole Highway and features a full range of medical, dining, and everyday services.

PROPERTY SNAPSHOT

Location:	Hawaii Kai
Land Area:	~16.748 AC
Gross Leasable Area:	~277,420 SF
Zoning:	B-2 Community Business
Base Rent:	Office & Retail Negotiable Ground lease applies the following January
Percentage Rent:	8% over natural breakpoint
CAM:	\$0.90 / SF
Real Property Taxes:	\$0.32 / SF
Promotional Fee:	\$0.16 / SF
Parking:	Ample parking available

PROPERTY FEATURES

- Great frontage along main highway
- Retail and entertainment center
- Excellent visibility
- Limited competition

TRAFFIC COUNTS

Kalaniana'ole Highway/Portlock Rd: 34,601 VPD

DEMOGRAPHICS

Source: CoStar^{web}

	<u>1 Mile</u>	<u>3 Mile</u>
Population:	12,186	38,010
Total Households:	4,431	13,336
Avg. Household Income:	\$159,520	\$155,368

FOR MORE INFORMATION

Nora Bland (S)
Senior Vice President
RS-65997
Investment Sales & Leasing
Sofos Realty Corporation
Phone: (808) 522-5967 Fax: (808) 522-5969
E-mail: nbland@sofosrealty.com

600 KAPIOLANI BOULEVARD, SUITE 200 • HONOLULU, HAWAII 96813 • (808) 522-5999 • WWW.SOFOSREALTY.COM

©2026 Sofos Realty Corporation. All information contained herein is obtained from sources deemed reliable. However, no representations or guarantees are made as to the accuracy thereof, and it is provided herein subject to errors, omissions, changes and withdrawals without notice. Offeror and/or his agent should confirm this information prior to making any offer. Buyer agrees that all negotiation shall be conducted through Sofos Realty Corporation only. No subagency is offered or intended.

 **SOFOS REALTY**
CORPORATION
Commercial Brokerage • Property Management

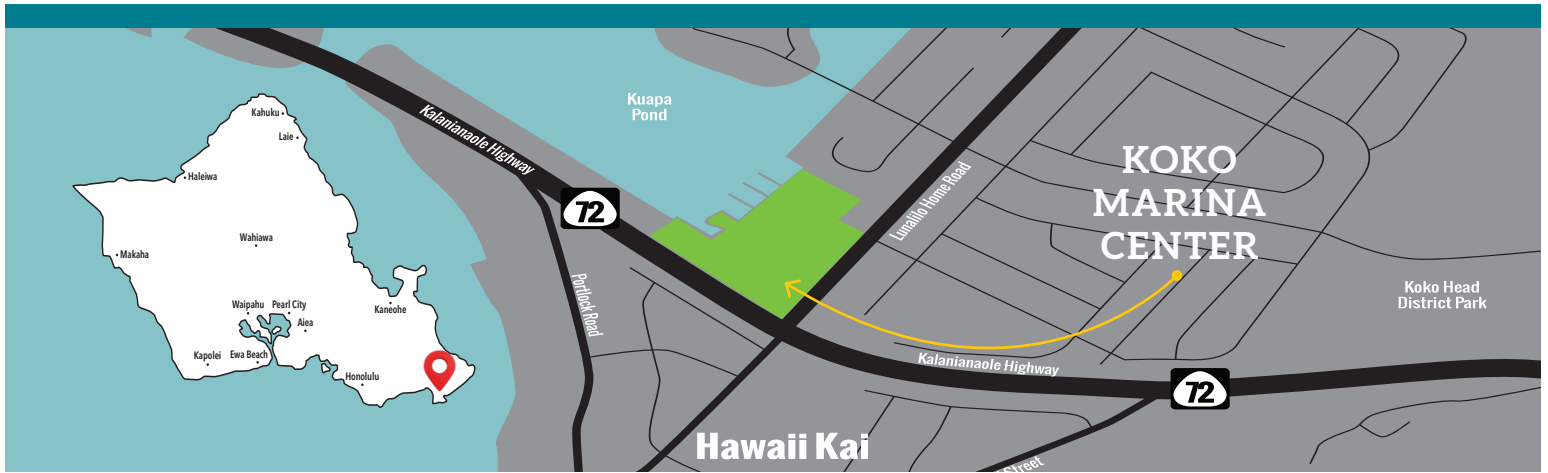

SITE PLAN with AVAILABLE SPACE



KOKO MARINA CENTER
make life fun!

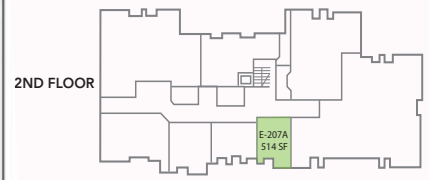
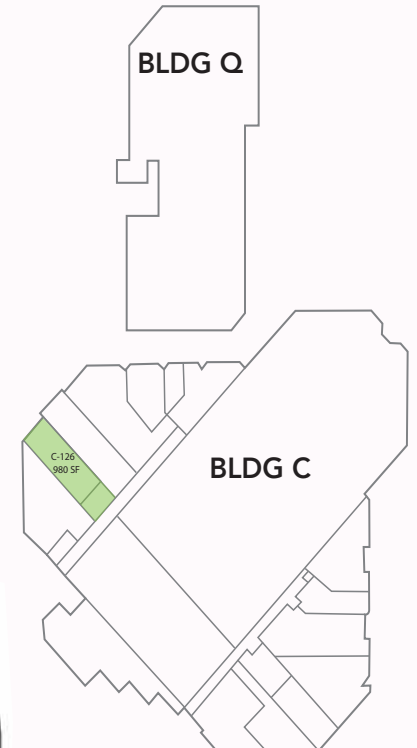
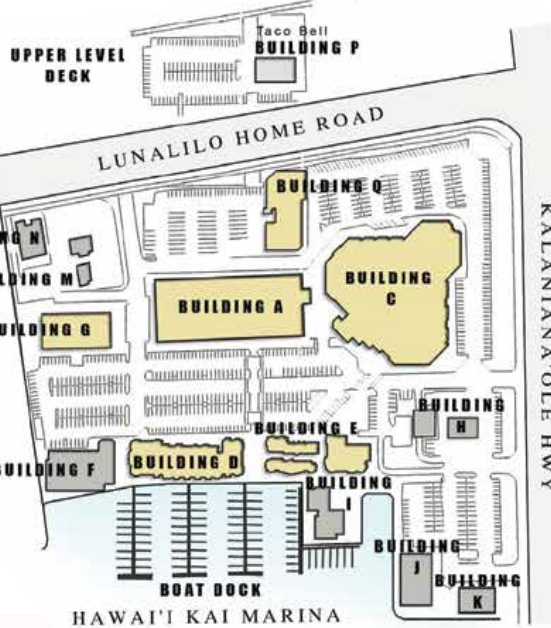
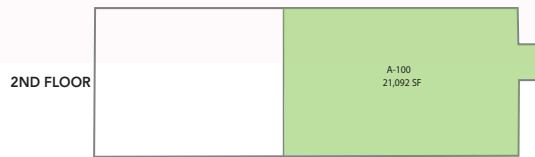
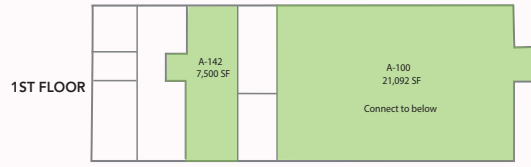
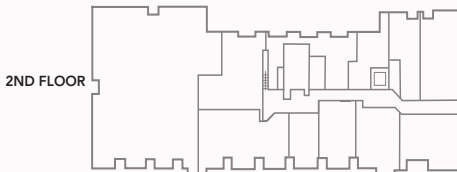
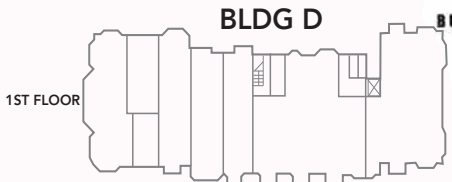
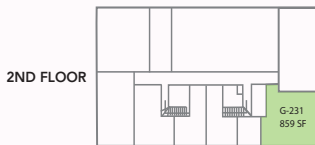
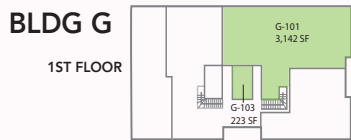
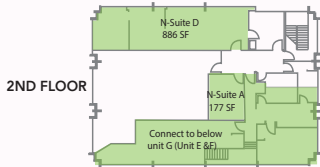
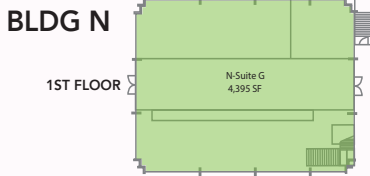

*Site & Floor Plans are for marketing purposes only and may not accurately reflect the property.