



FOR LEASE

±10,510 SF
INDUSTRIAL/ FLEX BUILDING

2550 W 237TH STREET | TORRANCE | CA



PROPERTY FEATURES

- ± 10,510 SF Industrial/Flex Building
- ± 4,000 SF High End Office Space
- High End Office Furniture, Racking, and Forklift Available Separately for Purchase
- Three Restrooms
- Large Breakroom
- 19' Minimum Warehouse Clearance
- Fire Sprinklers
- 1 Oversized GL Door (16' Wide x 14' High)
- Large Fenced Yard
- Prime Torrance Airport Location
- Professionally Managed Property
- Available for Occupancy August 1, 2026
- Nearby Access to , , and  Freeways



Exclusively Offered By:



LOREN CARGILE
Vice President | Partner
License #01431329
(949) 307-2245
LCargile@voitco.com

2020 Main Street, Suite 100
Irvine, CA 92614
License #01991785
www.voidco.com

INTERIOR PHOTOS



Exclusively Offered By:



2020 Main Street, Suite 100 | Irvine, CA 92614
License #01991785 www.voitco.com



LOREN CARGILE
Vice President | Partner
License #01431329

(949) 307-2245
LCargile@voitco.com

SITE PLAN

W 237th ST

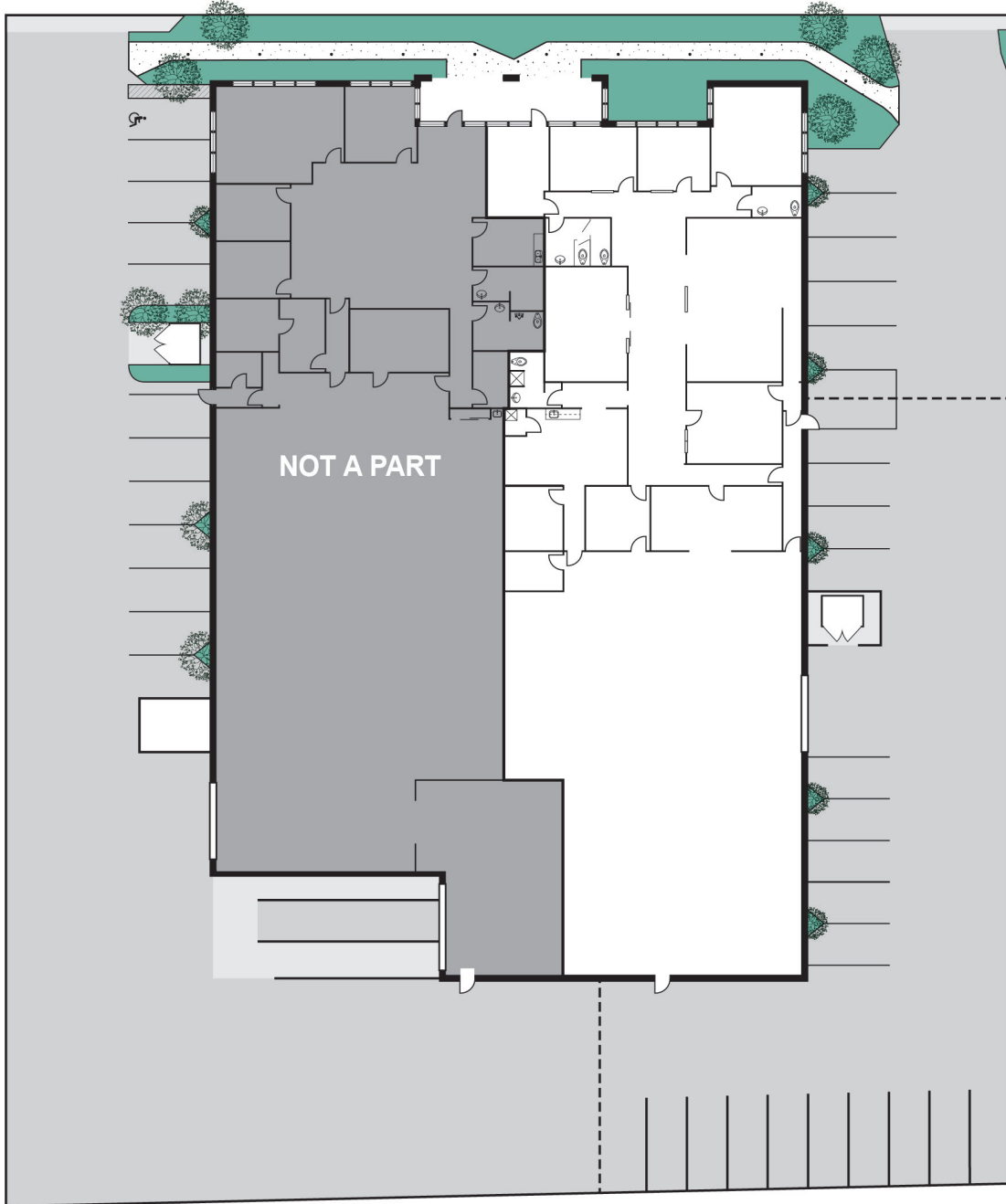

Exclusively Offered By:

Voit

REAL ESTATE SERVICES

2020 Main Street, Suite 100 | Irvine, CA 92614
License #01991785 www.voitco.com



LOREN CARGILE
Vice President | Partner
License #01431329

(949) 307-2245
LCargile@voitco.com

AERIALS



Exclusively Offered By:

Voit

REAL ESTATE SERVICES

2020 Main Street, Suite 100 | Irvine, CA 92614
License #01991785 www.voidco.com



LOREN CARGILE
Vice President | Partner
License #01431329

(949) 307-2245
LCargile@voitco.com