

For Sublease Corporate Ridge II

18001 W 106th Street
Olathe, KS 66061
www.cbre.us/kansascity

11,265± RSF Available

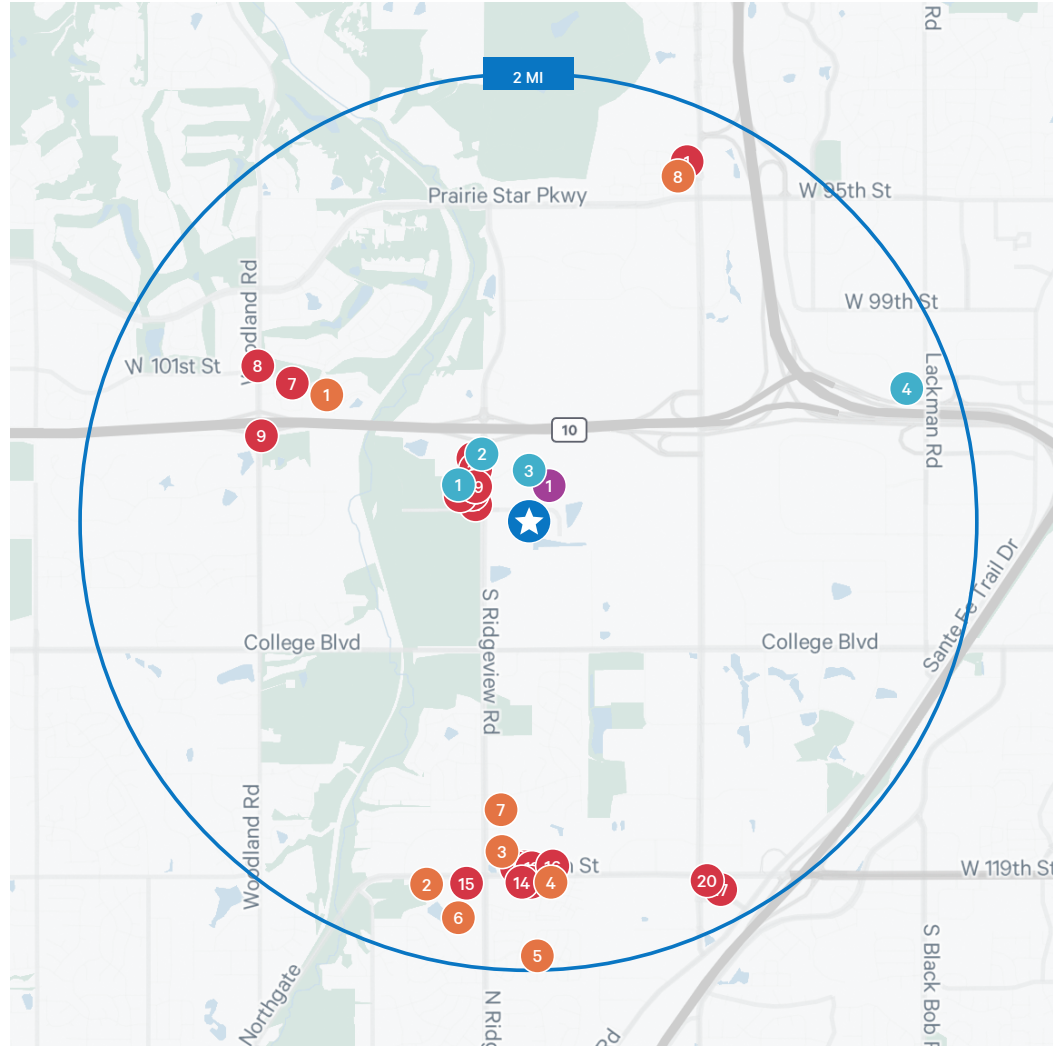



Amenities within
2 Miles of
18001 W 106th Street

20+
Restaurants

1
Fitness Center

2,127
Apartment Units
Existing & Under Construction

496
Hotel Rooms

Subject Property
18001 W 106th Street

Restaurants

- 1. Shack Breakfast & Lunch
- 2. Burger King
- 3. Taco Bell
- 4. Scooter's Coffee & Yogurt
- 5. Minsky's Pizza
- 6. Goodcents Deli Fresh Subs
- 7. Scooter's Coffee & Yogurt
- 8. El Toro Loco
- 9. Wendy's
- 10. Chipotle Mexican Grill
- 11. Arby's
- 12. Dairy Queen
- 13. McDonald's
- 14. Dunkin' Donuts
- 15. Sonic
- 16. Black Rifle Coffee Company
- 17. Jason's Deli
- 18. Salty Iguana
- 19. The Rub Bar-B-Que
- 20. LongHorn Steakhouse

Fitness Center

- 1. Genesis Health Club

Apartments

- 1. Aventura Falcon Valley Apartments
- 2. Legacy Senior Apartments
- 3. Villas at Ridgeview Falls
- 4. The Lennox of Olathe
- 5. Santa Barbara Estates
- 6. Millcreek Woods Apartments
- 7. Aspen Ridge
- 8. Prairie Creek I

Hotels

- 1. Four Points by Sheraton
- 2. Holiday Inn Express
- 3. Embassy Suites
- 4. Studio 6

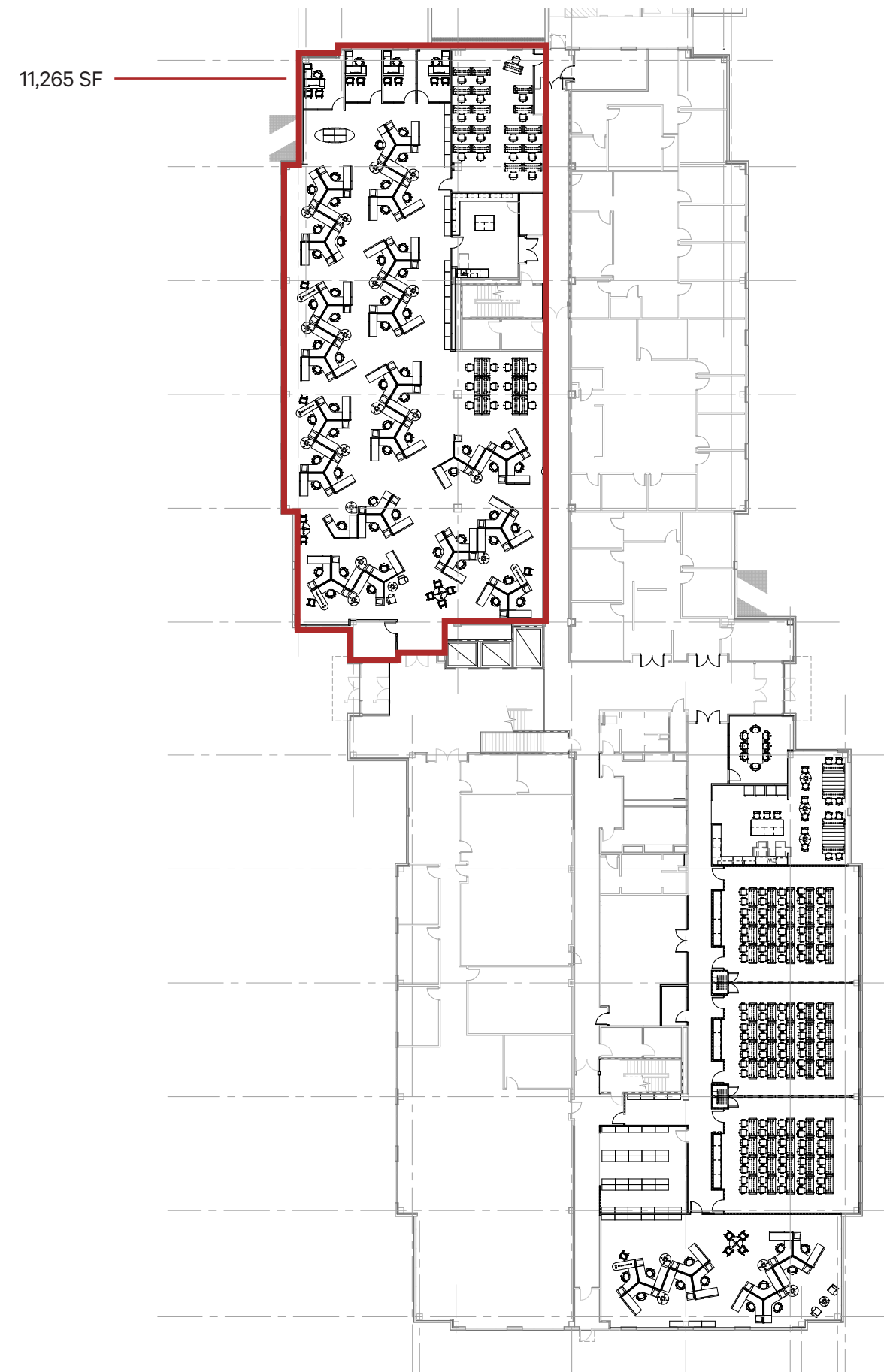

1 LEVEL 1 FURNISHING PLAN

Property Highlights

- + 11,265± RSF
- + Primary lease expiration November 30, 2030
- + \$18.00/RSF Full Service Gross
- + No operating expense pass-through
- + Furniture Available



Contact Us

Bob Fagan, CCIM
Senior Vice President
+1 816 968 5821
bob.fagan@cbre.com

Matt Eckert
Senior Vice President
+1 816 968 5837
matt.eckert@cbre.com

© 2026 CBRE, Inc. All rights reserved. This information has been obtained from sources believed reliable, but has not been verified for accuracy or completeness. You should conduct a careful, independent investigation of the property and verify all information. Any reliance on this information is solely at your own risk. CBRE and the CBRE logo are service marks of CBRE, Inc. All other marks displayed on this document are the property of their respective owners, and the use of such logos does not imply any affiliation with or endorsement of CBRE. Photos herein are the property of their respective owners. Use of these images without the express written consent of the owner is prohibited.