



FOR LEASE

PROFESSIONAL OFFICE SPACE IN MANDAN

2500 SUNSET DRIVE | MANDAN, ND



SPACE AVAILABLE:
SECOND FLOOR | 4,441—10,258 SF

PRICE:
\$15.50 PSF FULL SERVICE

HIGHLIGHTS:

- Highly visible office space just off I-94 Exit 152!
- 5817 SF & 4441 SF Available
- 2nd Floor Spaces w/ Elevator Access
- Open Floorplan Vanilla Shell
- Abundance of Natural Light
- Access to Common Conference Room by Reservation
- Common Area Restrooms

STEVEN ILSE

Business Brokerage Director
Partner | Commercial REALTOR®

701.223.2450

steve@aspengrouprealestate.com

in



424 South 3rd Street, Suite 2
Bismarck, ND 58504

701.223.2450

www.aspengrouprealestate.com

f @ in

This information has been secured from sources we believe to be reliable, but we make no representation or warranties, expressed or implied, as to the accuracy of the information. All references to age, square footage, income and expenses are approximate. Buyers or lessors should conduct their own independent investigations and rely only on those results.



AMAZING 2ND STORY VIEWS





COMMON AREAS





|SECOND FLOOR

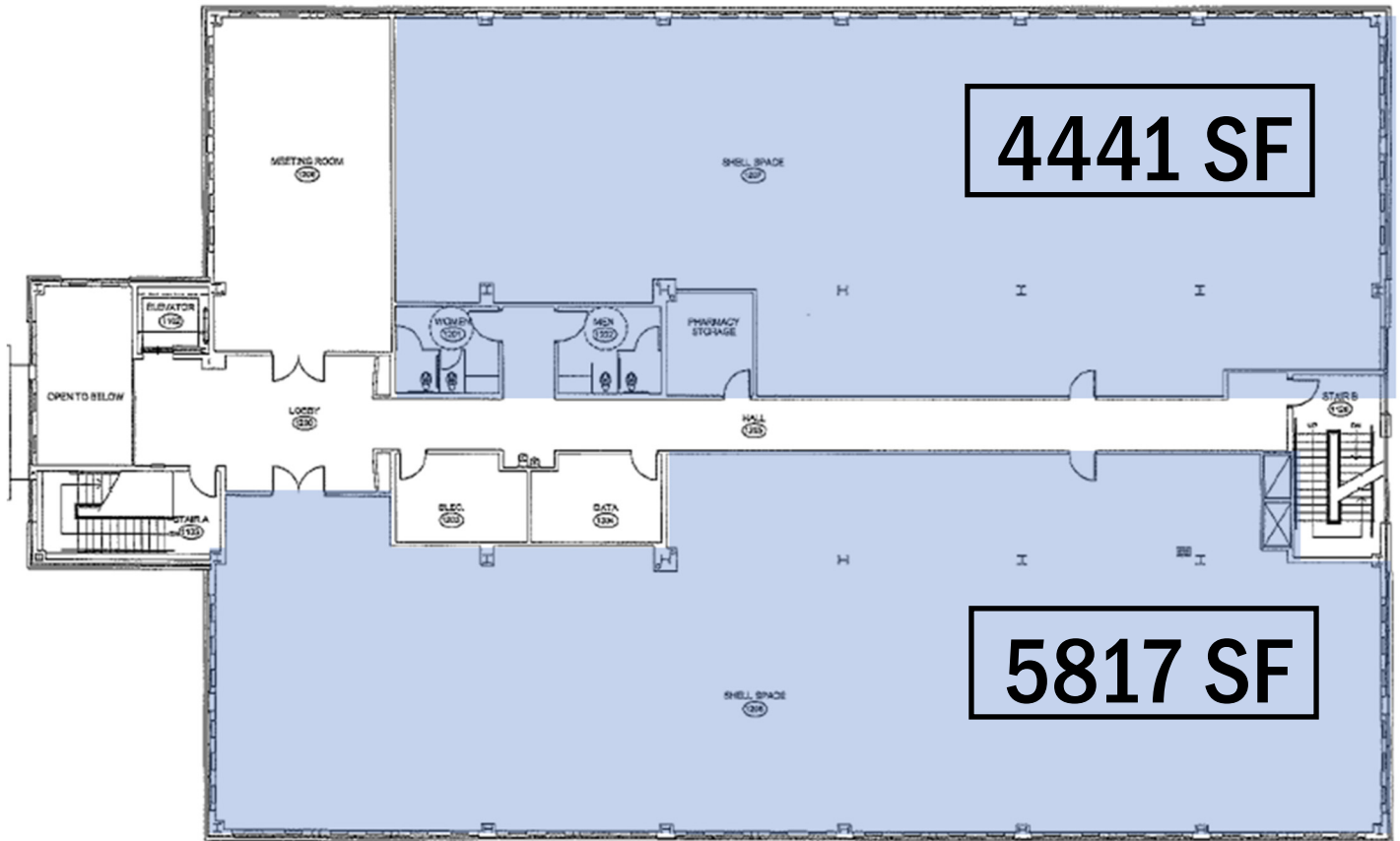

STEVEN ILSE

Business Brokerage Director | Partner | Commercial REALTOR®

701.223.2450

STEVE@ASPENGROUPREALESTATE.COM

| IN THE AREA

DINING | HOSPITALITY



SHOPPING | RETAIL



OFFICE | BANKING | MEDICAL



COMMUNITY | RECREATION



LOCATION MAP

