

# AVAILABLE FOR LEASE

1555-1565 LA MIRADA DRIVE  
SAN MARCOS, CALIFORNIA | 92078



±2,700 - 27,564  
SQUARE FEET AVAILABLE



MULTI-TENANT INDUSTRIAL  
WITH FENCED YARD



---

**SPACE AVAILABLE**

**27,564 SF**

---

**BUILDING DESCRIPTION**

**Single Tenant or Multi-Tenant Options Available**

---

**YARD AREA**

**Approximately 25,000 SF**

---

**CONSTRUCTION**

**Concrete Block and Metal**

---

**CLEAR HEIGHT**

**14' - 20'**

---

---

**GRADE LEVEL DOORS**

**8**

---

**SPRINKLERS**

**Yes**

---

**ELECTRIC**

**Approximately 1,075 Amps  
3-Phase Heavy Power**

---

**ZONING**

**I-Industrial**

---

**RATE**

**Negotiable (est. NNN = \$0.37/SF)**

---

# ASSET FEATURES

# SITE PLAN



## OPTION A: SINGLE-TENANT OPTION

SUITE A/B/F/H	27,564 SF
---------------	-----------

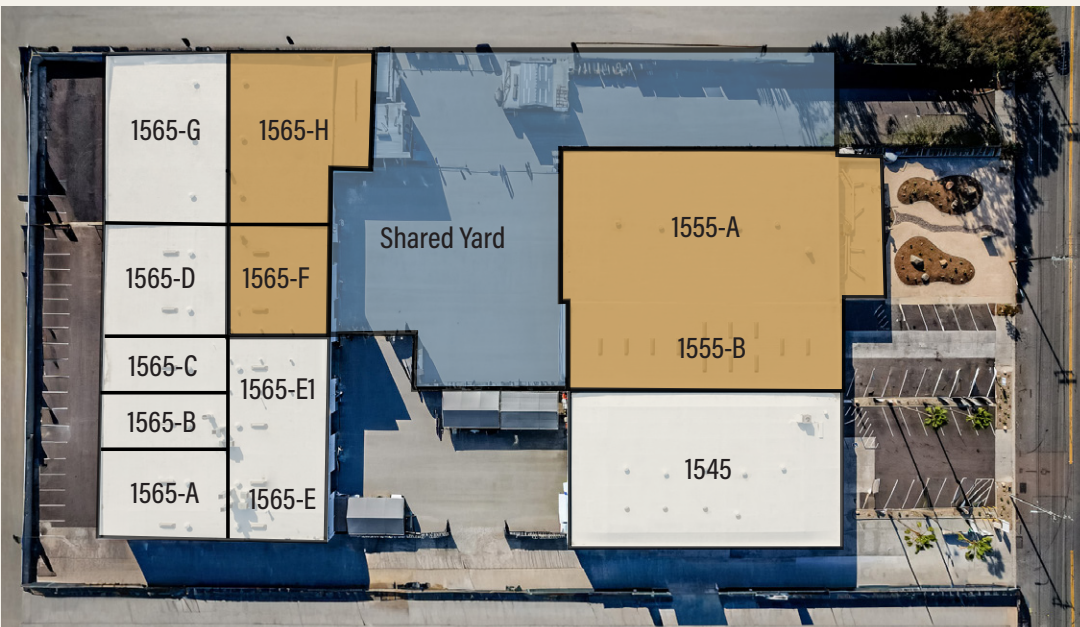

## OPTION B: MULTI-TENANT OPTION

SUITE A/B	19,464 SF
SUITE F	2,700 SF
SUITE H	5,400 SF

# 1555-1565 LA MIRADA DR

## SAN MARCOS, CA 92078

SUITE A/B/F/H

27,564 SF

8 GL ROLL-UP  
DOORS

1,075 AMPS, 3-PHASE POWER

# AVAILABILITY

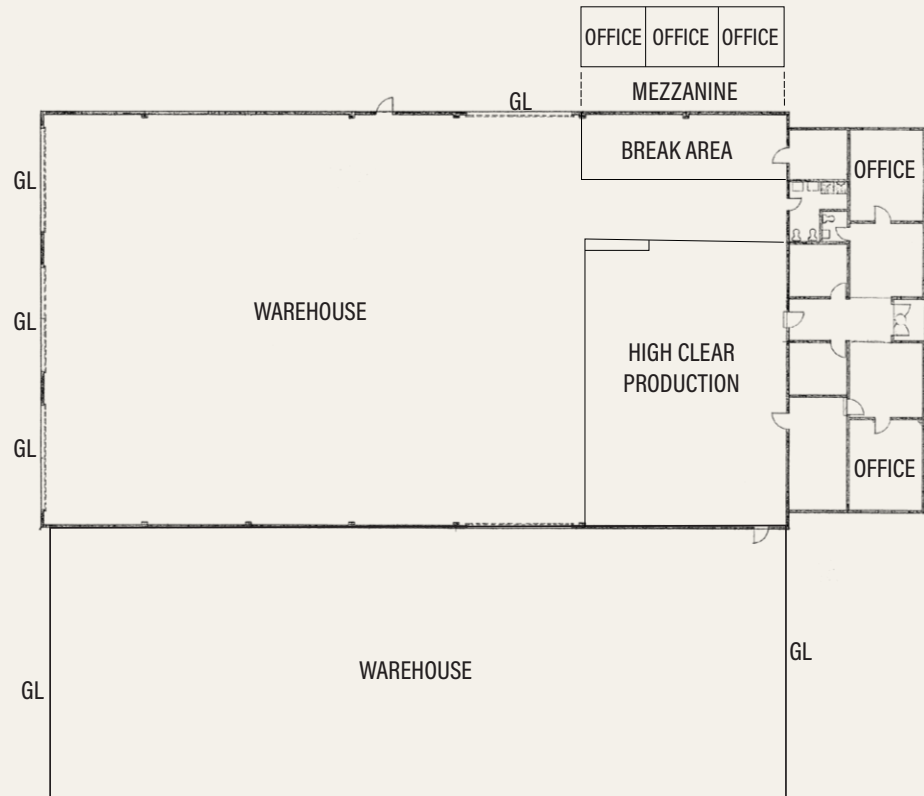
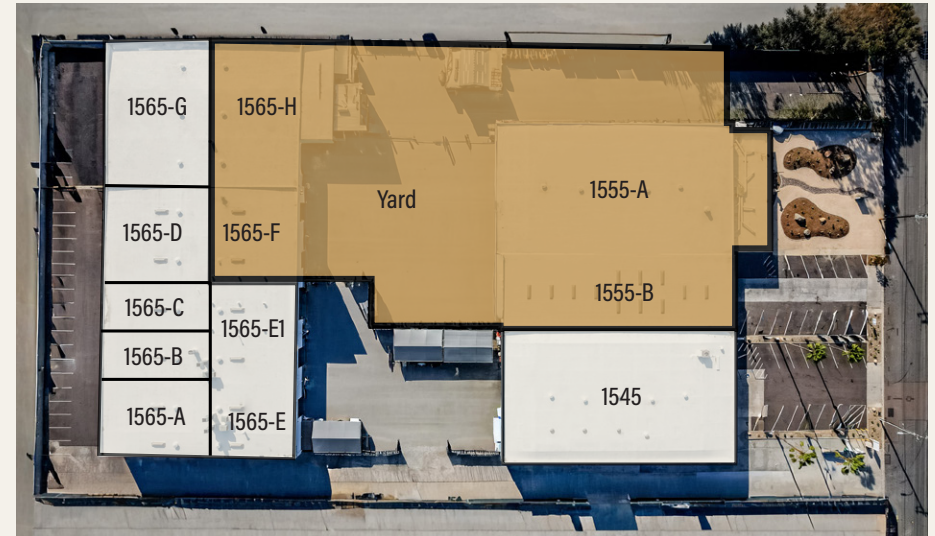

# OPTION A

# 1555 LA MIRADA DR SAN MARCOS, CA 92078

SUITE A/B

19,464 SF

6 GL ROLL-UP  
DOORS

800 AMPS, 3-PHASE POWER

# AVAILABILITY

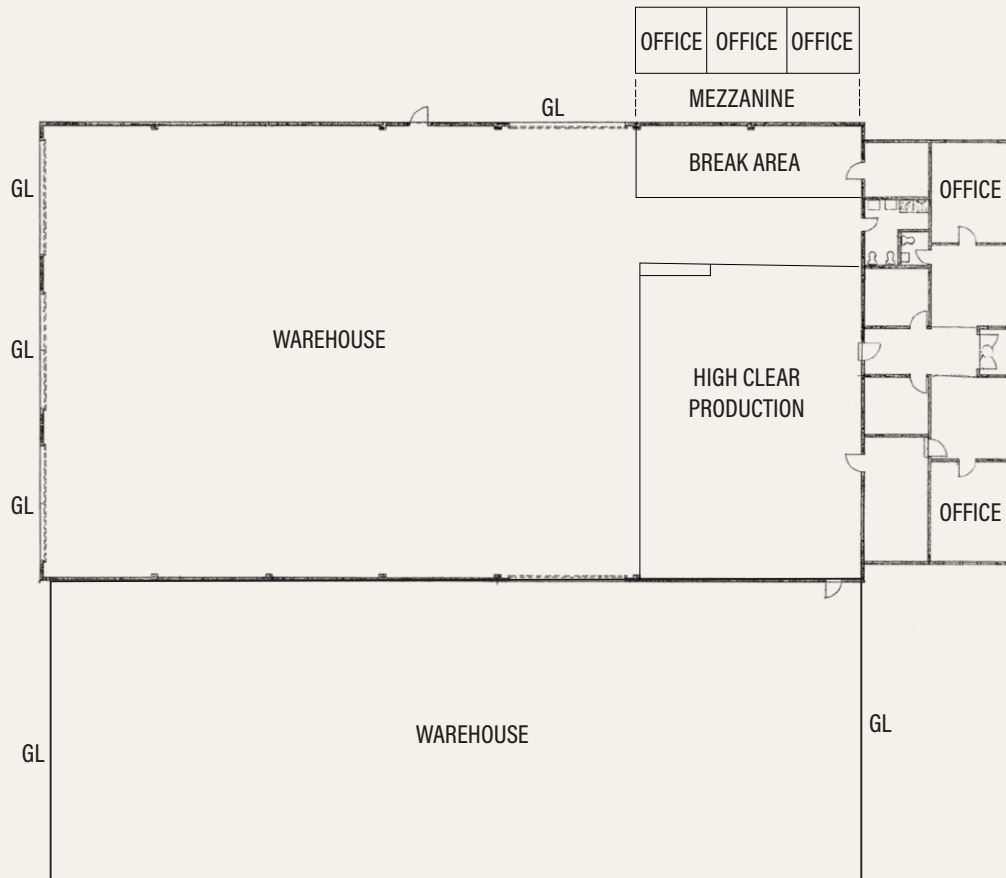
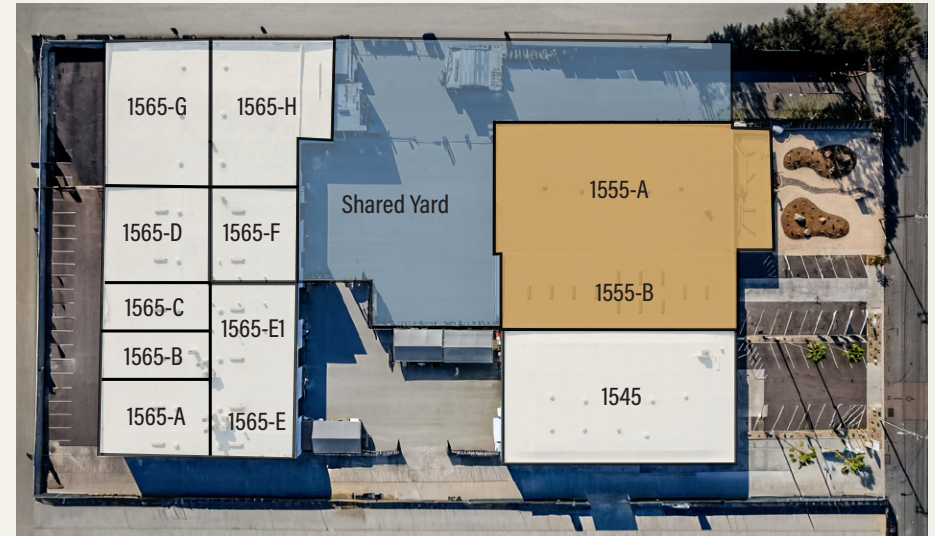

OPTION B

1565 LA MIRADA DR  
SAN MARCOS, CA 92078

SUITE F

2,700 SF

1 GL ROLL-UP  
DOOR

100 AMPS, 3 -PHASE POWER

# AVAILABILITY

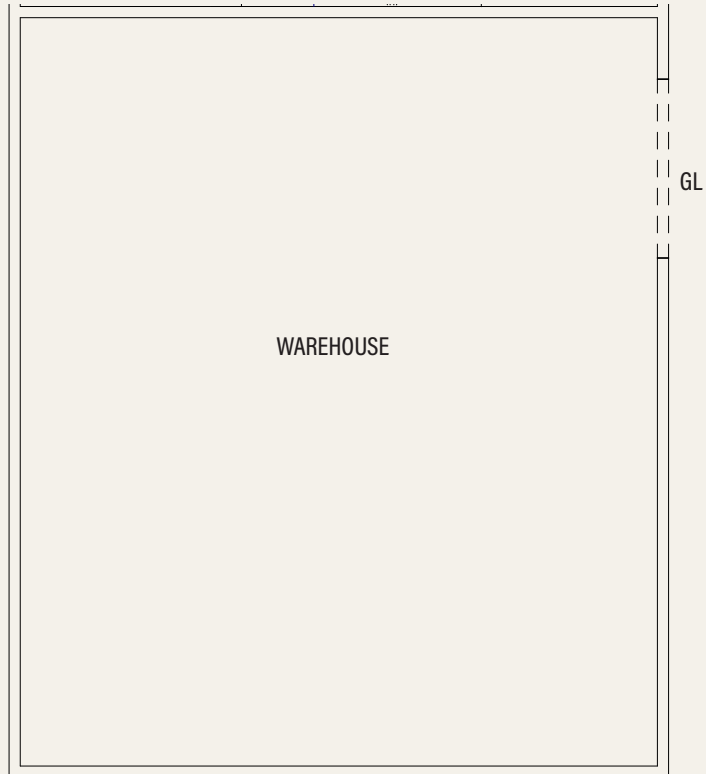
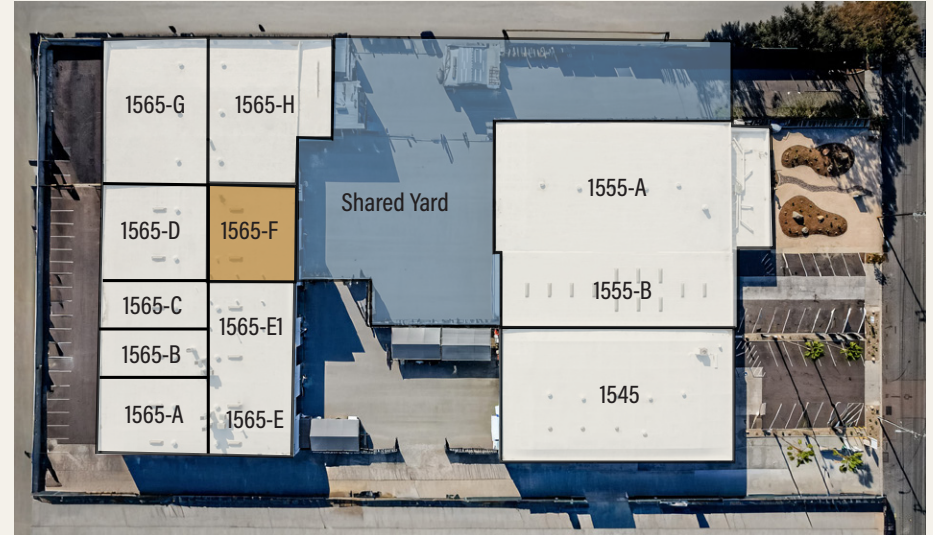

OPTION B

1565 LA MIRADA DR  
SAN MARCOS, CA 92078

SUITE H

5,400 SF

1 GL ROLL-UP  
DOOR

175 AMPS, 3-PHASE POWER

# AVAILABILITY

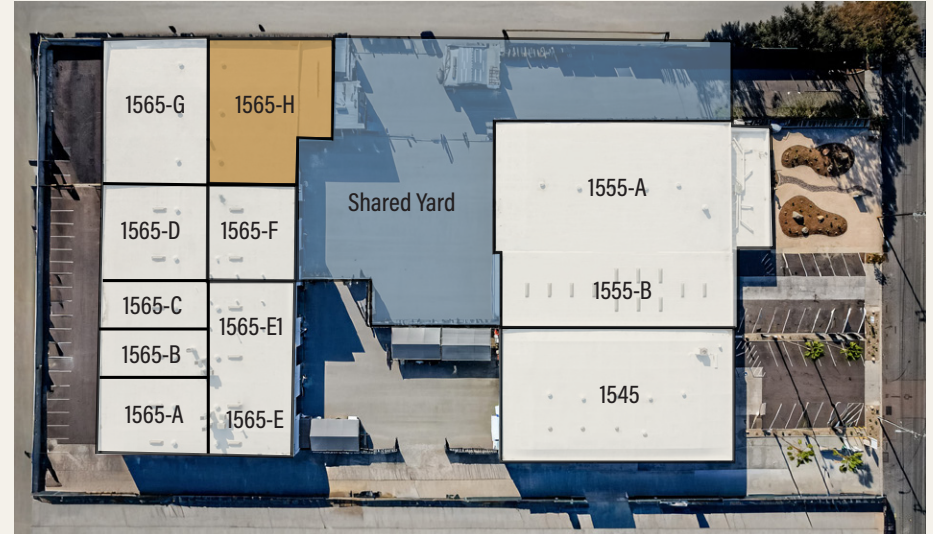

OPTION B



# AVAILABLE FOR LEASE



©Cushman & Wakefield. All rights reserved. The information contained in this communication is strictly confidential. This information has been obtained from sources believed to be reliable but has not been verified. NO WARRANTY OR REPRESENTATION, EXPRESS OR IMPLIED, IS MADE AS TO THE CONDITION OF THE PROPERTY (OR PROPERTIES) REFERENCED HEREIN OR AS TO THE ACCURACY OR COMPLETENESS OF THE INFORMATION CONTAINED HEREIN, AND SAME IS SUBMITTED SUBJECT TO ERRORS, OMISSIONS, CHANGE OF PRICE, RENTAL OR OTHER CONDITIONS, WITHDRAWAL WITHOUT NOTICE, AND TO ANY SPECIAL LISTING CONDITIONS IMPOSED BY THE PROPERTY OWNER(S). ANY PROJECTIONS, OPINIONS OR ESTIMATES ARE SUBJECT TO UNCERTAINTY AND DO NOT SIGNIFY CURRENT OR FUTURE PROPERTY PERFORMANCE.

**BRANT ABERG, SIOR**

+1 858 546 5464

[brant.berg@cushwake.com](mailto:brant.berg@cushwake.com)

CA Lic 01773573

**TYLER STEMLEY**

+1 760 431 3841

[tyler.stemley@cushwake.com](mailto:tyler.stemley@cushwake.com)

CA License 02003867