

FLOOR PLAN
1/4" = 1'-0"

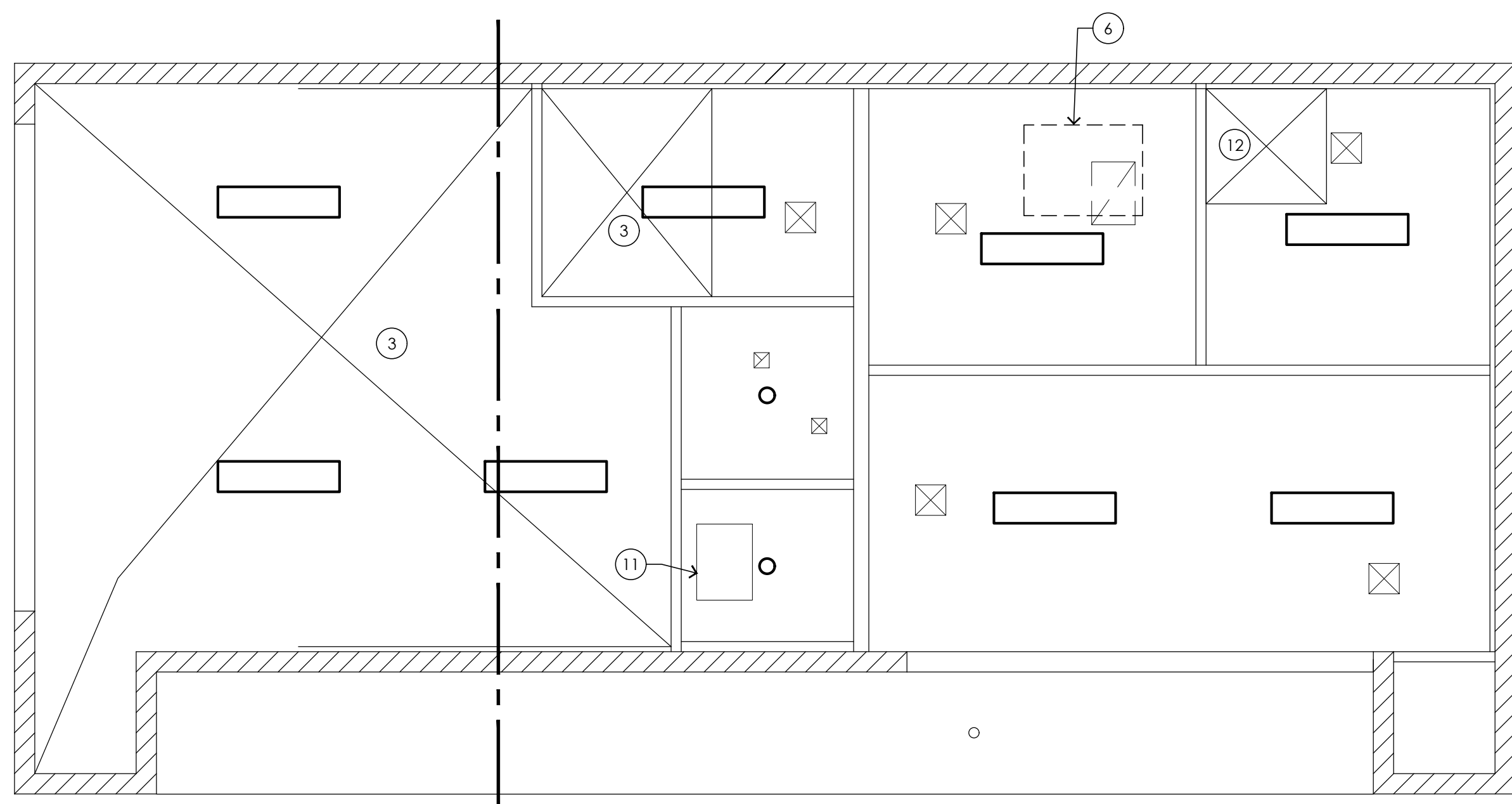

REFL. CLG. PLAN
1/4" = 1'-0"

FLOOR PLAN NOTES

1. AREA OF DAMAGE TO ROOF - SEE STRUCTURAL DRAWINGS.
2. DEMO FIRE DAMAGED WALL.
3. DEMO FIRE DAMAGED TRUSSES, ROOF DECK, CEILING - SEE STRUCT DRAWINGS. REPLACE CEILING W/ NEW 5/8" GYP BOARD.
4. DEMO FIRE DAMAGED GYP BOARD FINISH AND REPLACE.
5. EXIST. TOILET - NO WORK.
6. EXIST. A/C UNIT ON ROOF.
7. EXIST. STOREFRONT.
8. FIRE EXTINGUISHER AT 40" AFF. 10A5BC.
9. REPLACE 1'6" X 8" O.H. DOOR W/ NEW TRACK. REPLACE DAMAGED INSULATION W/ RIGID INSULATION, R=8 MIN.
10. NEW COOLING UNIT - SEE M.I.
11. NEW ATTIC SCUTTLE 22 x 30.
12. REPAIR CEILING, REPLACE ROOF AND DECK - SEE STRUCT DRAWINGS.
13. REPLACE FURRING & 5/8" GYP BOARD AS SHOWN.
14. SIGN ABOVE DOOR "THIS DOOR TO REMAIN UNLOCKED DURING BUSINESS HOURS."

FINISHES

1. ALL DAMAGED CEILINGS, WALLS AND FURRING SHALL HAVE 5/8" GYP BOARD; FINISH TO BE CHOSEN BY TENANT. PAINT.
2. ALL NEW FINISH ON WALLS IN WET AREAS SUCH AS TOILET ROOMS SHALL HAVE WATER RESISTANT 5/8" GYP BOARD TO CEILING. PAINT.
3. REPLACE FLOOR FINISHES W/ L.V.P. FLOORING (WATERPROOF). VERIFY FLOOR FINISH COLOR W/ OWNER.

WALL TYPE SCHEDULE

- EXIST 2X4 STUD WALL
- DEMO WALL
- EXIST. 8" CMU WALL FURRING PER PLAN

PROJECT	CONTRACT DATE	DRAWN BY	APPROVED
fire damage repair FOR ZAIA GROUP BUILDING	7-6-21	CD	CD

S.D.S CONSULTING
4644 N 22ND STREET, #1161
Phoenix, AZ 85016
602-405-8951

PROJECT
fire damage repair FOR ZAIA GROUP BUILDING
2226 W CAMELBACK ROAD
PHOENIX, ARIZONA

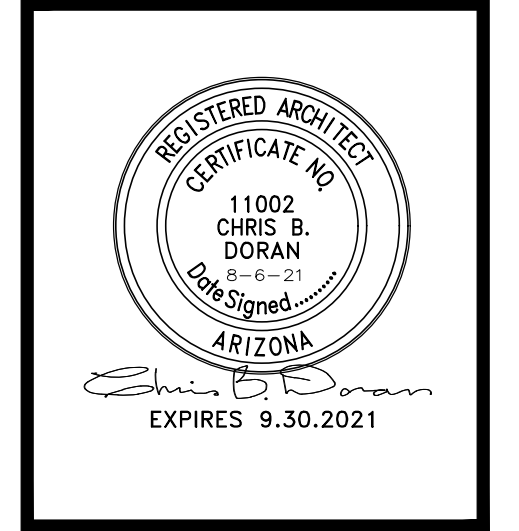

SHEET
A3