

12350 DOHERTY STREET | RIVERSIDE, CA 92503

INDUSTRIAL BUILDING FOR LEASE

Renovations Complete, Move In Ready!



LEE & ASSOCIATES
COMMERCIAL REAL ESTATE SERVICES

Lee & Associates Commercial Real Estate Services, Inc.- Riverside
Corp ID# 01048055
4193 Flat Rock Drive, Suite 100
Riverside, CA 92505

JUSTIN NULL, SIOR
VICE PRESIDENT
951.276.3634
jnull@leeriverside.com
DRE License #01899025

PROPERTY FEATURES

12350 DOHERTY STREET | RIVERSIDE, CA 92503

AVAILABLE SF:	±9,462 SF
OFFICE SF:	±1,100 SF
PROPERTY TYPE :	Industrial Building
ZONING:	M1 (Light Industrial)
GL DOORS:	3
CEILING HEIGHT :	16' (Verify)
PARKING RATIO:	2:1
POWER:	400 Amps; 120/208 Volts (Verify)
YARD:	Fenced
LIGHTING:	LED Lighting and Circulating Fans in the Warehouse
FIRE SPRINKLER SYSTEM:	Yes
AIR LINES:	Air Lines & Distribution throughout Warehouse
COMMENTS:	Spray Booth, New Roof *Spray Booth can be Removed



FLOOR PLAN

12350 DOHERTY STREET | RIVERSIDE, CA 92503

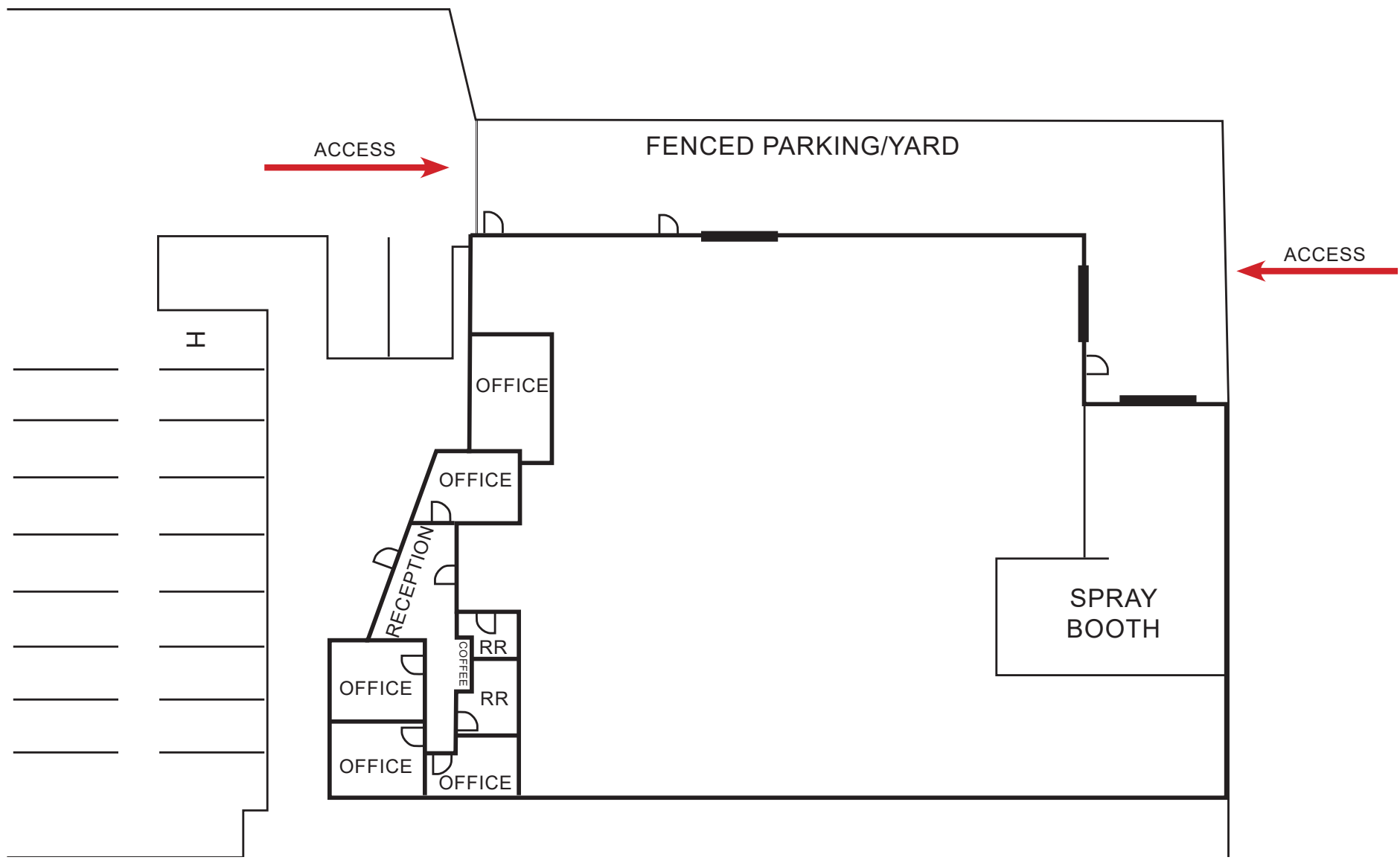

12350 DOHERTY STREET | RIVERSIDE, CA 92503



12350 DOHERTY STREET | RIVERSIDE, CA 92503



12350 DOHERTY STREET | RIVERSIDE, CA 92503

