



SYCAMORE COMMERCE CENTER

10TH + SYCAMORE

MOVE-IN READY OFFICE SPACE

400 South Sycamore Avenue, Suite 103-1 | Sioux Falls, SD 57110



SIZE

4,100 sqft



PRICE

\$9.00 PSF (NNN)
Estimated NNN: \$2.19 PSF



LOCATION

Located at the corner of East 10th Street and Sycamore Avenue.



LAYOUT

This space features six private offices, two conference rooms, a break room, and a wide open area ideal for workstations, training space, or flexible use.



TRAFFIC

20,400 VPD



FLOOR PLAN

Turnkey office space that is move-in ready.

Property is co-listed with Jim Dunham & Associates.
Information deemed reliable but not guaranteed.



TYSDAL
COMMERCIAL

7400 South Bitterroot Place
Sioux Falls, South Dakota 57108
TysdalCommercial.com



310-4509
mike@tysdalcommercial.com

PARCEL MAP



SYCAMORE AVENUE

SUITE 103-1
4,100 sqft

EAST ARROWHEAD PARKWAY



FLOOR PLAN

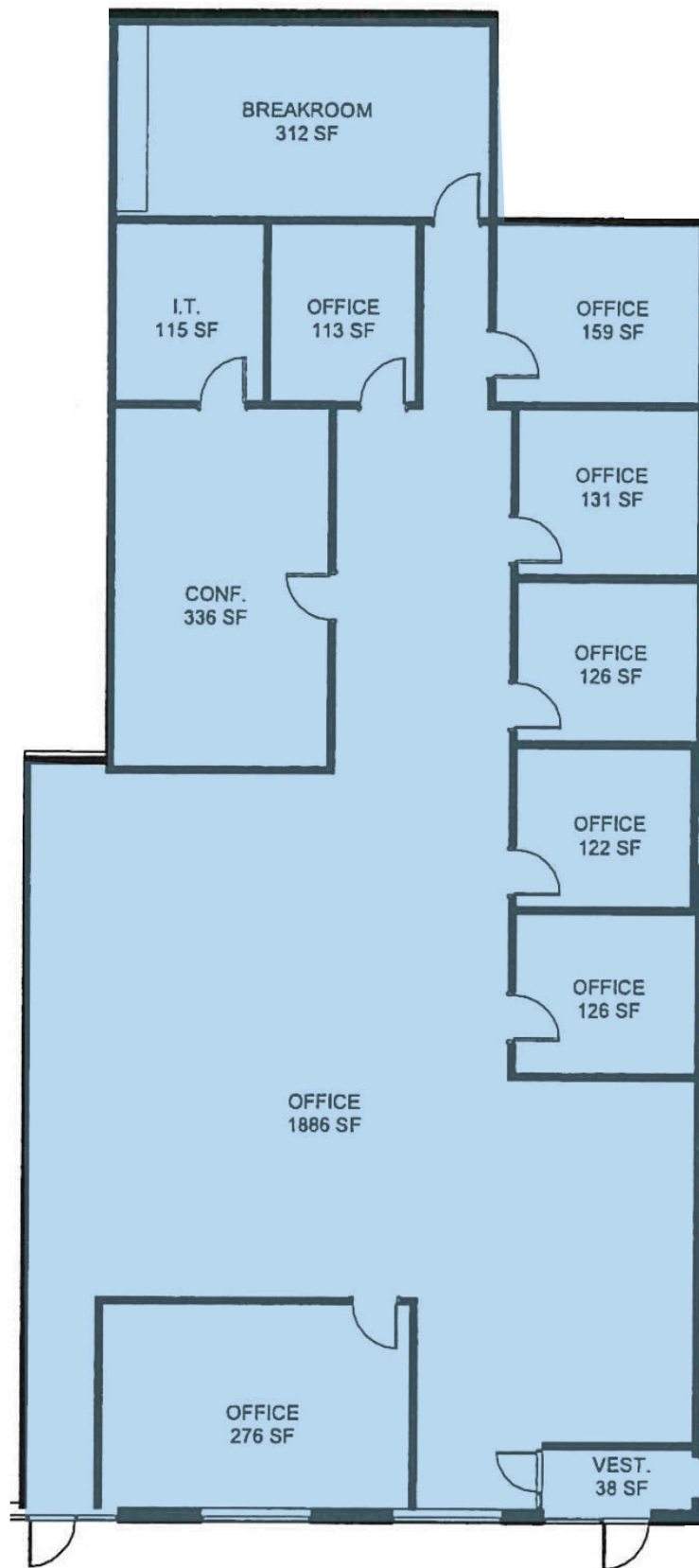

SUITE 103-1

4,100 sqft

EXTERIOR PHOTO



INTERIOR PHOTOS

