

# 500 SF Office for Lease in Chappaqua NY

1 S Greeley Ave #302, Chappaqua, NY 10514, USA

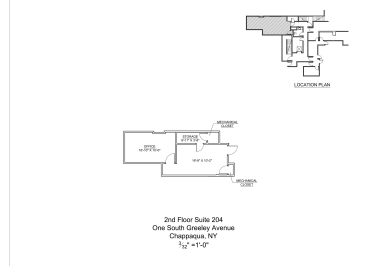
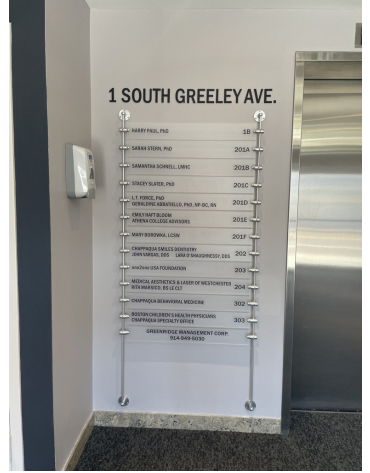

## Property Overview

Price/Rent PSF	Inquire
Asset Type	Office
Trade Type	Lease
SQ. FT. Available	500.00
Date Available	03/12/2021

## Contact



David Perlmutter  
Agent

✉ [david@perlmutterproperties.com](mailto:david@perlmutterproperties.com)

☎ +1 (914) 262-0026

🌐 [www.perlmutterproperties.com](http://www.perlmutterproperties.com)

## Description

1 South Greeley Avenue is located at the intersection with King Street in the heart of downtown Chappaqua.

The suite has two large rooms plus a large storage closet.

This is the perfect office for someone looking to escape working from home, or who does not want to commute every day into New York City.

It is directly across the street from Starbucks, and is an easy walk to the Chappaqua train station.

## Location

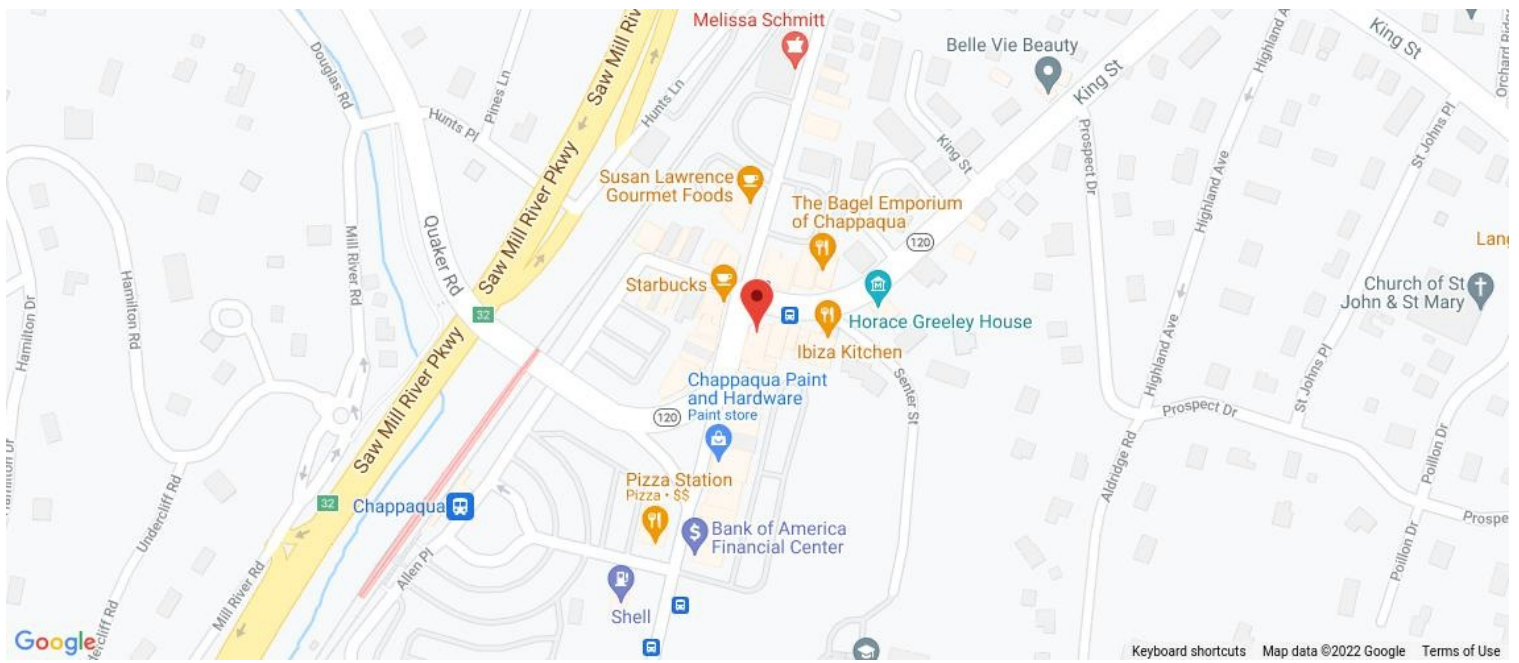

THE INFORMATION ABOVE IS FROM SOURCES WE BELIEVE TO BE RELIABLE. HOWEVER, WE HAVE NOT VERIFIED ITS ACCURACY AND MAKE NO GUARANTEE, WARRANTY OR REPRESENTATION ABOUT IT. IT IS SUBMITTED SUBJECT TO THE POSSIBILITY OF ERRORS, OMISSIONS, CHANGE OF PRICE, RENTAL OR OTHER CONDITIONS, PRIOR SALE, LEASE OR FINANCING, OR WITHDRAWAL WITHOUT NOTICE.