

FOR SALE - 5519 Jillson St

SITE PLAN

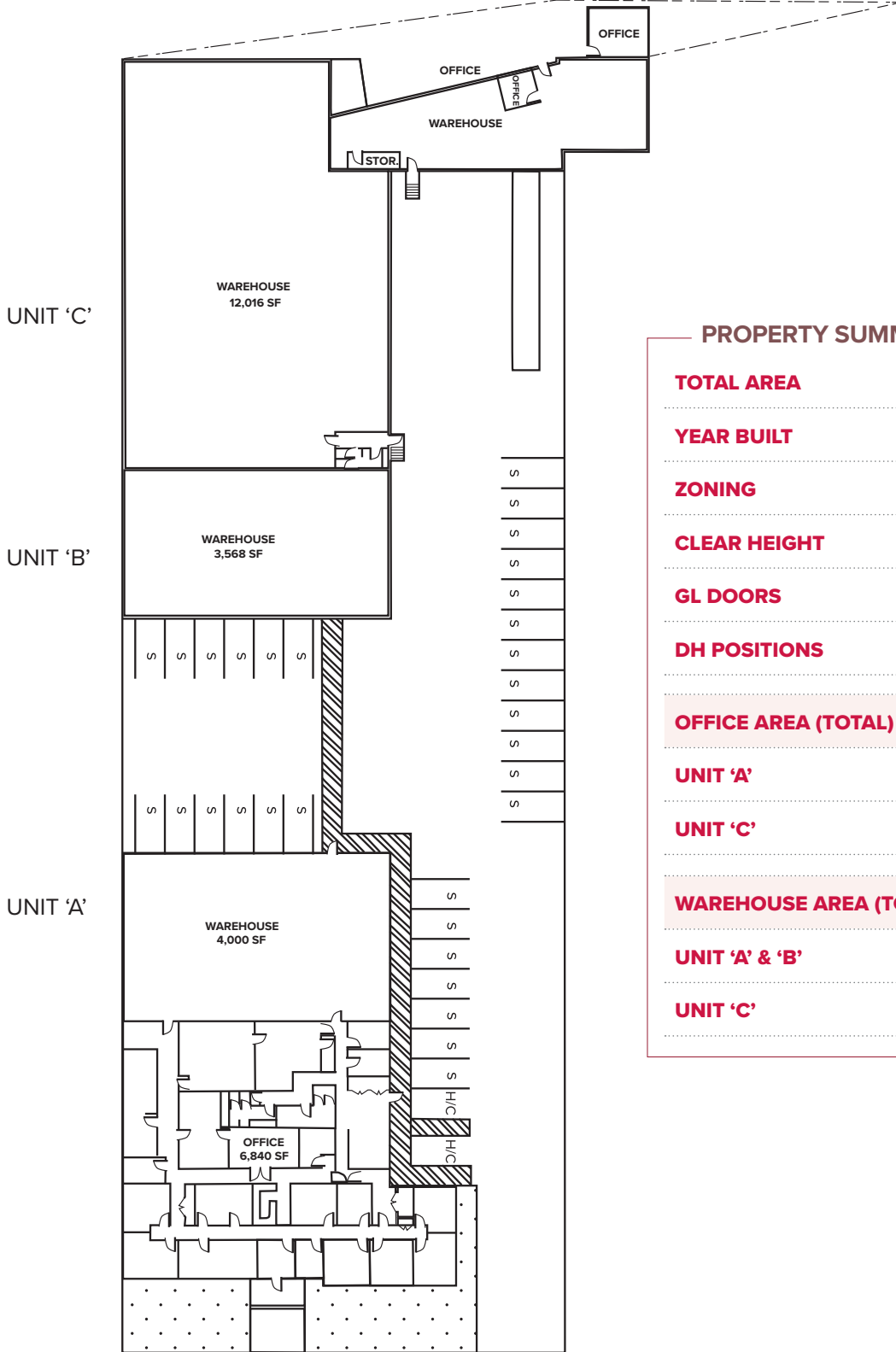

PROPERTY SUMMARY

TOTAL AREA	±26,794 SF
YEAR BUILT	1952
ZONING	CMM2
CLEAR HEIGHT	12' - 18'
GL DOORS	4 (19' x 11' - 10' x 11')
DH POSITIONS	2 (12' x 12')
OFFICE AREA (TOTAL)	±7,210 SF
UNIT 'A'	±6,840 SF
UNIT 'C'	±370 SF
WAREHOUSE AREA (TOTAL)	±19,584 SF
UNIT 'A' & 'B'	±7,568 SF
UNIT 'C'	±12,016

SEHYUNG KIM

Senior Vice President | LIC NO 01327276

skim@lee-associates.com | 213.290.3599

www.skimcre.com

All information furnished regarding property for sale, rental or financing is from sources deemed reliable, but no warranty or representation is made to the accuracy thereof and same is submitted to errors, omissions, change of price, rental or other conditions prior to sale, lease or financing or withdrawal without notice. No liability of any kind is to be imposed on the broker herein.

