

**FOR LEASE**

Owned and Operated by  **LINK**

# MILL CREEK DC

21824 76th Ave S, Kent, WA

**±16,075 SF**



**LEASING INFO  
& CONTACT**

Kraig Heeter, SIOR (206) 248.7313 / [kraig.heeter@kidder.com](mailto:kraig.heeter@kidder.com)  
Doug Klein, SIOR (206) 248.7348 / [doug.klein@kidder.com](mailto:doug.klein@kidder.com)

 **Kidder  
Mathews**

## MILL CREEK DISTRIBUTION CENTER

A 226,000 square foot industrial park developed in 1989 and 1990, Mill Creek Distribution Center features tremendous access to I-5 and SR-167 via 76th Ave S 212th St. The park is designed with tenants who require extensive use of dock doors for their operation and is unique as a result of the availability of trailer parking for most spaces. The park is professionally managed and leased by Kidder Mathews.

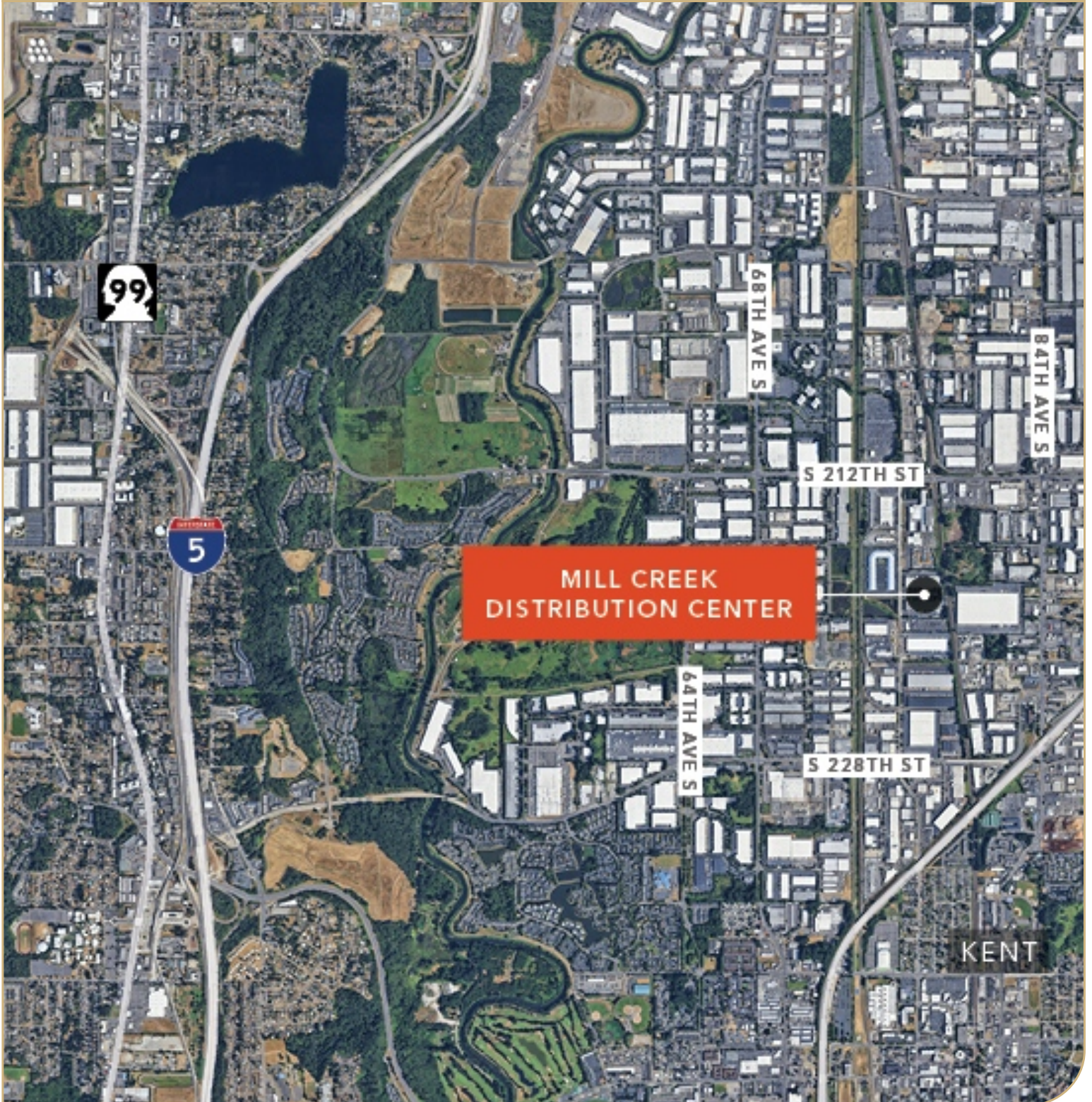



SITE PLAN

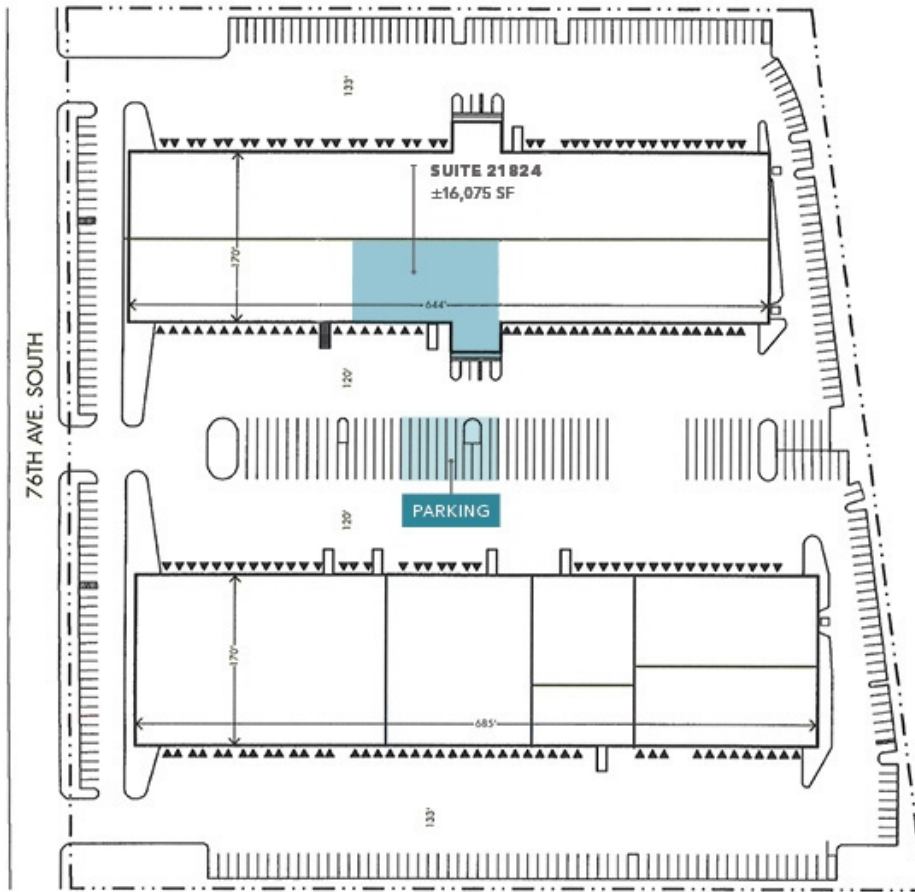

FEATURES

Available SF	±16,075 SF (±2,251 SF office)	Available	Now
Finishes	Recently remodeled	Trailer Parking	12 total, \$100/mo, per stall
Clear Height	21' - 22'	Zoning	M-3 heavy industrial
Loading	6 DH / 1 GL	Rates	\$0.95 PSF shell / \$1.35 PSF office add-on, NNN + trailer parking fee