



Mequon Research Center

N Baehr Road at W Donges Bay Road
Mequon, WI 53092



NAIOP
COMMERCIAL REAL ESTATE
DEVELOPMENT ASSOCIATION
NATIONAL
DEVELOPER
OF THE YEAR
— 2018 —

SJPI.COM/WISCONSIN | 262.524.0100



About Mequon Research Center

Mequon Research Center is a mixed-use business community located near the intersection of W Donges Bay Road and N Baehr Road in Mequon, Wisconsin.

Mequon Research Center is comprised of seven buildings, totaling more than 226,200 square feet of office and flex/R&D space. Tenant sizes from 1,500 square feet to 48,400 square feet of space offer businesses straight-forward, economical and high-utility space.

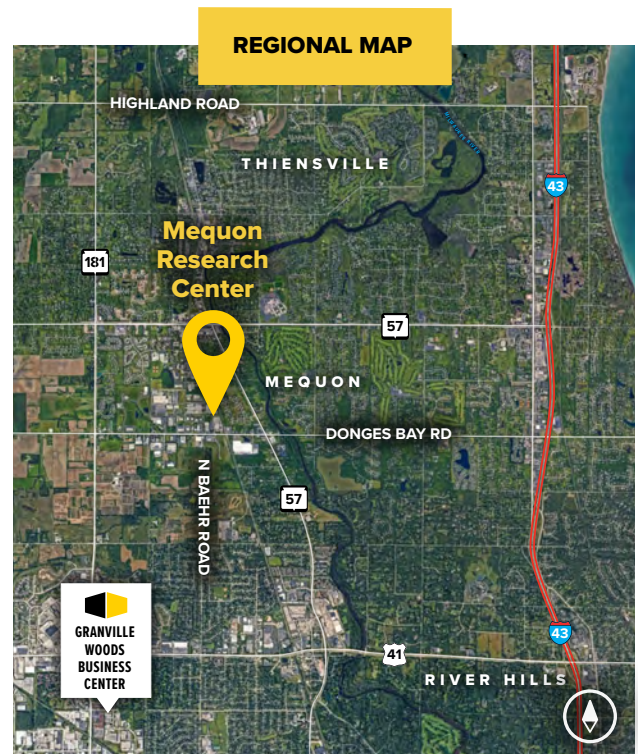



About St. John Properties

St. John Properties, Inc. is one of the nation's largest and most successful privately held commercial real estate firms. Founded in 1971 by Edward St. John and headquartered in Baltimore, Maryland, the company has develops, owns, and manages more than 23 million square feet of office, flex/research and development, warehouse, retail and residential space nationwide. St. John Properties is a vertically-integrated real estate developer, and maintains an excellent credit history with no loan defaults. In 2018, the company was named The National Developer of the Year by NAIOP, the Commercial Real Estate Development Association.

Visit sjpi.com/about to learn more.



23+ MILLION
Square Footage
Owned & Managed



\$5+ BILLION
Real Estate
Investment Value



100+
Green, LEED-Certified
Buildings



2,500+
Clients Across
the Country



172
Business Communities
Across the Country



225+
Employees Across
the Country

*“We don’t just believe in a **commitment to excellence**. We practice it every day.”*

Edward St. John, Founder & Chairman



Flex/R&D/Office Buildings

6000 W Executive Drive	30,300 SF
6040 W Executive Drive	30,300 SF
6100 W Executive Drive	30,300 SF
6140 W Executive Drive	30,300 SF
10520 N Baehr Road	48,400 SF
10650 N Baehr Road	21,000 SF

Flex/R&D/Office Specifications

Suite Sizes	1,500 up to 48,400 SF
Ceiling Height	16 ft. clear minimum
Parking	
<i>W Executive Drive</i>	2 spaces per 1,000 SF
<i>N Baehr Road</i>	4.5-5 spaces per 1,000 SF
Heat	Natural Gas
Construction	Brick on Block/Masonry
Zoning	B-5

Class 'B' Office Building

10375 N Baldev Court	35,654 SF
----------------------	-----------

Building Specifications

Suite Sizes	Up to 35,654 SF
Ceiling Height	9.6 ft. clear minimum
Parking	5.8 spaces per 1,000 SF
Zoning	B-5

🕒 28 MILES TO WAUKESHA
 🕒 15 MILES TO MILWAUKEE



Flex/R&D/Office

Direct-entry flexible space

St. John Properties has perfected the design and construction of flex/research and development (R&D) buildings by combining expansive windows and attractive landscaping in the front with loading capabilities in the rear.

Most flex/R&D buildings offer 30-foot-wide spaces and 16-foot clear ceiling heights for maximum flexibility.

For more information on Mequon Research Center, visit: sjpi.com/mequon

Flex/R&D/Office Buildings

6000 W Executive Drive	30,300 SF
6040 W Executive Drive	30,300 SF
6100 W Executive Drive	30,300 SF
6140 W Executive Drive	30,300 SF
10520 N Baehr Road	48,400 SF
10650 N Baehr Road	21,000 SF

Flex/R&D/Office Specifications

Suite Sizes	1,500 up to 48,400 SF
Ceiling Height	16 ft. clear minimum
Parking	
<i>W Executive Drive</i>	2 spaces per 1,000 SF
<i>N Baehr Road</i>	4.5-5 spaces per 1,000 SF
Heat	Natural Gas
Construction	Brick on Block/Masonry
Zoning	B-5







10375 N Baldev Court

Two-Story Class 'B' office space

About the Building

- ▶ Two-story atrium lobby
- ▶ Monument signage
- ▶ Raised IT room flooring
- ▶ On-site UPS system
- ▶ Expansive glass lines

Class 'B' Office Building

10375 N Baldev Court 35,654 SF

Building Specifications

Suite Sizes	Up to 35,654 SF
Ceiling Height	9.6 ft. clear minimum
Parking	5.8 spaces per 1,000 SF
Zoning	B-5

Regional Area Map

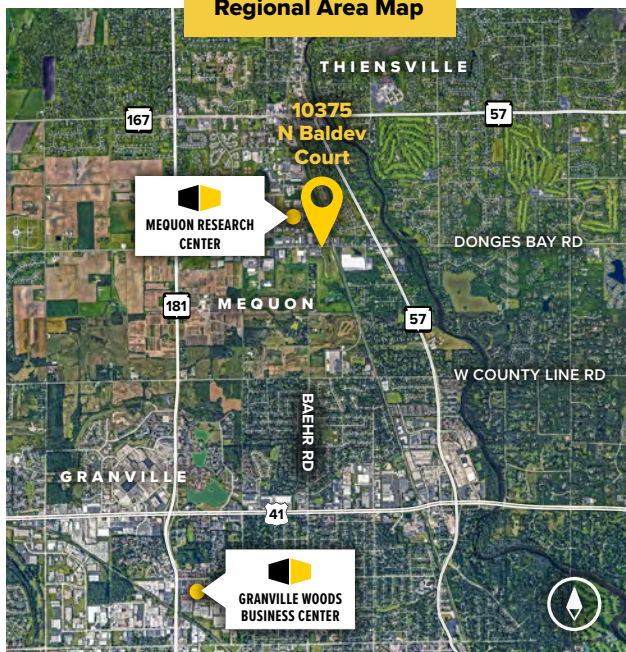

For more information on Mequon Research Center, visit: sjpi.com/mequon

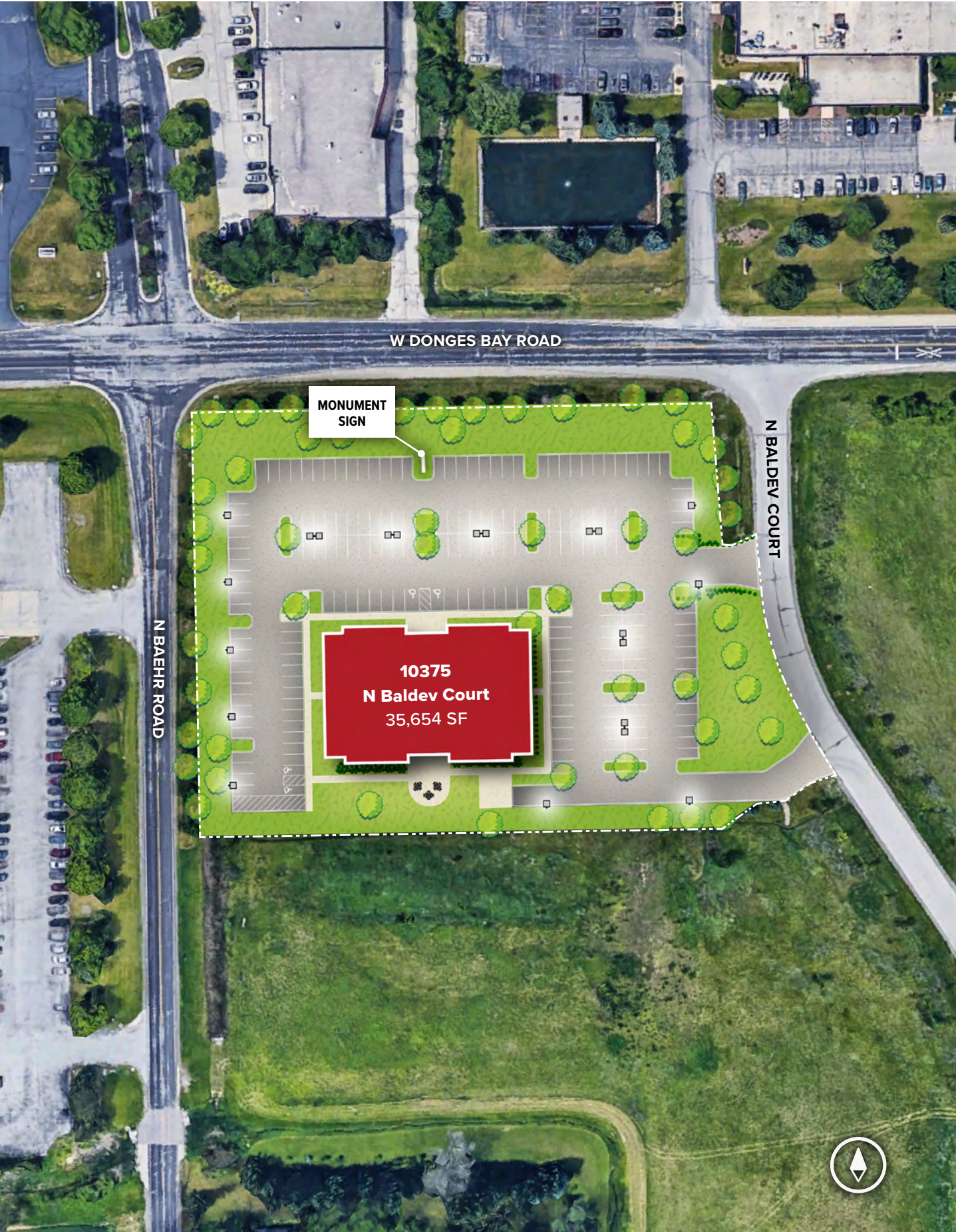

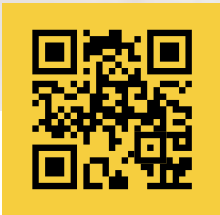

Scan with your mobile device to take a virtual tour, download floor plans and more!

Contact Us

For additional leasing information or to schedule a tour, contact:

Greg Fax
Regional Partner, Wisconsin
gfx@sjpi.com | 262.524.0100

Wisconsin Regional Office:
2000 Pewaukee Road | Suite A
Waukesha, WI 53188

262.524.0100 | SJPI.COM/WISCONSIN

About St. John Properties

St. John Properties Wisconsin owns and is developing more than 1.7 million square feet of commercial space across 15 business communities in Wisconsin.

St. John Properties, Inc. is one of the nation's largest and most successful privately held commercial real estate firms. Founded in 1971, the vertically-integrated company develops, owns and manages office, flex/ research and development, warehouse, retail and residential space nationwide.

Connect with us @stjohnprop

