



## 8950 Hacks Cross Rd

Olive Branch, Mississippi 38654

### Property Features

- 22' Clear Height
- Main Office - 3,500 SF
- Warehouse break room and training room - 2,000 SF
- Additional warehouse office - 5,400 SF
- 100% air-conditioned
- Approx. 4 acres of land for expansion or outside storage
- DeSoto County Submarket
- Minutes to Memphis International Airport
- Easy Access to 302, 385, I-240 and US-78
- Asking lease rate: \$4.50 PSF N

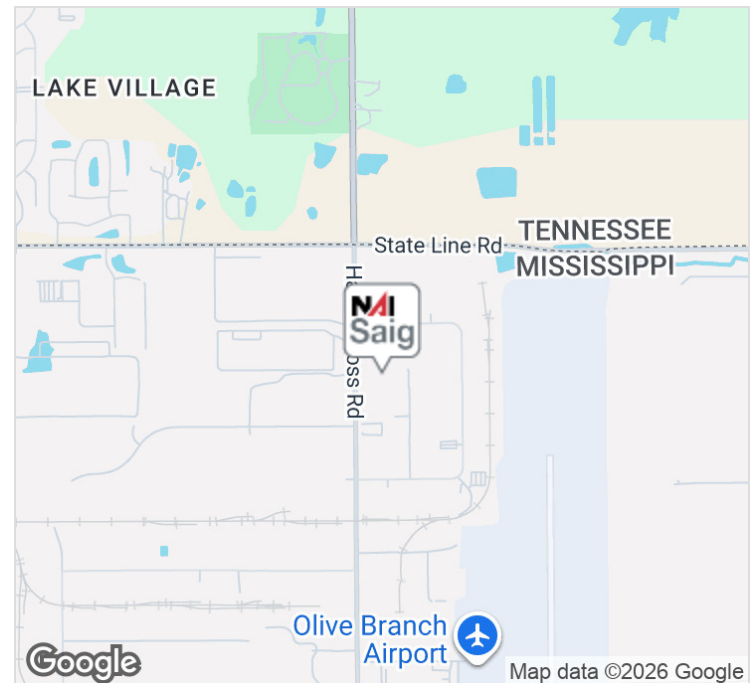

For more information:

**Hank Martin, SIOR**

901 526 3100 • [hmartin@saigcompany.com](mailto:hmartin@saigcompany.com)

NO WARRANTY OR REPRESENTATION, EXPRESS OR IMPLIED, IS MADE AS TO THE ACCURACY OF THE INFORMATION CONTAINED HEREIN, AND THE SAME IS SUBMITTED SUBJECT TO ERRORS, OMISSIONS, CHANGE OF PRICE, RENTAL OR OTHER CONDITIONS, PRIOR SALE, LEASE OR FINANCING, OR WITHDRAWAL WITHOUT NOTICE, AND OF ANY SPECIAL LISTING CONDITIONS IMPOSED BY OUR PRINCIPALS NO WARRANTIES OR REPRESENTATIONS ARE MADE AS TO THE CONDITION OF THE PROPERTY OR ANY HAZARDS CONTAINED THEREIN ARE ANY TO BE IMPLIED.

NAI Saig Company

6263 Poplar Avenue Suite 150, Memphis, TN 38119

901 526 3100

[saigcompany.com](http://saigcompany.com)

For Lease

# Industrial

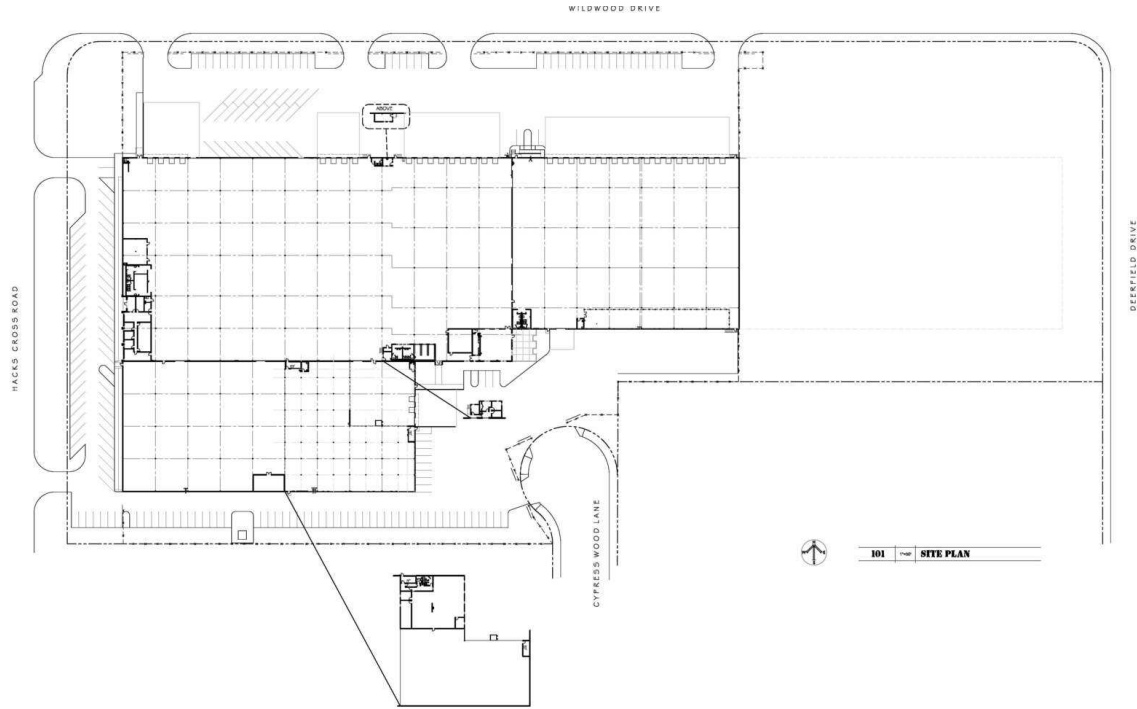

**ASBUILT**  
8950 HACKS CROSS ROAD  
Olive Branch Mississippi

REV: CA  
REV: C  
PROJ: 13  
DATE: 1/20/2010

## PROPERTY FEATURE

- T-8 Fluorescent Lights
- Column Spacing - 40' x 40' and 50' x 40'
- Sprinkler Density: .30/4,000 SF, .35/2,700 SF, and .53/2,700 SF
- 25,500 SF Mezzanine
- 37 Dock High Doors (34 with levelers)
- 1 - 12' x 14' Drive In Door
- 4,000 AMP; 480 Volt, 3-Phase Electrical Service
- Skylights
- Suspended Gas Heaters

For Lease

# Industrial



Cypress Woods Lane Entrance



Wildwood Drive Truck Court



Main Entrance



Vacant lot at Deerfield and Wildwood Drive