

1973 S. DIVISION AVENUE
GRAND RAPIDS, MICHIGAN

RETAIL FOR SALE
7,137 Square Feet Available



**SIGNATURE
ASSOCIATES**
KNOW SIGNATURE | KNOW RESULTS

PRIME LOCATION & VISIBILITY



PROPERTY FEATURES

- 7,137 total building square feet
- Located on 0.173-acre corner lot
- Zoned TN-TBA
- Sale Price: \$925,000 (\$129.61/sf)

Comments: Excellent window visibility on a very busy corridor, capturing foot and vehicular traffic from Division Ave. This hard-corner advantage maxes exposure to a high-density customer base. Nestled in a bustling retail and dining stretch, the property benefits from synergistic traffic patterns and ongoing daytime-to-evening activity, boosting potential for impulse visits. The zoning supports adaptive, future-ready uses. Well-presented interior space with a practical footprint suitable for a variety of concepts—retail showroom, boutique, restaurant/fast-casual, fitness pop-up, or multi-tenant configurations.

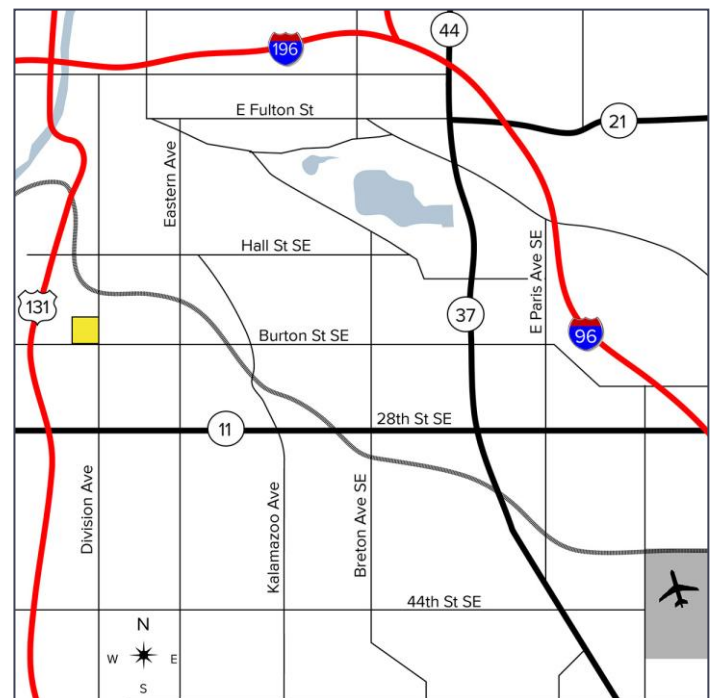

For more information, please contact:

JOE RIZQALLAH
(616) 822 6310

jrizzqallah@signatureassociates.com

CAROLYN BOJI
(616) 213 4560

cboji@signatureassociates.com

SIGNATURE ASSOCIATES
1188 East Paris Ave SE, Suite 220
Grand Rapids, MI 49546
www.signatureassociates.com

1973 S. Division Avenue – Grand Rapids, Michigan

Retail For Sale

7,137
Square Feet
AVAILABLE

Aerial

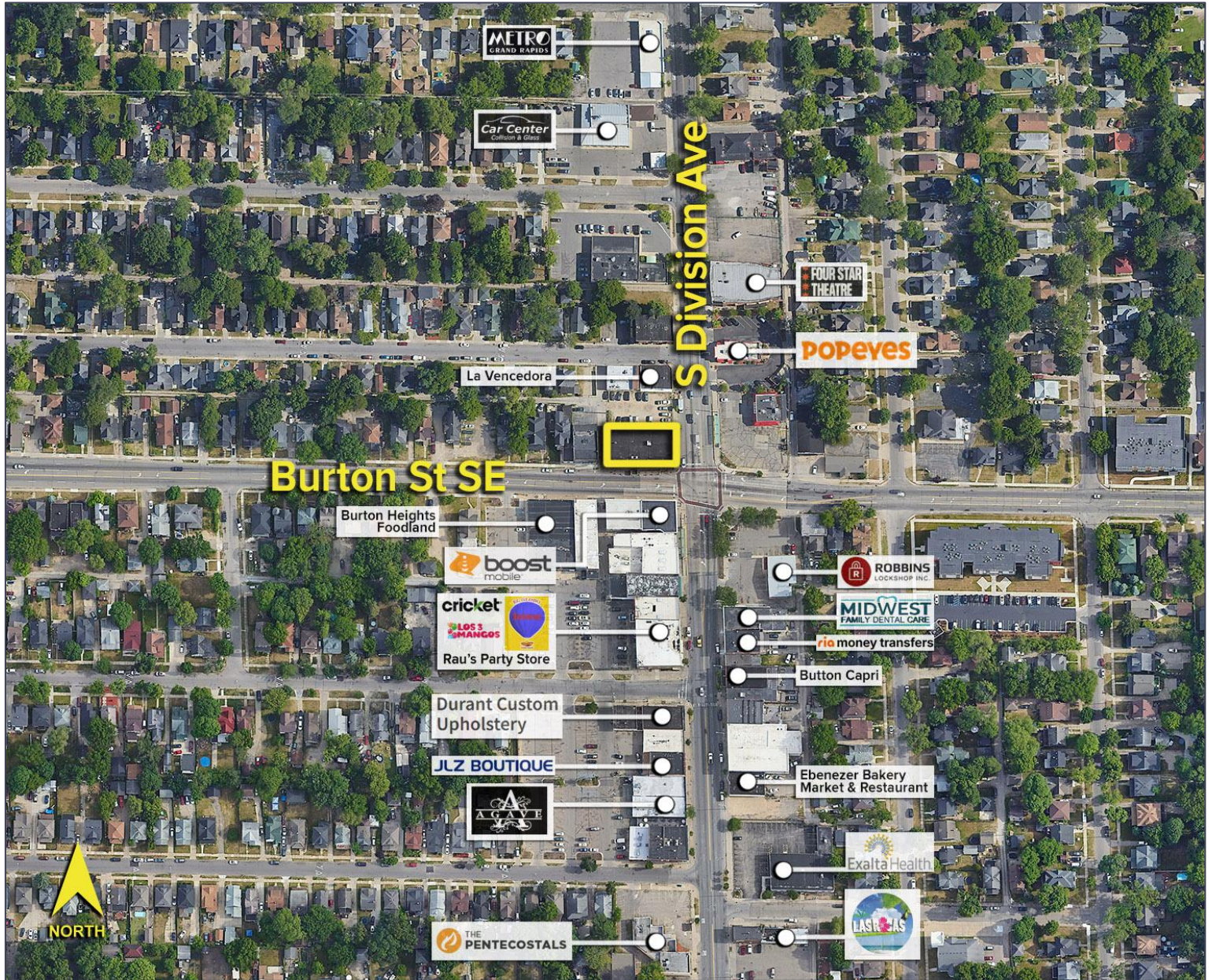

DEMOGRAPHICS

	POPULATION	MED. HH INCOME
1 MILE	20,548	\$60,795
3 MILE	142,748	\$74,355
5 MILE	304,665	\$75,238

TRAFFIC COUNTS (TWO-WAY)

16,105	Division Ave north of Burton St
17,062	Division Ave south of Burton St
15,925	Burton St west of Division Ave
16,363	Burton St east of Division Ave

For more information, please contact:

JOE RIZQALLAH
(616) 822 6310
jrizzqallah@signatureassociates.com

CAROLYN BOJI
(616) 213 4560
cboji@signatureassociates.com

SIGNATURE ASSOCIATES
1188 East Paris Ave SE, Suite 220
Grand Rapids, MI 49546
www.signatureassociates.com