

Publix #1637 - Publix at Lake Crossing

5443 Platt Springs Road
Lexington, SC 29073
Lat 33.908, Long -81.224

FOR LEASE



1,400 SF AVAILABLE

PROPERTY HIGHLIGHTS

- Located in High Growth Market of Lexington, SC
- Publix-Anchored Center with 700,000+ Visitors Annually
- Excellent Opportunity for Restaurants, Medical and Service Oriented Tenants
- Traffic Count: 32,300 VPD

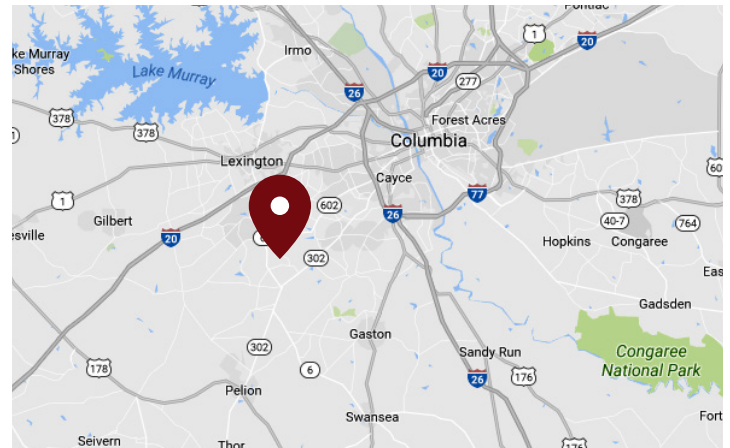

DEMOGRAPHICS	1 Mile	3 Miles	5 Miles
Total Population	5,387	23,086	59,351
Daytime Population	4,394	15,255	45,445
Total Households	1,976	8,585	22,506
Avg. HH Income	\$82,551	\$81,186	\$91,070

Data provided by Placer Labs Inc. (www.placer.ai) & Esri

Melody Holley

Office: 770.541.6886 | Cell: 678.414.8989 | mholley@crossmanco.com
6400 Powers Ferry Road, Suite 300, Atlanta, GA

Licensed Real Estate Broker. No warranty expressed or implied has been made to the accuracy of the information provided herein, no liability assumed for error or omission.



www.crossmanco.com

Publix #1637 - Publix at Lake Crossing

5443 Platt Springs Road
Lexington, SC 29073
Lat 33.908, Long -81.224

SITE PLAN

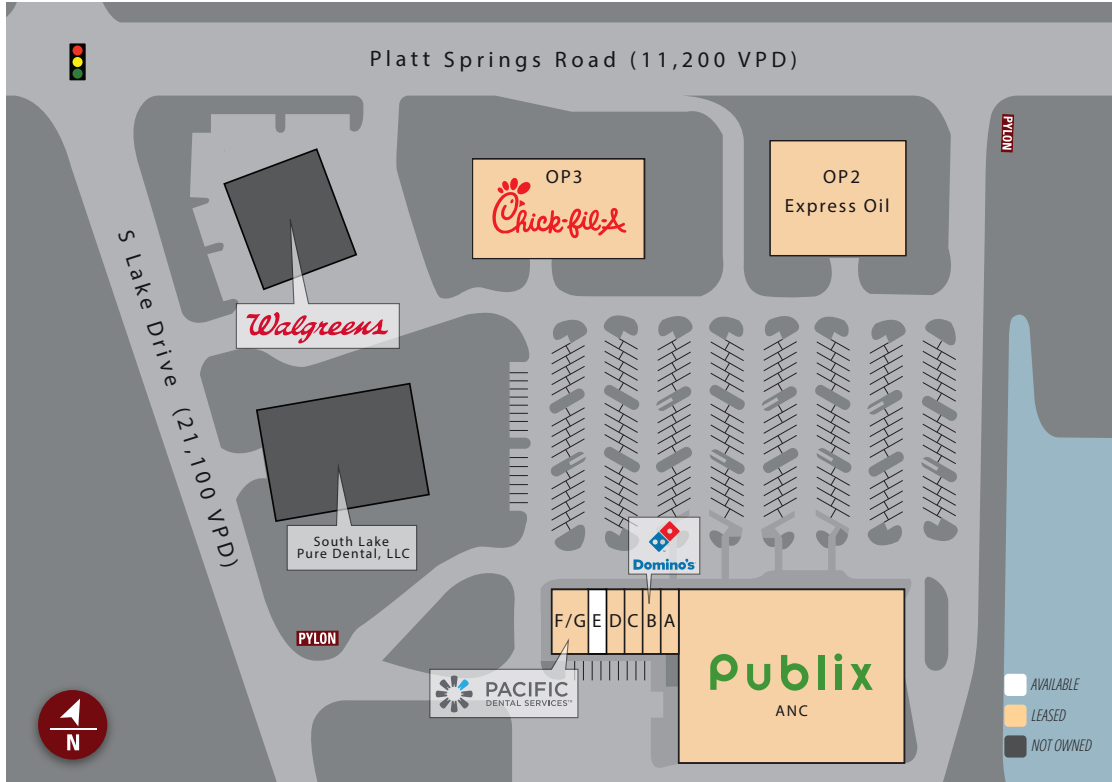

Suite	Tenant	Size
ANC	Publix	45,600
A	Lee Nails	1,400
B	Domino's	1,400
C	The Bottle Shop	1,400
D	Drayer	1,400
E	AVAILABLE	1,400
F/G	Pacific Dental	2,800
OP2	Express Oil	±0.95 AC
OP3	Chick-fil-A	±1.28 AC

TOTAL 55,400



Melody Holley

Office: 770.541.6886 | Cell: 678.414.8989 | mholley@crossmanco.com
6400 Powers Ferry Road, Suite 300, Atlanta, GA

Licensed Real Estate Broker. No warranty expressed or implied has been made to the accuracy of the information provided herein, no liability assumed for error or omission.



Crossman & Company
www.crossmanco.com

Publix #1637 - Publix at Lake Crossing

5443 Platt Springs Road
Lexington, SC 29073
Lat 33.908, Long -81.224

FOOT TRAFFIC OVERVIEW

EST. # OF CUSTOMERS ANNUALLY



EST. # OF VISITS ANNUALLY

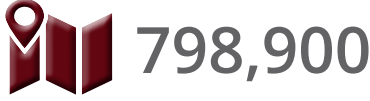

AVG. VISITS / CUSTOMER



AVG. LENGTH-OF-STAY / VISIT



TOP 3 DAYS



Saturday	146,543
Sunday	140,760
Friday	109,541

OF VISITS

TOP 3 HOURS



5-6 PM	148,981
4-5 PM	145,111
6-7 PM	131,948

OF VISITS

Data provided by Placer Labs Inc. (www.placer.ai) March 1, 2022 - February 28, 2023

SITE VISIT DENSITY

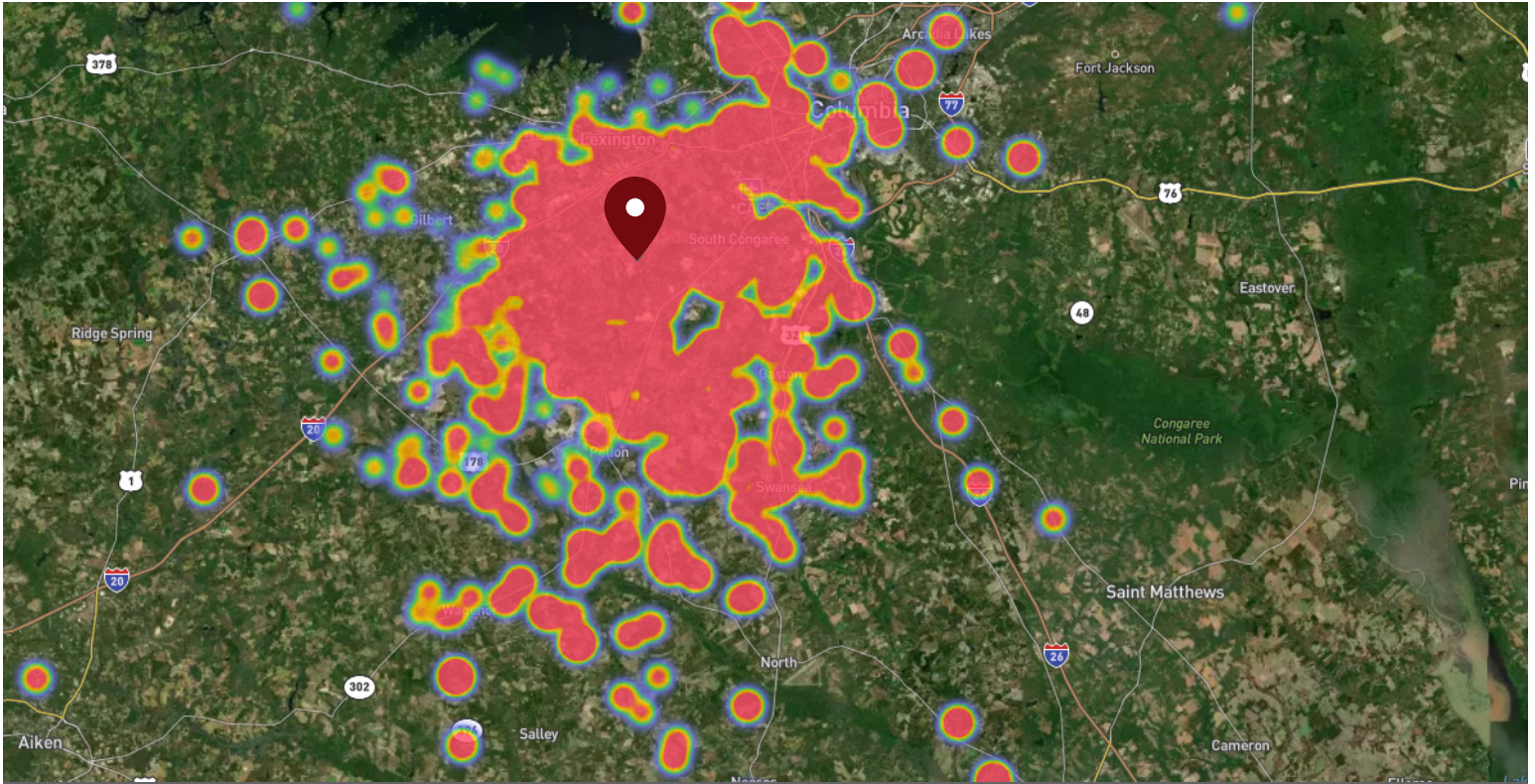

Red, orange, and yellow colors represent the location of 60% of site visitors

Data provided by Placer Labs Inc. (www.placer.ai)

Melody Holley

Office: 770.541.6886 | Cell: 678.414.8989 | mholley@crossmanco.com
6400 Powers Ferry Road, Suite 300, Atlanta, GA

Licensed Real Estate Broker. No warranty expressed or implied has been made to the accuracy of the information provided herein, no liability assumed for error or omission.



www.crossmanco.com