

LOCATION

615 Boardman Canfield Rd, Boardman, OH 44512

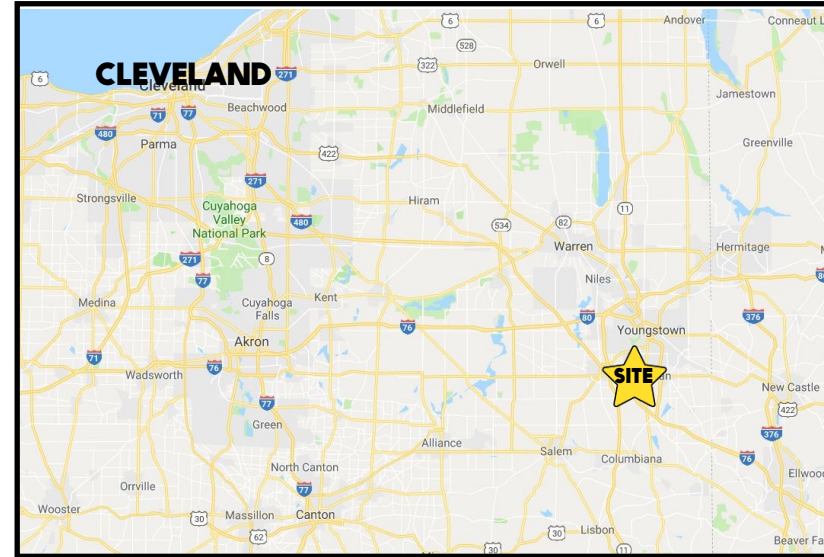

HIGHLIGHTS

- Inline retail space in an updated building
- Central location in the heart of Boardman's commercial corridor, adjacent to Boardman Plaza, across from Giant Eagle and Speedway
- Building and street signage

TRAFFIC

Boardman Canfield Rd = 34,327 VPD

CONTACT

BILL KUTLICK

330.565.5701

bkutlick@platzrealtygroup.com

Office: 330.757.4889 | Fax: 330.294.5622 | 3830 Starr Centre Dr, Suite 2, Canfield, OH 44406

www.PLATZREALTYGROUP.com



Office: 330.757.4889 | Fax: 330.294.5622 | 3830 Starr Centre Dr, Suite 2, Canfield, OH 44406

www.PLATZREALTYGROUP.com

The information presented was obtained from sources believed to be true and reliable. The Platz Realty Group makes no warranties or guarantees to the accuracy of the information.

Former Buyology



Former Grocery Store (Endcap)

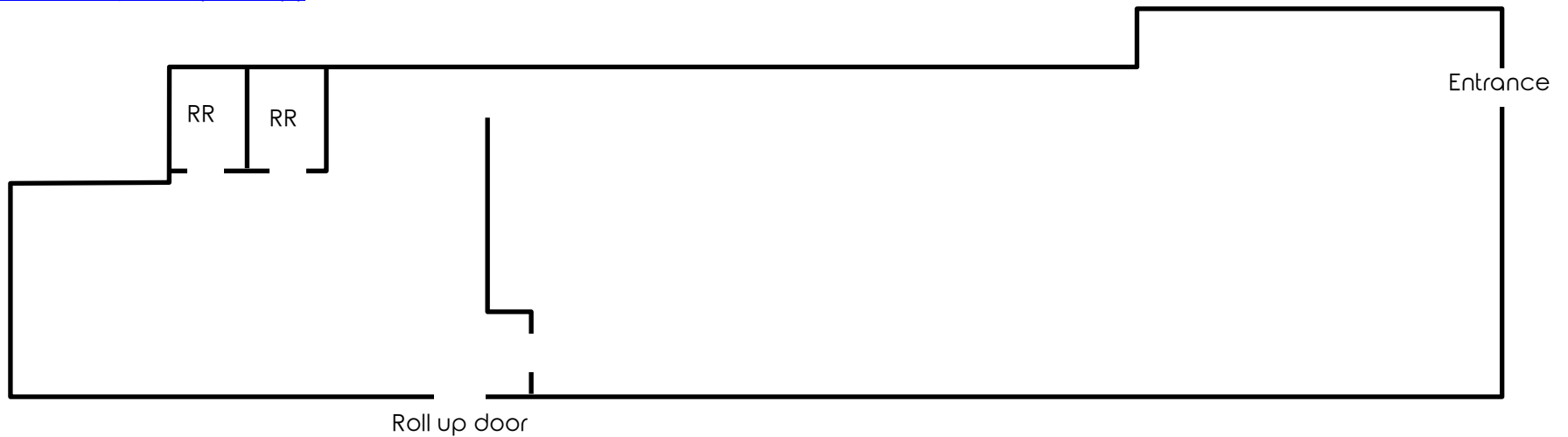

Office: 330.757.4889 | Fax: 330.294.5622 | 3830 Starr Centre Dr, Suite 2, Canfield, OH 44406

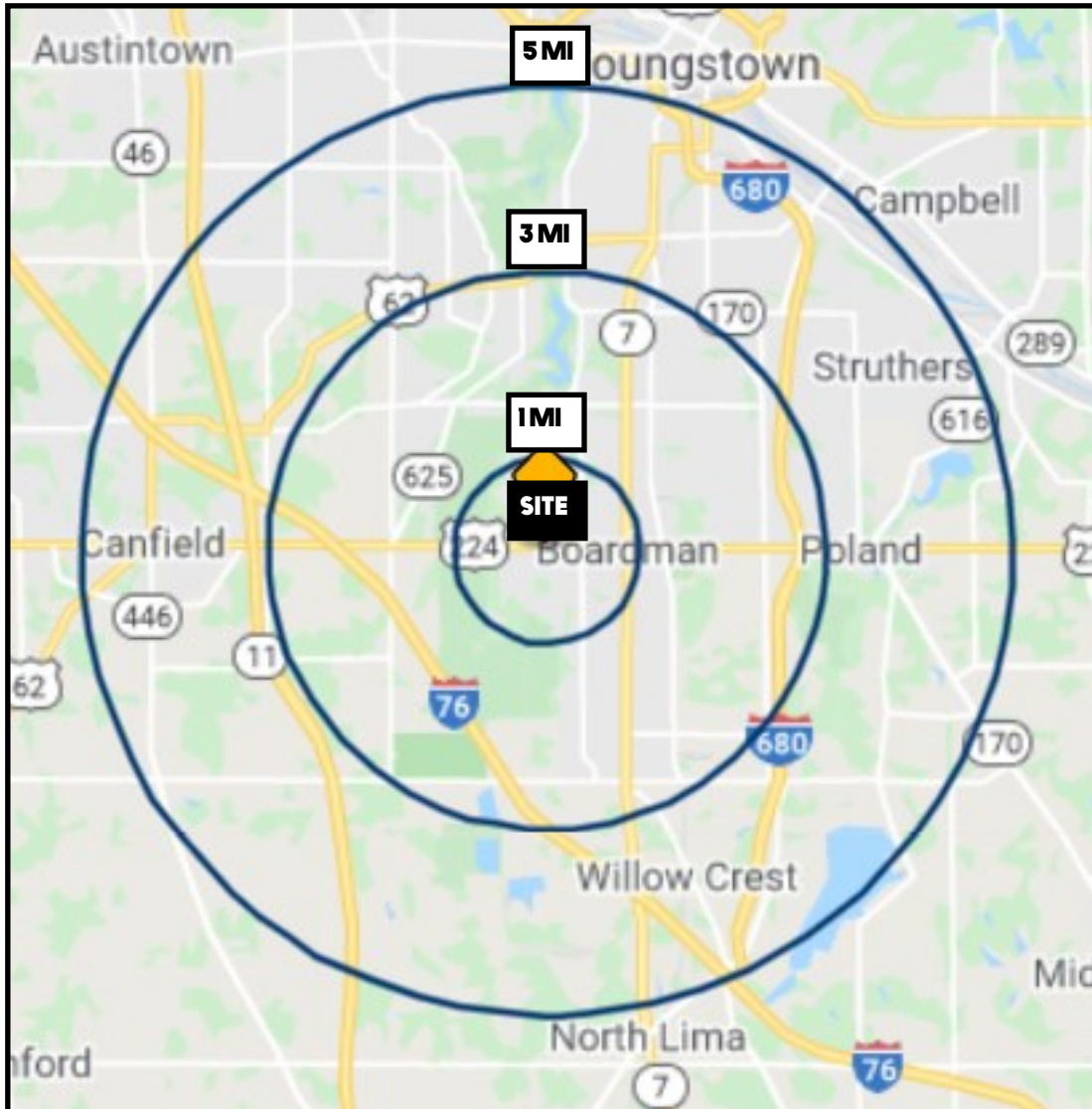

DEMOGRAPHICS	1 MI	3 MI	5 MI
POPULATION	7,518	46,778	116,780
HOUSEHOLDS	3,440	20,316	49,676
MEDIAN AGE	45	44	44
AVERAGE HH INCOME	\$75,106	\$76,964	\$69,198

SITE INFORMATION

LOCATION	Boardman Township Mahoning County
PROPERTY TYPE	Retail
ZONING	General Business
SIGNAGE	Building and street
AVAILABLE	Unit F: 2,986 SF +/- (Endcap)) Unit D: 2,767 SF +/-
BASE RENT	\$11.00/SF NNN
NNN CHARGES	Estimated at \$3.00/SF
UTILITIES	Separately metered

Office: 330.757.4889 | Fax: 330.294.5622 | 3830 Starr Centre Dr, Suite 2, Canfield, OH 44406