



Property Overview - 59 East 46th, Chicago, IL

FP Commercial Advisors is pleased to represent the historic Rosenwald Office and Retail Center in the Bronzeville Community in Chicago. Newly renovated commercial kitchen available for lease on 46th Street and Wabash Avenue interest. Sinks and Hood included. Dedicated Parking spaces available, CTA bus and Metra rail line stops in walking distance. This property has amazing landscaped green space. Unique window lines and natural light with windows that open to the courtyard.

Prime South Side location with strong co-tenants including restaurants, Goede Health and Rudd Resources. Easy Access to the Dan Ryan Expressway, Chicago's Downtown and Shawn Michelle's Ice Cream.

\$2500 psf Gross

- Zoning B3-2
- 455 SF
- Private Commercial Kithcen

Demographics	1 Mile	2 Mile	5 Mile
Population	49,825	116,961	440,459
Households	23,645	52,107	187,065
Average HH Income	\$36,449	\$53,769	\$58,853

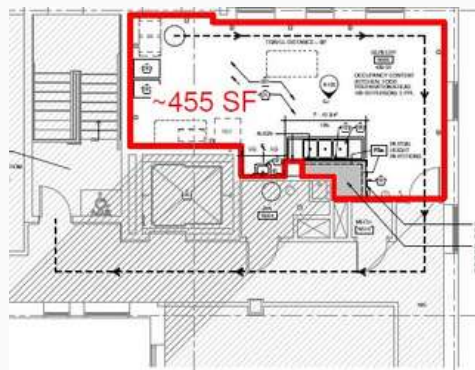
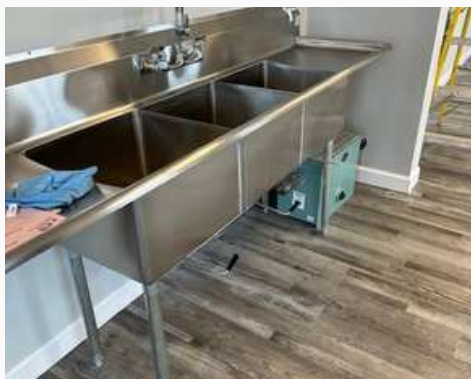

Lauren G Lowery
President/CEO
312.315.5453
Lauren@LaurenLowery.com

FP Commercial.org
FP Commercial Advisors
Real Estate Advisors for Professionals
Information Subject to Change