

# CENTERLINKS-BUILDING 1

16850 ORIOLE ROAD  
FORT MYERS, FLORIDA



Centerlinks Business Park



CBRE



# PROPERTY OVERVIEW

**Centerlinks Business Park** is a Class A industrial park conveniently located near Interstate-75 and Alico Road-one of the most sought-after industrial corridors in Southwest Florida. The industrial warehouse park features dock-high and grade-level loading with LED warehouse lighting and an ESFR sprinkler system.



16850 Oriole Road

Location

+ MPD

Zoning

+ LED

Warehouse Lighting

+ TWO (2)

Dock Doors

+ Tilt-Up

Construction



# INDUSTRIAL SPECIFICATIONS



**37,615 SF**  
Building  
Size



**4,830 SF**  
Available  
Space



**1.7/1,000 SF**  
Parking  
Ratio



**2021**  
Year  
Built



**Wet**  
Sprinkler  
System



**120'**  
Building  
Depth



**1,000 SF**  
Office  
Space



**18'**  
Clear  
Height



# FLOOR PLAN

## CENTERLINKS-BUILDING 1

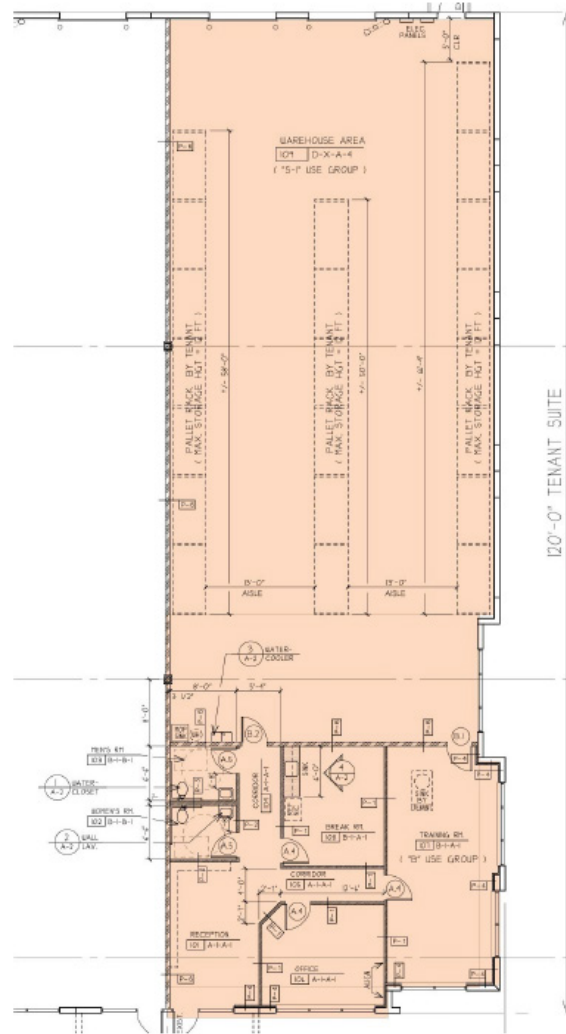

# TRANSPORTATION MAP

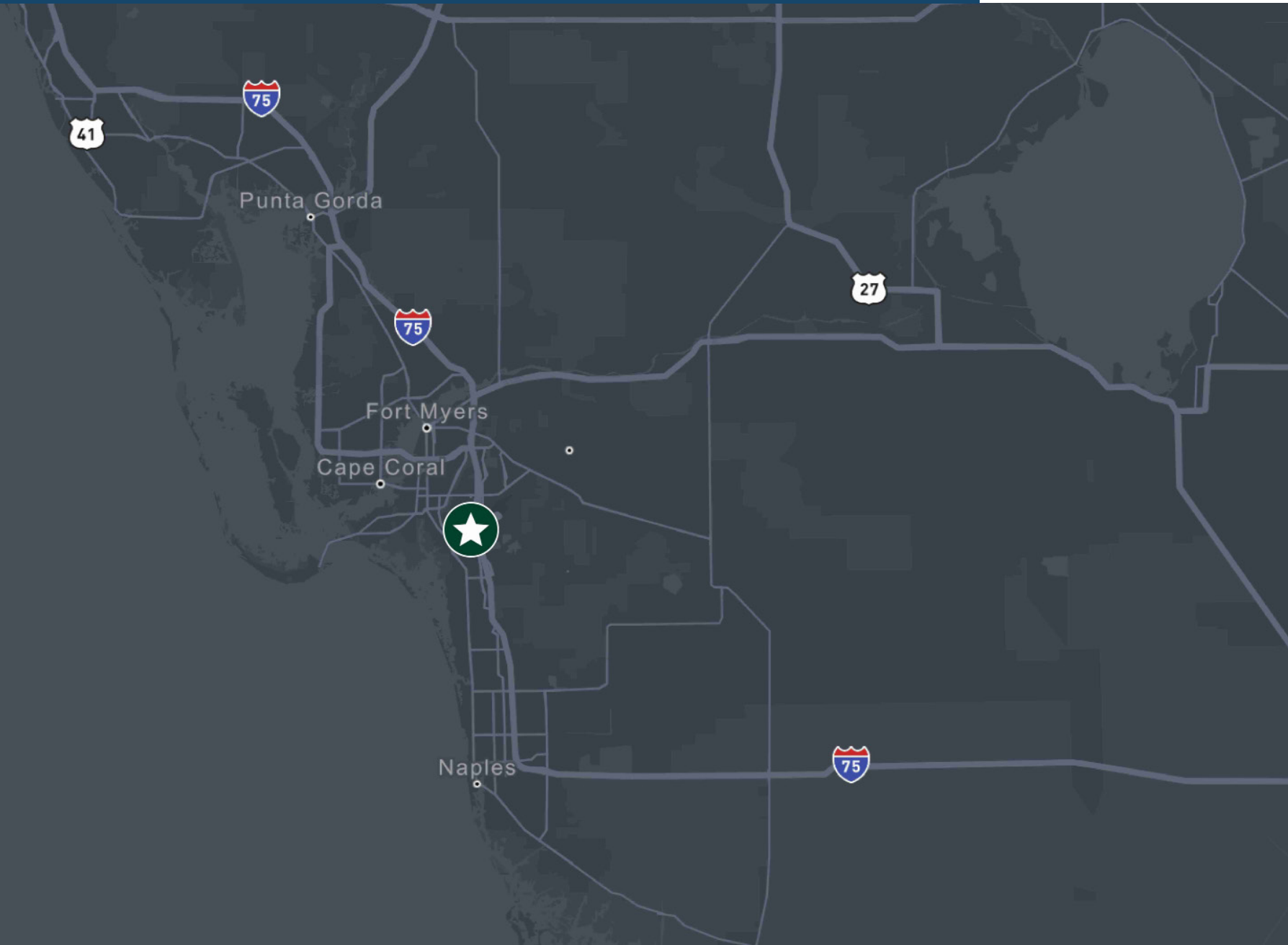

# CENTERLINKS-BUILDING 1

16850 ORIOLE ROAD  
FORT MYERS, FLORIDA



## CONTACT

**DEREK BORNHORST, SIOR, CCIM**

Senior Vice President

+1 239 898 7987

[derek.bornhorst@cbre.com](mailto:derek.bornhorst@cbre.com)

© 2026 CBRE, Inc. All rights reserved. This information has been obtained from sources believed reliable but has not been verified for accuracy or completeness. CBRE, Inc. makes no guarantee, representation or warranty and accepts no responsibility or liability as to the accuracy, completeness, or reliability of the information contained herein. You should conduct a careful, independent investigation of the property and verify all information. Any reliance on this information is solely at your own risk. CBRE and the CBRE logo are service marks of CBRE, Inc. All other marks displayed on this document are the property of their respective owners, and the use of such marks does not imply any affiliation with or endorsement of CBRE. Photos herein are the property of their respective owners. Use of these images without the express written consent of the owner is prohibited.

**CBRE**