

1.551 Acres Development Land

Martin Luther King Jr Parkway
Des Moines, Iowa
www.cbre.com/desmoines

Available Space

+ 1.551 Acres off Martin Luther King Jr Pkwy

Sale Price

+ \$215,000 (\$3.18/SF)

Traffic Counts

+ 22,900 vpd on Euclid Avenue

+ 18,800 vpd on Martin Luther King Jr Parkway

+ 11,600 vpd on Hickman Road

Site Features

+ Great location just South of Douglas/Euclid intersection and North of Hickman

+ Surrounded by dense residential communities

+ Close proximity to Broadlawns Medical Center

+ Zoned MX3



1.551 Acres Development Land

Martin Luther King Jr Parkway | Des Moines, Iowa

For Sale

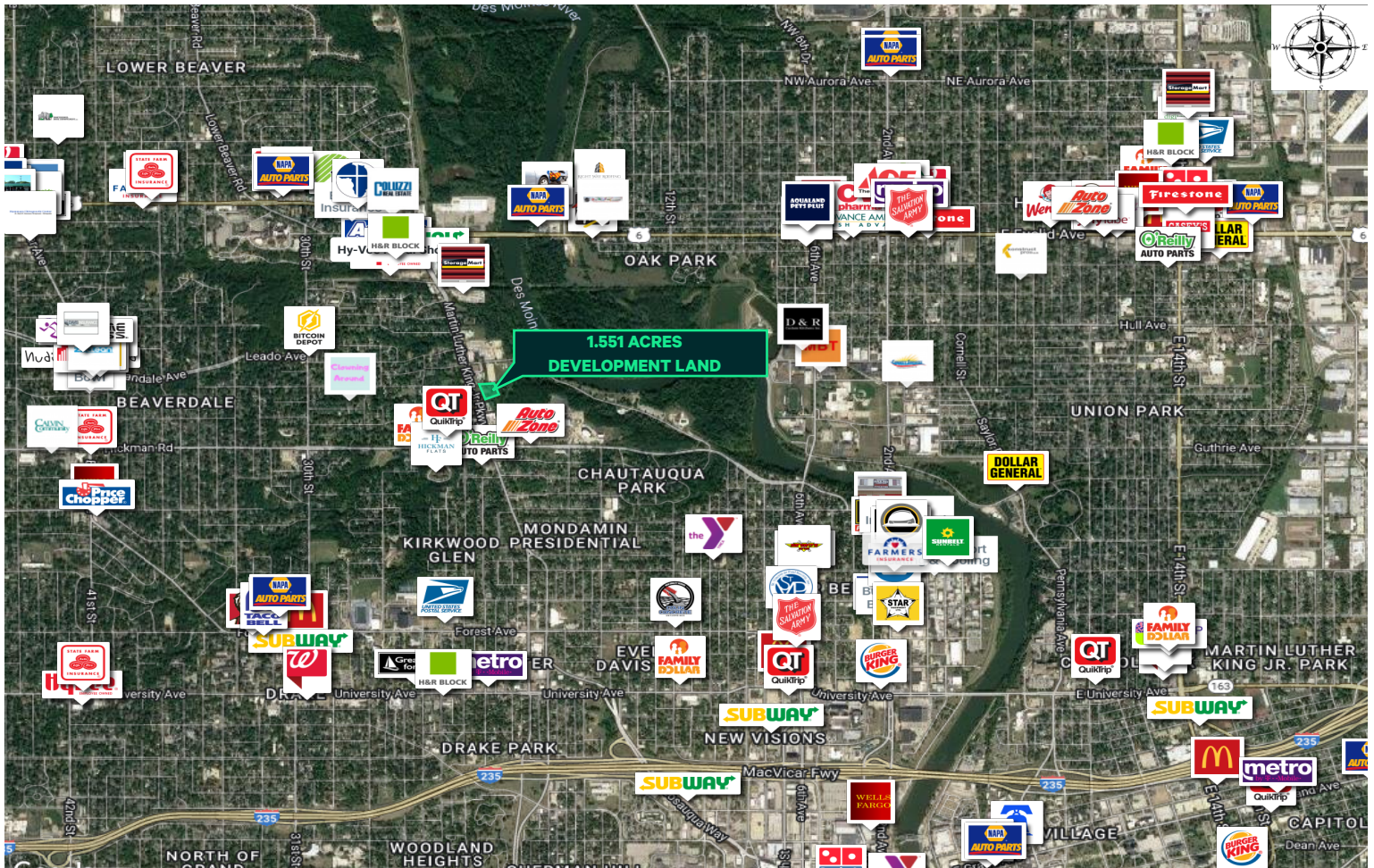

Contact Us

Ben Probst

Sales Associate

+1 515 221 6689

ben.probst@cbre.com

Licensed in the State of Iowa.

© 2023 CBRE, Inc. All rights reserved. This information has been obtained from sources believed reliable, but has not been verified for accuracy or completeness. You should conduct a careful, independent investigation of the property and verify all information. Any reliance on this information is solely at your own risk. CBRE and the CBRE logo are service marks of CBRE, Inc. All other marks displayed on this document are the property of their respective owners, and the use of such logos does not imply any affiliation with or endorsement of CBRE. Photos herein are the property of their respective owners. Use of these images without the express written consent of the owner is prohibited.