

HISTORIC RIVOLI THEATER | 1941 SAN PABLO AVENUE

±18,235 SF GROUND FLOOR RETAIL



maven

NADINE WHISNANT

510.413.7813

nadine@mavenproperties.com

DRE #00966437

PETER MIKACICH

415.288.7815

peter.mikacich@colliers.com

DRE #01133104

Colliers

1941 SAN PABLO AVENUE

SITE PLAN

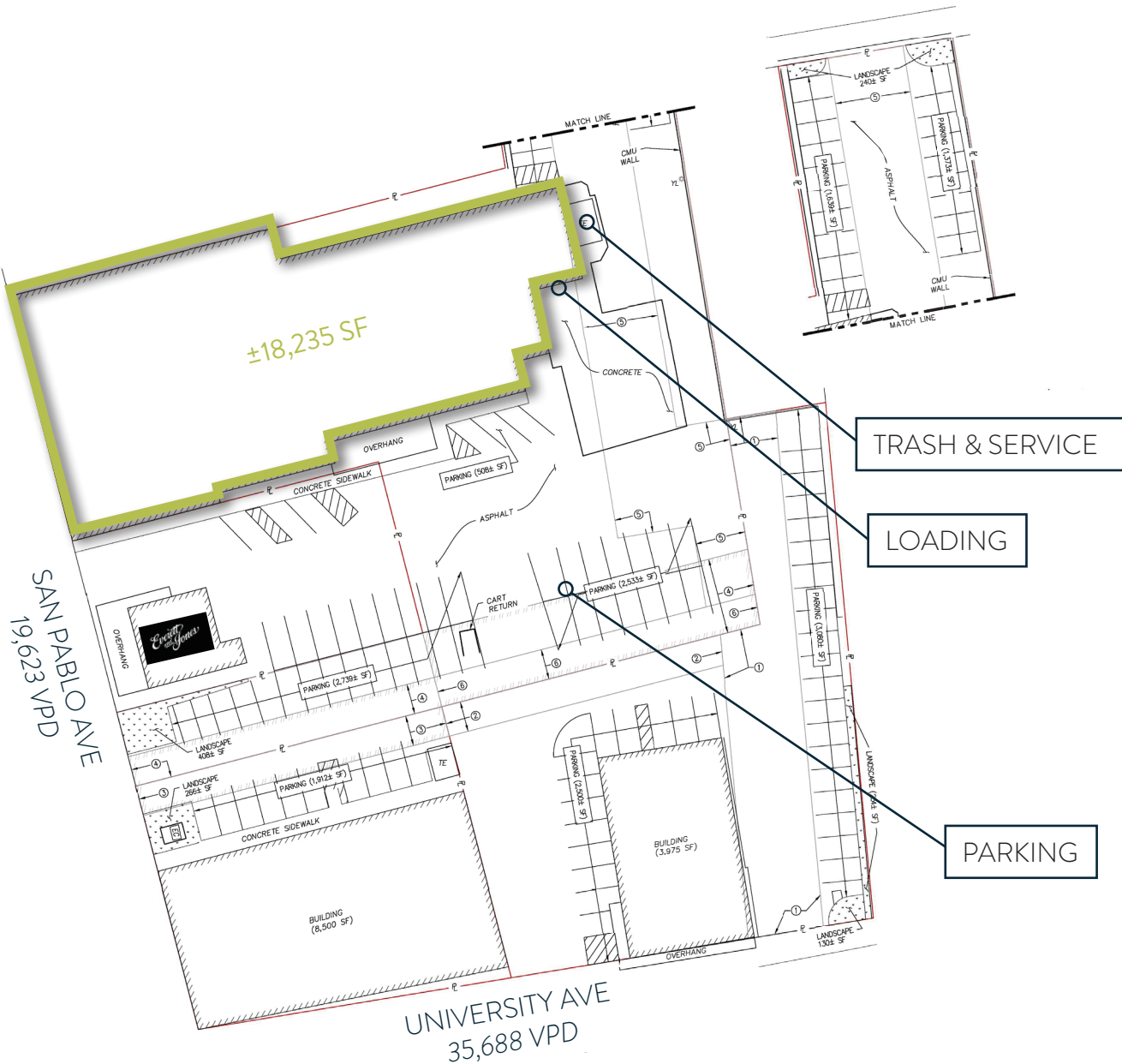

	1 MILE	3 MILE	5 MILE
POPULATION	32,182	205,943	369,460
EMPLOYEES	19,465	140,364	246,826
HOUSEHOLDS	14,572	87,952	162,949
MEDIAN AGE	38	36	38
AVG HH INCOME	118,175	136,635	135,364

BUILDING SPECS

- 1200 AMPS, 120/208V, 3 PHASE POWER
- 4" WATER MAIN
- SPRINKLERED (2003/UPDATED 2008)
- ±100 PARKING SPACES

The information in this brochure has been secured from sources we believe to be reliable but we make no representations or warranties, expressed or implied, as to the accuracy of the information. Buyer or Tenant must verify the information and bears all risk for any inaccuracies. All rights reserved to Goldman Limited

1941 SAN PABLO AVENUE

FLOOR PLAN & DETAILS

- APPROXIMATELY $\pm 18,235$ SF ON THE GROUND FLOOR PLUS $\pm 4,000$ SF MEZZANINE WITH UP TO 36 FT CEILING HEIGHT
- RAISED LOADING DOCK IN REAR WITH FREIGHT ELEVATOR
- 3 VEHICULAR ACCESS POINTS - SAN PABLO AVE, UNIVERSITY AVE, & HEARST AVE
- ZONED C-W (WEST BERKELEY COMMERCIAL)

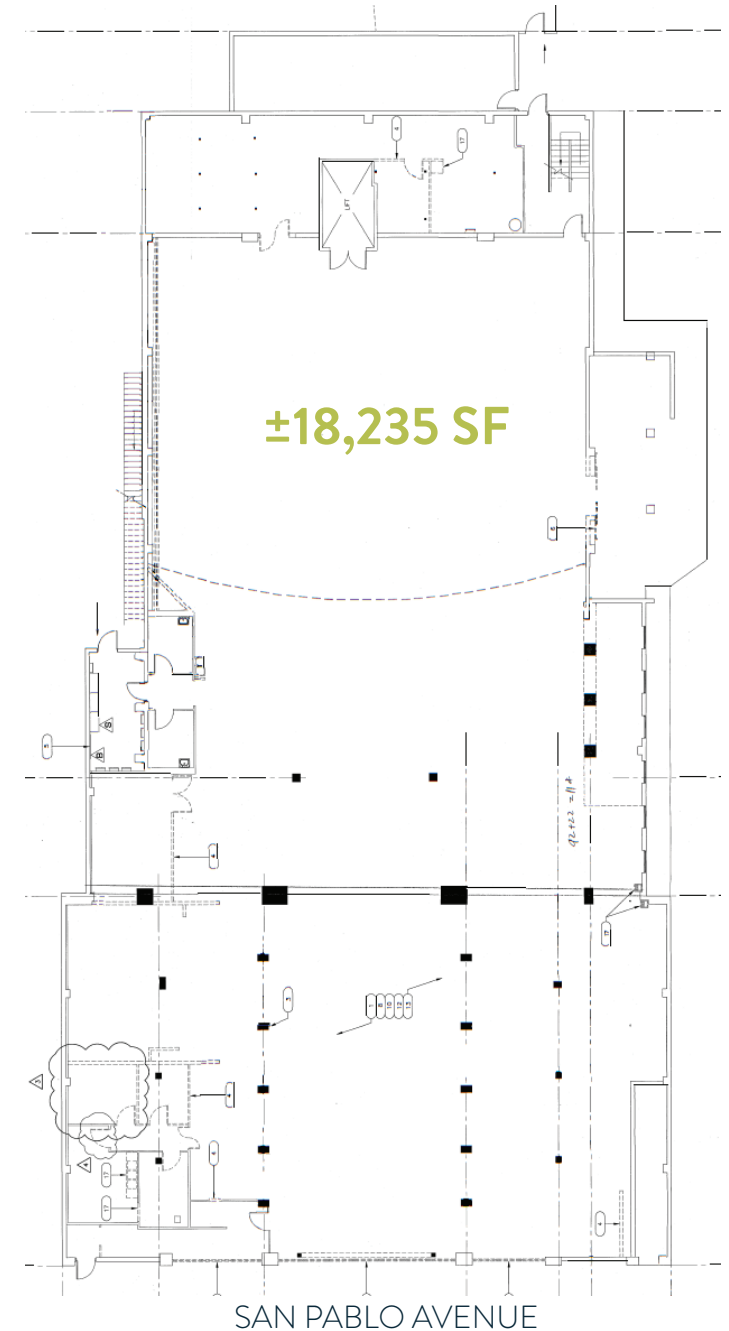

The information in this brochure has been secured from sources we believe to be reliable but we make no representations or warranties, expressed or implied, as to the accuracy of the information. Buyer or Tenant must verify the information and bears all risk for any inaccuracies. All rights reserved to Goldman Limited



Contact

maven

NADINE WHISNANT

510.214.6412

nadine@mavenproperties.com

DRE #00966437

Colliers

PETER MIKACICH

415.288.7815

peter.mikacich@colliers.com

DRE #01133104

NOTICE: This information has been secured from sources we believe to be reliable but we make no representations, warranties, express or implied, as to the accuracy of the information. Listing broker has been given enough information to provide only a preliminary interest in the property. The materials are not to be considered fact. The information contained herein is not a substitute for thorough due diligence investigation. References to square footage, zoning, use, or age are approximate. Please contact the San Francisco Planning Department to verify zoning at (415) 558-6378, as neither broker or landlord represent that this space is suitable for your use. Tenant or Buyer must verify the information at their own expense and bears all the risk for any inaccuracies. By receiving these materials you are agreeing to the disclaimers set forth herein. DRE#01878802

466 Green Street Suite #203

San Francisco, CA 94133

415-781-770

www.mavenproperties.com