

Neighboring Buildings

Neighboring Buildings

Neighboring Building

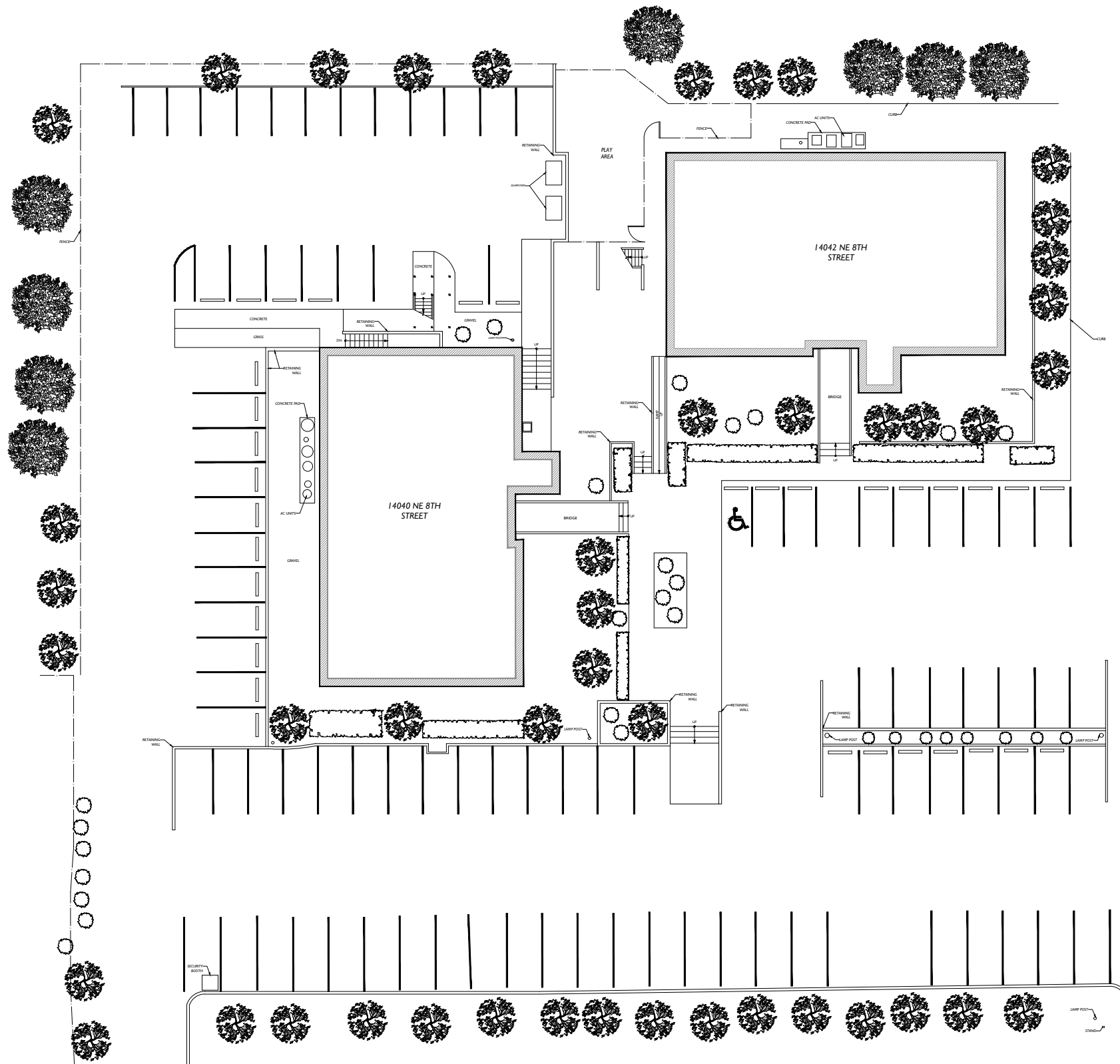

NE 8th Street



2DFLOORPLANS.COM

600 NW Gilman Blvd. Suite E
Issaquah, WA 98027
425-677-7511

This drawing is an instrument of service and is the sole property of the client listed. Any alteration of this drawing without removal of references to 2-D As-Built Floor Plans, Inc. is prohibited.

Drawing scale and dimensions are provided for reference only. Refer to CAD files for exact measurements.

©2010 2-D As-Built Floor Plans, Inc. All Rights Reserved.

Project: C21-925

Date	Action
08/26/2021	Final Site Measure
C21-925	

Client:
AS wealth Group LLC

Site:
Office
14040 & 14042 NE 8th Street
Bellevue, WA 98007

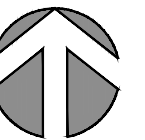

Site Plan

SITE

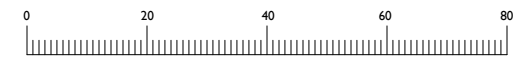

Scale: 1/32" = 1'-0"