



2,500 SF Available



For Lease

**Aaron Flynn**  
+1 208 807 3332  
aaron.flynn@colliers.com

**Michael McNeight**  
+1 208 472 2865  
michael.mcneight@colliers.com

755 West Front Street, Suite 300  
Boise, Idaho 83702  
208 345 9000  
colliers.com/idaho

1415 Lauren Lane  
Caldwell, Idaho 83605

### Highlights:

- Functional floor plan and high end office finishes
- Ideally located within Sky Ranch Business Park
- 18' clear height in warehouse

This document has been prepared by Colliers for advertising and general information only. Colliers makes no guarantees, representations or warranties of any kind, expressed or implied, regarding the information including, but not limited to, warranties of content, accuracy and reliability. Any interested party should undertake their own inquiries as to the accuracy of the information. Colliers excludes unequivocally all inferred or implied terms, conditions and warranties arising out of this document and excludes all liability for loss and damages arising there from. This publication is the copyrighted property of Colliers and /or its licensor(s). © 2026. All rights reserved. This communication is not intended to cause or induce breach of an existing listing agreement. Colliers Treasure Valley, LLC.

# For Lease

## Property Information

<b>Property Type</b>	Industrial
<b>Total Building Size</b>	5,000 SF
<b>Zoning</b>	Light Industrial
<b>Ceiling Height</b>	18'
<b>Grade Level Drive-In Doors</b>	16' x 14'
<b>Lease Rate</b>	Contact Agent
<b>NNN Est.</b>	\$0.32 PSF



## Site Plan

Business Park Entrance

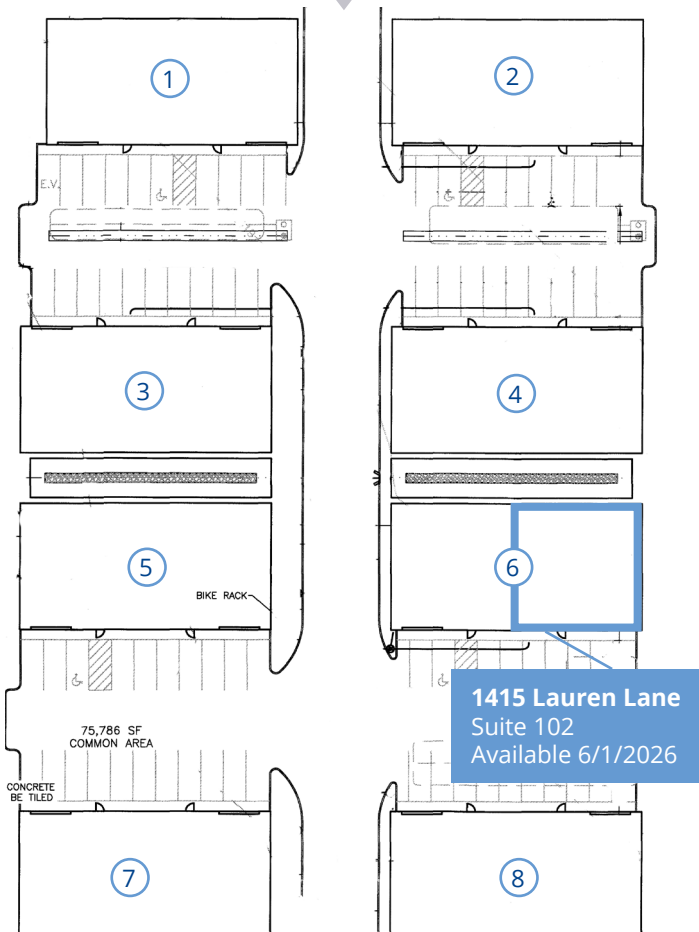

1415 Lauren Lane  
Suite 102  
Available 6/1/2026

## Space Available

Building	Suite	Size	Rate
6	102	2,500 SF	Contact Agent

## Floor Plan

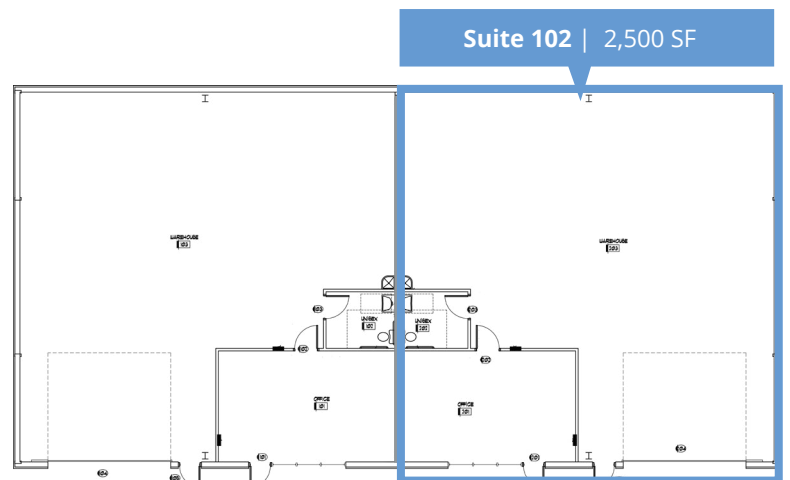

# Location

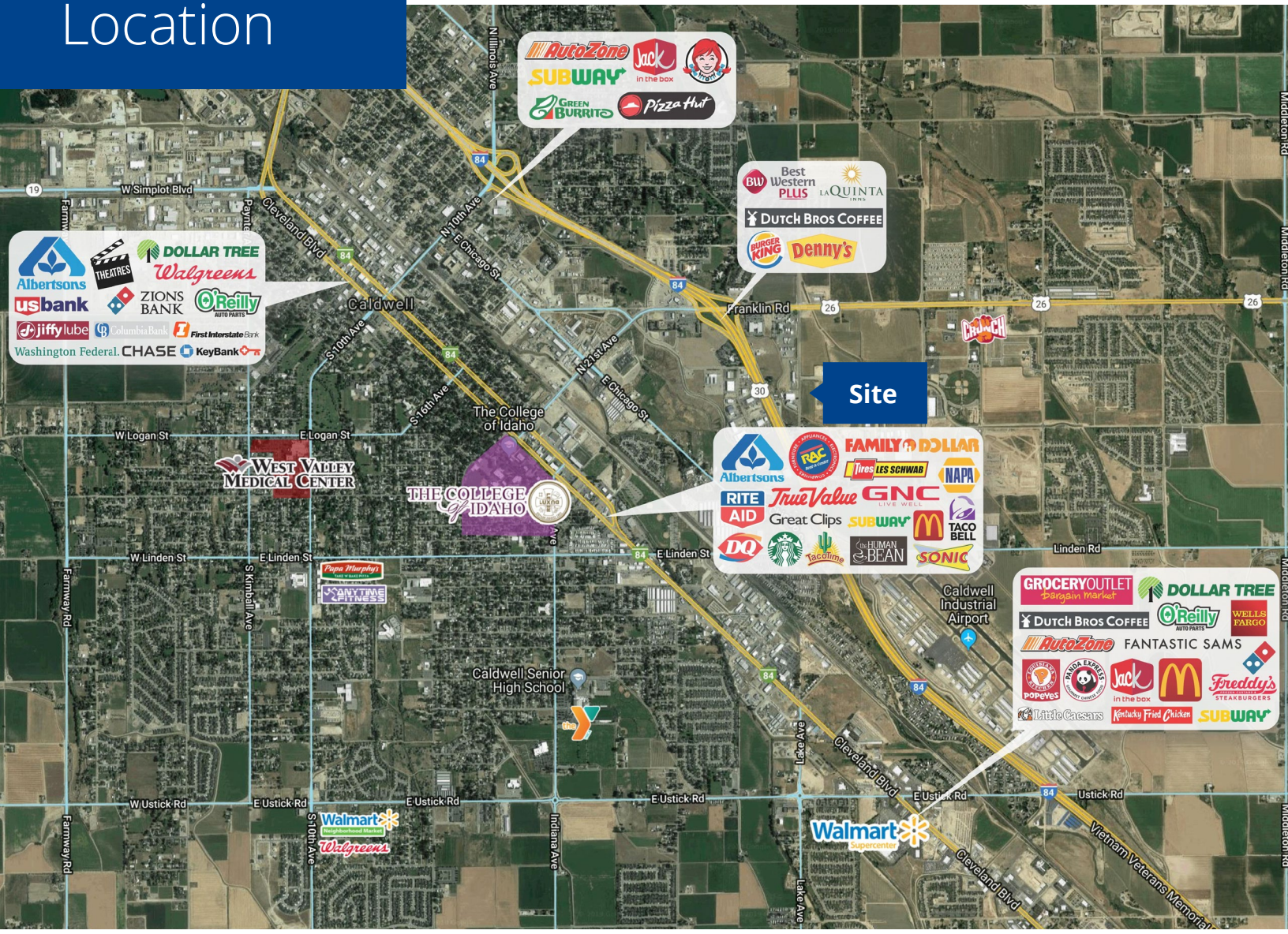

755 West Front Street, Suite 300  
 Boise, Idaho 83702  
 +1 208 345 9000  
 colliers.com/idaho