



KING
Commercial Real Estate

FOR LEASE

124 Molalla Ave, Suite A, Oregon City, OR 97045



Bradley King
Licensed Broker | OR & WA
503.313.8262
King@KWcommercial.com

Ethan Suk
Licensed Broker | OR
503.791.1986
Ethan@KWcommercial.com



COMMERCIALSM

Property Highlights



Property Overview

124 Molalla Ave, Suite A is approximately 1,180 SF as an endcap suite. Located in one of Oregon City's most active commercial corridors. Suite offers, unmatched street level exposure and situated right next to Plaid Pantry. Pylon Signage opportunity for tenant to capture the attention of over 15,000 daily commuters.

Offering Summary

LEASE RATE:	Call for Rate
AVAILABLE SF:	1,180 SF
PARKING STALLS:	16
ZONING:	MUC1



Suite A: Floor Plan

TOTAL SF: 1,180

& Ariel Lot View

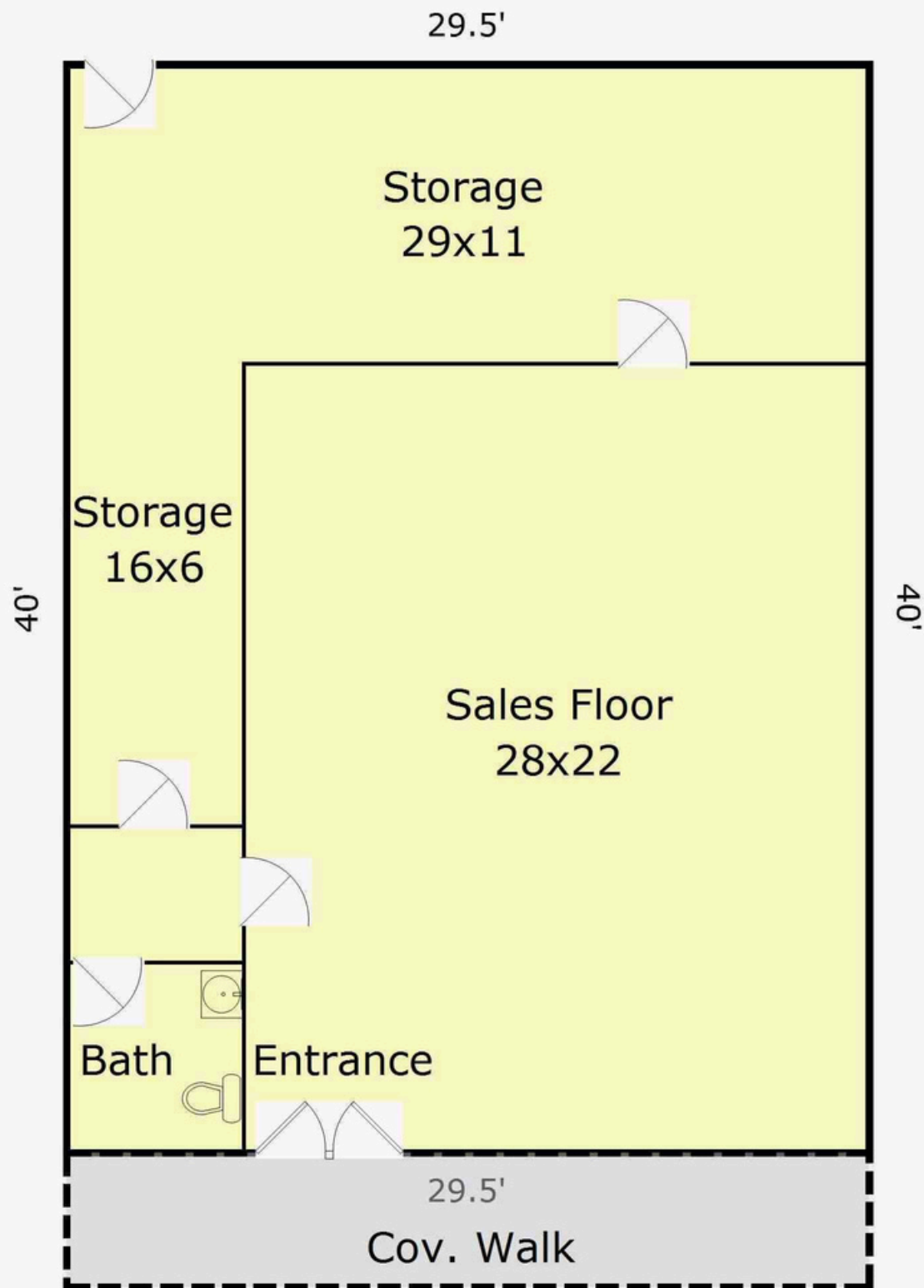



Subject Property



Singer Creek



MAJOR BUSINESSES 0.3 MILE RADIUS

Creek Park

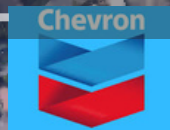
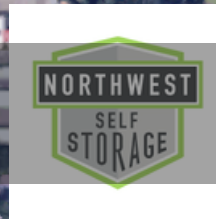



KING
Commercial Real Estate

MAJOR EMPLOYERS IN THE REGION

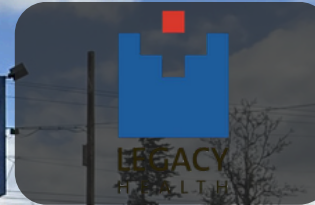

The Portland metropolitan area features a diverse and dynamic economy, with major employers spanning healthcare, athletic apparel, financial services, education, and technology. This diversity helps provide economic resilience and a wide range of career opportunities for residents.