



Long Valley Village

Neighborhood Shopping Center

62 East Mill Road (Route 24)

Long Valley, Morris County, NJ 07853

PROPERTY DESCRIPTION

Situated on a 5 acre site with 461' of road frontage, Long Valley Village consists of three, single-story buildings in a "U" configuration totaling 29,600 square feet. The center was built to "lifestyle center" specifications to maintain the immediate area's colonial-style architecture. Easily accessible from Rt. 24 with two entry/exits.

AVAILABLE SPACE

Unit 9: 5,328 SF (Former Gym & Divisible)

RENTAL RATES

Upon request, subject to use and creditworthiness

CAM & REAL ESTATE TAXES

\$9.90 psf projected 2026

TRAFFIC COUNT

ADT 15,000 along Route 24

PARKING

On-site parking for 180 cars

COMMENTS

- Ideal uses include, fitness, day care, wellness, specialty health services, education & Pet supplies;
- Along the major Morris County east-west corridor of Route 24 (County 513). 3 miles west of affluent Chester Township.

FOR ADDITIONAL INFORMATION CONTACT EXCLUSIVE LEASING AGENT

Joel Tomlinson

Asst. VP – Brokerage Department

jtomlinson@silbertrealestate.com

908-604-6900 x108

SILBERT

REALTY & MANAGEMENT COMPANY, INC.

152 Liberty Corner Road
Suite 203
Warren, NJ 07059

Linked in



Visit Our Website: WWW.SilbertRealEstate.com

Leasing Plan

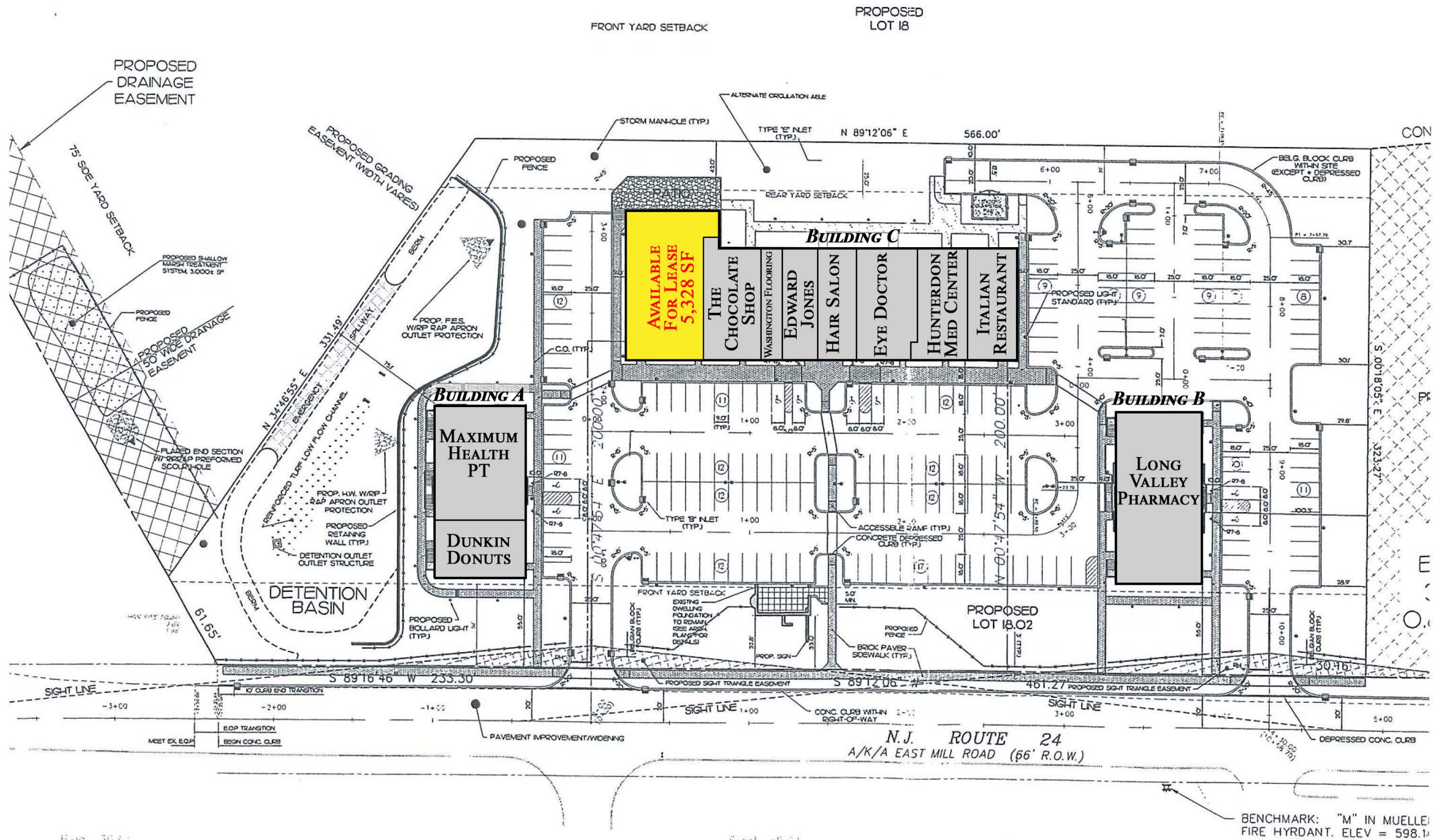

Immediate Aerial



AREA DEMOGRAPHICS

3 Mile Radius

Population	11,541
Average HH Income	\$246,139
Median HH Income	\$184,632
Total Households	3,874
Median Age	43.6
Daytime Population	6,220

5 Mile Radius

Population	38,777
Average HH Income	\$198,051
Median HH Income	\$156,382
Total Households	14,012
Median Age	42.2
Daytime Population	25,881

7 Mile Radius

Population	84,325
Average HH Income	\$183,774
Median HH Income	\$146,542
Total Households	31,081
Median Age	41.3
Daytime Population	49,967

