



TO LET

TOWN CENTRE RETAIL PREMISES

Prime pedestrianised town
centre location

Entire Property - 3,108.5 sq. m.
(33,461 sq. ft.)

Sub-division options available –
see below

Unit 4A – 1,792.9 sq. m. (19,299
sq. ft.)

Unit 4B – 974.8 sq. m. (10,493 sq.
ft.)

Rent Upon Application



VIDEO TOUR



WHAT 3 WORDS

UNIT 4, 127 HIGH STREET, AYR, KA7 1QW

CONTACT: Kevin N Bell BSc MRICS | kevin.bell@shepherd.co.uk | 01292 267987 |
shepherd.co.uk





Location

UNIT 4, 127 HIGH STREET, AYR

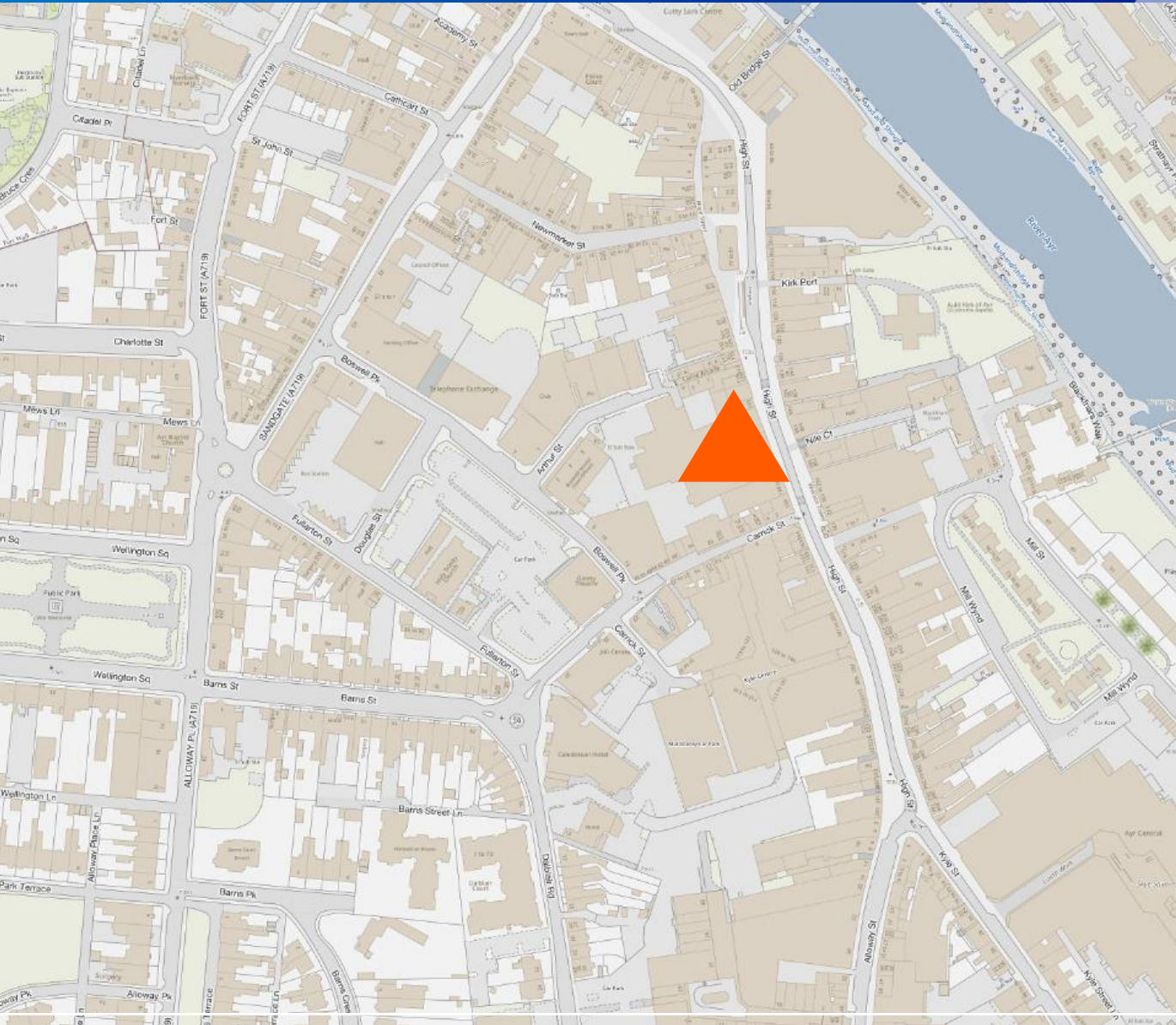

Ayr is the principal settlement in the South Ayrshire Council area with a resident population of around 46,800.

The premises are located in a prime position on the town's pedestrianised High Street.

Nearby occupiers include Boots, Tesco Express, Iceland and Waterstones.

Private off street car parking is available via Arthur Street.

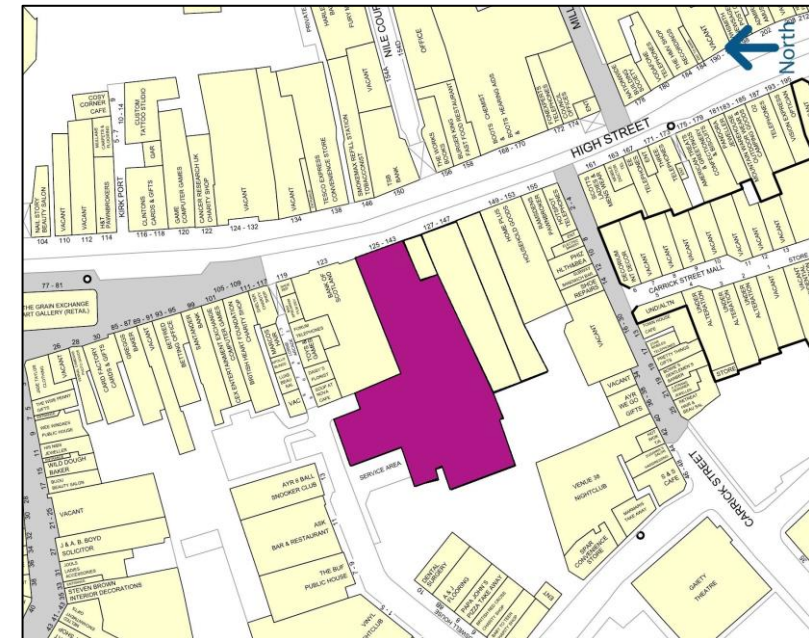

FIND ON GOOGLE MAPS



Description

UNIT 4, 127 HIGH STREET, AYR

The subjects comprise a substantial department store with large retail area at ground floor level with ancillary staff and storage accommodation on the upper floors of the building.

The entire floor area is as follows:

	m ²	ft ²
Ground	1,830.87	19,708
First	1,082.97	11,765
Second	184.69	1,988
Total	3,108.53	33,461

The above floor areas have been calculated on a Net Internal Area basis in accordance with the RICS Code of Measuring Practice (6th Edition).

As illustrated opposite our clients may consider subdividing the property into units of the following size:

Unit 4A	
Ground Floor –	1,260.0 sq. m. (13,562 sq. ft.)
First Floor –	532.9 sq. .m (5,737 sq. ft.)
Total -	1,792 sq. m. (19,299 sq. ft.)

Unit 4B	
Ground Floor –	525.0 sq. m. (5,651 sq. ft.)
First Floor –	449.8 sq. m. (4,842 sq. ft.)
Total –	974.8 sq. m. (10,493 sq. ft.)

Unit A is shaded blue and Unit B pink on the Plan opposite.

Our clients may consider other sub-division options, further information available upon request.

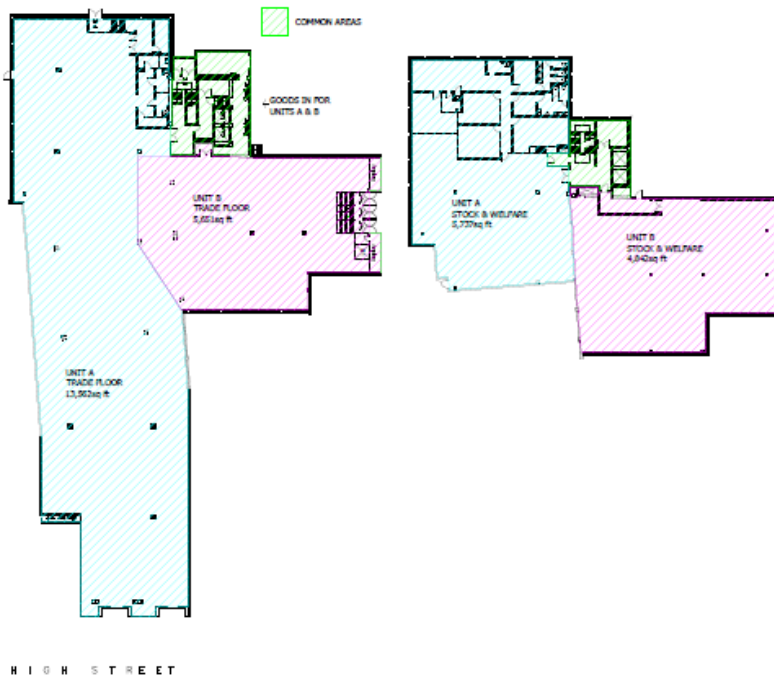

Prepared for the client of
gs Consulting

APPROVED FOR THE CLIENT BY THE CONSULTANT
THE CONSULTANT HAS CONDUCTED VISUAL SURVEYS AND MEASUREMENTS
AND HAS TAKEN REASONABLE CARE TO OBTAIN ACCURATE INFORMATION
AND TO REPORT THE SAME TO THE CLIENT'S BEST KNOWLEDGE AND BELIEF.

DO NOT SCALE THIS DRAWING IN DOCUMENT FORM.

GENERAL NOTES

NO. DATE DESCRIPTION BY

1 11/2024

2 11/2024

3 11/2024

4 11/2024

5 11/2024

6 11/2024

7 11/2024

8 11/2024

9 11/2024

10 11/2024

11 11/2024

12 11/2024

13 11/2024

14 11/2024

15 11/2024

16 11/2024

17 11/2024

18 11/2024

19 11/2024

20 11/2024

21 11/2024

22 11/2024

23 11/2024

24 11/2024

25 11/2024

26 11/2024

27 11/2024

28 11/2024

29 11/2024

30 11/2024

31 11/2024

32 11/2024

33 11/2024

34 11/2024

35 11/2024

36 11/2024

37 11/2024

38 11/2024

39 11/2024

40 11/2024

41 11/2024

42 11/2024

43 11/2024

44 11/2024

45 11/2024

46 11/2024

47 11/2024

48 11/2024

49 11/2024

50 11/2024

51 11/2024

52 11/2024

53 11/2024

54 11/2024

55 11/2024

56 11/2024

57 11/2024

58 11/2024

59 11/2024

60 11/2024

61 11/2024

62 11/2024

63 11/2024

64 11/2024

65 11/2024

66 11/2024

67 11/2024

68 11/2024

69 11/2024

70 11/2024

71 11/2024

72 11/2024

73 11/2024

74 11/2024

75 11/2024

76 11/2024

77 11/2024

78 11/2024

79 11/2024

80 11/2024

81 11/2024

82 11/2024

83 11/2024

84 11/2024

85 11/2024

86 11/2024

87 11/2024

88 11/2024

89 11/2024

90 11/2024

91 11/2024

92 11/2024

93 11/2024

94 11/2024

95 11/2024

96 11/2024

97 11/2024

98 11/2024

99 11/2024

100 11/2024

101 11/2024

102 11/2024

103 11/2024

104 11/2024

105 11/2024

106 11/2024

107 11/2024

108 11/2024

109 11/2024

110 11/2024

111 11/2024

112 11/2024

113 11/2024

114 11/2024

115 11/2024

116 11/2024

117 11/2024

118 11/2024

119 11/2024

120 11/2024

121 11/2024

122 11/2024

123 11/2024

124 11/2024

125 11/2024

126 11/2024

127 11/2024

128 11/2024

129 11/2024

130 11/2024

131 11/2024

132 11/2024

133 11/2024

134 11/2024

135 11/2024

136 11/2024

137 11/2024

138 11/2024

139 11/2024

140 11/2024

141 11/2024

142 11/2024

143 11/2024

144 11/2024

145 11/2024

146 11/2024

147 11/2024

148 11/2024

149 11/2024

150 11/2024

151 11/2024

152 11/2024

153 11/2024

154 11/2024

155 11/2024

156 11/2024

157 11/2024

158 11/2024

159 11/2024

160 11/2024

161 11/2024

162 11/2024

163 11/2024

164 11/2024

165 11/2024

166 11/2024

167 11/2024

168 11/2024

169 11/2024

170 11/2024

171 11/2024

172 11/2024

173 11/2024

174 11/2024

175 11/2024

176 11/2024

177 11/2024

178 11/2024

179 11/2024

180 11/2024

181 11/2024

182 11/2024

183 11/2024

184 11/2024

185 11/2024

186 11/2024

187 11/2024

188 11/2024

189 11/2024

190 11/2024

191 11/2024

192 11/2024

193 11/2024

194 11/2024

195 11/2024

196 11/2024

197 11/2024

198 11/2024

199 11/2024

200 11/2024

201 11/2024

202 11/2024

203 11/2024

204 11/2024

205 11/2024

206 11/2024

207 11/2024

208 11/2024

209 11/2024

210 11/2024

211 11/2024

212 11/2024

213 11/2024

214 11/2024

215 11/2024

216 11/2024

217 11/2024

218 11/2024

219 11/2024

220 11/2024

221 11/2024

222 11/2024

223 11/2024

224 11/2024

225 11/2024

226 11/2024

227 11/2024

228 11/2024

229 11/2024

230 11/2024

231 11/2024

232 11/2024

233 11/2024

234 11/2024

235 11/2024

236 11/2024

237 11/2024

238 11/2024

239 11/2024

240 11/2024

241 11/2024

242 11/2024

243 11/2024

244 11/2024

245 11/2024

246 11/2024

247 11/2024

248 11/2024

249 11/2024

250 11/2024

251 11/2024

252 11/2024

253 11/2024

254 11/2024

255 11/2024

256 11/2024

257 11/2024

258 11/2024

259 11/2024

260 11/2024

261 11/2024

262 11/2024

263 11/2024

264 11/2024

265 11/2024

266 11/2024

267 11/2024

268 11/2024

269 11/2024

270 11/2024

271 11/2024

272 11/2024

273 11/2024

274 11/2024

275 11/2024

276 11/2024

277 11/2024

278 11/2024

279 11/2024

280 11/2024

281 11/2024

282 11/2024

283 11/2024

284 11/2024

285 11/2024

286 11/2024

287 11/2024

288 11/2024

289 11/2024

290 11/2024

291 11/2024

292 11/2024

293 11/2024

294 11/2024

295 11/2024

296 11/2024

297 11/2024

298 11/2024

299 11/2024

300 11/2024

301 11/2024

302 11/2024

303 11/2024

304 11/2024

305 11/2024

306 11/2024

307 11/2024

308 11/2024

309 11/2024

310 11/2024

311 11/2024

312 11/2024

313 11/2024

314 11/2024

315 11/2024

316 11/2024

317 11/2024

318 11/2024

319 11/2024

320 11/2024

321 11/2024

322 11/2024

323 11/2024

324 11/2024

325 11/2024

326 11/2024

327 11/2024

328 11/2024

329 11/2024

330 11/2024

331 11/2024

332 11/2024

333 11/2024

334 11/2024

335 11/2024

336 11/2024

337 11/2024

338 11/2024

339 11/2024

340 11/2024

341 11/2024

342 11/2024

343 11/2024

344 11/2024

345 11/2024

346 11/2024

347 11/2024

348 11/2024

349 11/2024

350 11/2024

351 11/2024

352 11/2024

353 11/2024

354 11/2024

355 11/2024

356 11/2024

357 11/2024

358 11/2024

359 11/2024

360 11/2024

361 11/2024

362 11/2024

363 11/2024

364 11/2024

365 11/2024

366 11/2024

367 11/2024

368 11/2024

369 11/2024

370 11/2024

371 11/2024

372 11/2024

373 11/2024

374 11/2024

375 11/2024

376 11/2024

377 11/2024

378 11/2024

379 11/2024

380 11/2024

381 11/2024

382 11/2024

383 11/2024

384 11/2024

385 11/2024

386 11/2024

387 11/2024

388 11/2024

389 11/2024

390 11/2024

391 11/2024

392 11/2024

393 11/2024

394 11/2024

395 11/2024

396 11/2024

397 11/2024

398 11/2024

399 11/2024

400 11/2024

401 11/2024

402 11/2024

403 11/2024

404 11/2024

405 11/2024

406 11/2024

407 11/2024

408 11/2024

409 11/2024

410 11/2024

411 11/2024

412 11/2024

413 11/2024

414 11/2024

415 11/2024

416 11/2024

417 11/2024

418 11/2024

419 11/2024

420 11/2024

421 11/2024

422 11/2024

423 11/2024

424 11/2024

425 11/2024

426 11/2024

427 11/2024

428 11/2024

429 11/2024

430 11/2024

431 11/2024

432 11/2024

433 11/2024

434 11/2024

435 11/2024

436 11/2024

437 11/2024

438 11/2024

439 11/2024

440 11/2024

441 11/2024

442 11/2024

443 11/2024

444 11/2024

445 11/2024

446 11/2024

447 11/2024

448 11/2024

449 11/2024

450 11/2024

451 11/2024

452 11/2024

453 11/2024

454 11/2024

455 11/2024

456 11/2024

457 11/2024

458 11/2024

459 11/2024

460 11/2024

461 11/2024

462 11/2024

463 11/2024

464 11/2024

465 11/2024

466 11/2024

467 11/2024

468 11/2024

469 11/2024

470 11/2024

471 11/2024

472 11/2024

473 11/2024

474 11/2024

475 11/2024

476 11/2024

477 11/2024

478 11/2024

479 11/2024

480 11/2024

481 11/2024

482 11/2024

483 11/2024

484 11/2024

485 11/2024

486 11/2024

487 11/2024

488 11/2024

489 11/2024

490 11/2024

491 11/2024

492 11/2024

493 11/2024

494 11/2024

495 11/2024

496 11/2024

497 11/2024

498 11/2024

499 11/2024

500 11/2024

501 11/2024

502 11/2024

503 11/2024

504 11/2024

505 11/2024

506 11/2024

507 11/2024

508 11/2024

509 11/2024

510 11/2024

511 11/2024

512 11/2024

513 11/2024

514 11/2024

515 11/2024

516 11/2024

517 11/2024

518 11/2024

519 11/2024

520 11/2024

521 11/2024

522 11/2024

523 11/2024

524 11/2024

525 11/2024

526 11/2024

527 11/2024

528 11/2024

529 11/2024

530 11/2024

531 11/2024

532 11/2024

533 11/2024

534 11/2024

535 11/2024

536 11/2024

537 11/2024

538 11/2024

539 11/2024

540 11/2024

541 11/2024

542 11/2024

543 11/2024

544 11/2024

545 11/2024

546 11/2024

547 11/2024

548 11/2024

549 11/2024

550 11/2024

551 11/2024

552 11/2024

553 11/2024

554 11/2024

555 11/2024

556 11/2024

557 11/2024

558 11/2024

559 11/2024

560 11/2024

561 11/2024

562 11/2024

563 11/2024

564 11/2024

565 11/2024

566 11/2024

567 11/2024

568 11/2024

569 11/2024

570 11/2024

571 11/2024

572 11/2024

573 11/2024

574 11/2024

575 11/2024

576 11/2024

577 11/2024

578 11/2024

579 11/2024

580 11/2024

581 11/2024

582 11/2024

583 11/2024

584 11/2024

585 11/2024

586 11/2024

587 11/2024

588 11/2024

589 11/2024

590 11/2024

591 11/2024

592 11/2024

593 11/2024

594 11/2024

595 11/2024

596 11/2024

597 11/2024

598 11/2024

599 11/2024

600 11/2024

601 11/2024

602 11/2024

603 11/2024

604 11/2024

605 11/2024

606 11/2024

607 11/2024

608 11/2024

609 11/2024

610 11/2024

611 11/2024

612 11/2024

613 11/2024

614 11/2024

615 11/2024

616 11/2024

617 11/2024

618 11/2024

619 11/2024

620 11/2024

621 11/2024

622 11/2024

623 11/2024

624 11/2024

625 11/2024

626 11/2024

627 11/2024

628 11/2024

629 11/2024

630 11/2024

631 11/2024

632 11/2024

633 11/2024

634 11/2024

635 11/2024

636 11/2024

637 11/2024

638 11/2024

639 11/2024

640 11/2024

641 11/2024

642 11/2024

643 11/2024

644 11/2024

645 11/2024

646 11/2024

647 11/2024

648 11/2024

649 11/2024

650 11/2024

651 11/2024

652 11/2024

653 11/2024

654 11/2024

655 11/2024



Rental

Upon application.

Lease Terms

The property is available on a new Full Repairing and Insuring lease for a term to be agreed, subject to five-yearly upward only rent reviews.

Rateable Value

The property is currently entered in the Valuation Roll as follows:

RV £114,000

Upon sub-division the rateable value will require to be re-assessed.

Energy Performance Certificate

The property has a current energy rating of D.

A copy of the EPC is available upon request.

VAT

All prices, rents and premiums, where quoted, are exclusive of VAT.

Prospective purchasers/lessees are advised to satisfy themselves independently as to the incident of Value Added Tax in respect of this transaction.

Legal Costs

Each party will be responsible for their own legal costs incurred in the transaction with the tenant being responsible for tax and registration dues in the normal fashion.



Entrance Unit 4A



Entrance Unit 4B

J & E Shepherd for themselves and for the vendors or lessors of this property whose agents they are, give notice that: (i) the particulars and plan are set out as a general outline for the guidance of intending purchasers or lessees, and do not constitute, nor constitute part of, an offer or contract (ii) all descriptions, dimensions, references to condition and necessary permissions for use and occupation, and other details are given in good faith and are believed to be correct at the date of first issue but any intending purchasers or tenants should not rely on them as statements or representations of fact but must satisfy themselves by inspection or otherwise as to the correctness of each of them; (iii) no person in the employment of J & E Shepherd has any authority to make or give any representation or warranty whatever in relation to this property; (iv) all prices and rentals are quoted exclusive of VAT unless otherwise stated. Prospective purchasers/lessees must satisfy themselves independently as to the incidence of VAT in respect of any transaction. **PUBLICATION DATE January 2025**

Get in Touch

For further information or viewing arrangements please contact the joint agents:



Kevin N Bell BSc MRICS
Kevin.bell@shepherd.co.uk

Shepherd Chartered Surveyors
22 Miller Road, Ayr, KA7 2AY
t: 01292 267987 Option 2



Ewan Mackay BSc MRICS
ewan@ewanmackay.co.uk



ANTI MONEY LAUNDERING REGULATIONS

The Money Laundering, Terrorist Financing and Transfer of Funds (Information on the Payer) Regulations 2017 came into force on the 26th June 2017. This now requires us to conduct due diligence not only on our client but also on any purchasers or occupiers. Once an offer has been accepted, the prospective purchaser(s)/occupier(s) will need to provide, as a minimum, proof of identity and residence and proof of funds for the purchase, before the transaction can proceed.

shepherd.co.uk

