

PAD SITES FOR LEASE



Rocky Road and Grand Parkway
Houston, TX 77377

GRAND PARKWAY FRONTAGE PADS AVAILABLE FOR GROUND LEASE. IMMEDIATELY ADJACENT TO THE PLANNED SHOPPING CENTER, THE GRAND AT 249.



THE GRAND
AT 249
SWC

249
TEXAS

THE GRAND
AT 249
NWC

SITE

99
TEXAS

vegō garden



SITE FEATURES

Property Description

- 3 Potential pad sites available surrounding future La-Z-Boy building
- Signalized corner of Rocky Road and Grand Parkway
- Adjacent to new 65-Acre Mixed-Use development, The Grand at 249
- Frontage along Grand Parkway and Rocky Rd.
- Close proximity to residential communities of Tomball, Magnolia, and Spring
- Contact brokers for more information

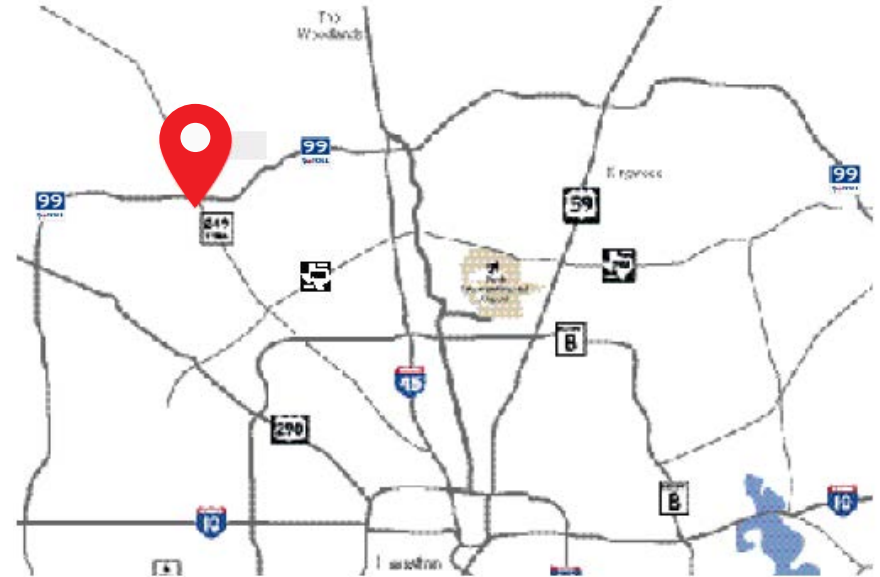

Opportunity Highlights

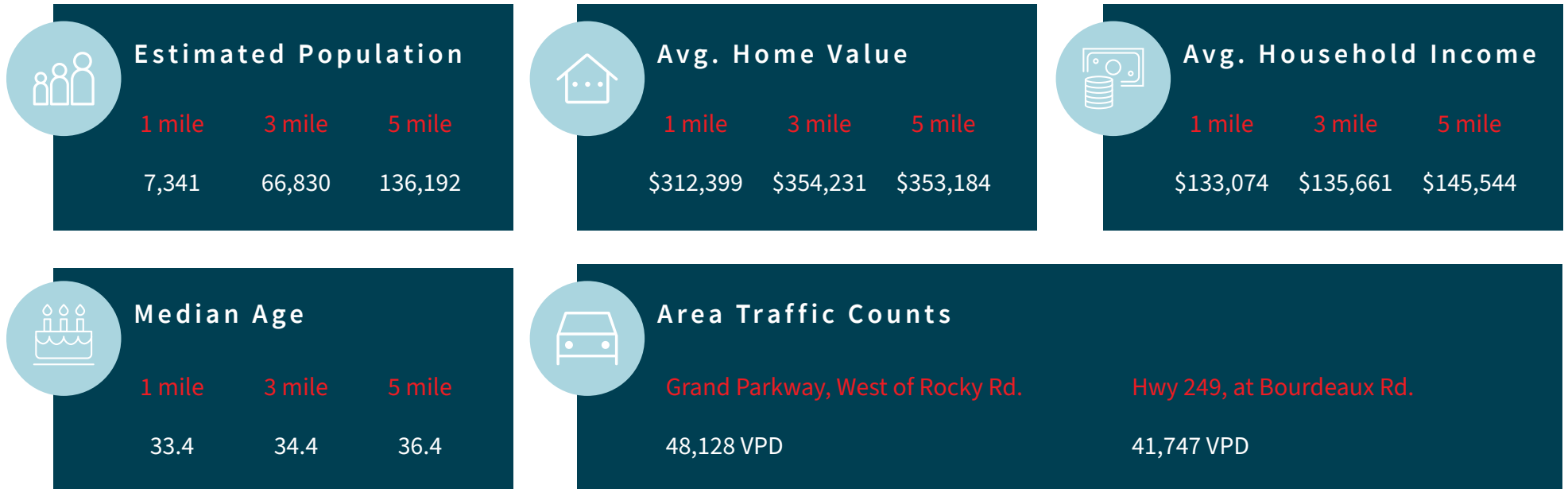

EXCEPTIONAL LOCATION AT INTERSECTING HIGHWAYS, WITH ACCESS TO HOUSTON'S FASTEST GROWING SUBMARKET



THE GRAND AT 249

PROPOSED TENANTS:

Jersey Mike's Subs, Brerly's Grill & Brew, Gringos, AT&T, Bojangles, Carrabba's Italian Grill, Outback Steakhouse, Starbucks, Quick Quack Car Wash, Lupe Texas Hot Tama, Black Bear Diner, Swig, Sephora, Verizon, Michaels, Dick's Sporting Goods, Portillo's, Chipotle Mexican Grill, Wings, Burlington, Dollar Tree, Chick-fil'd, Five Below, Mavis Tires & Brakes, Ross Dress for Less



TRADE AREA AERIAL

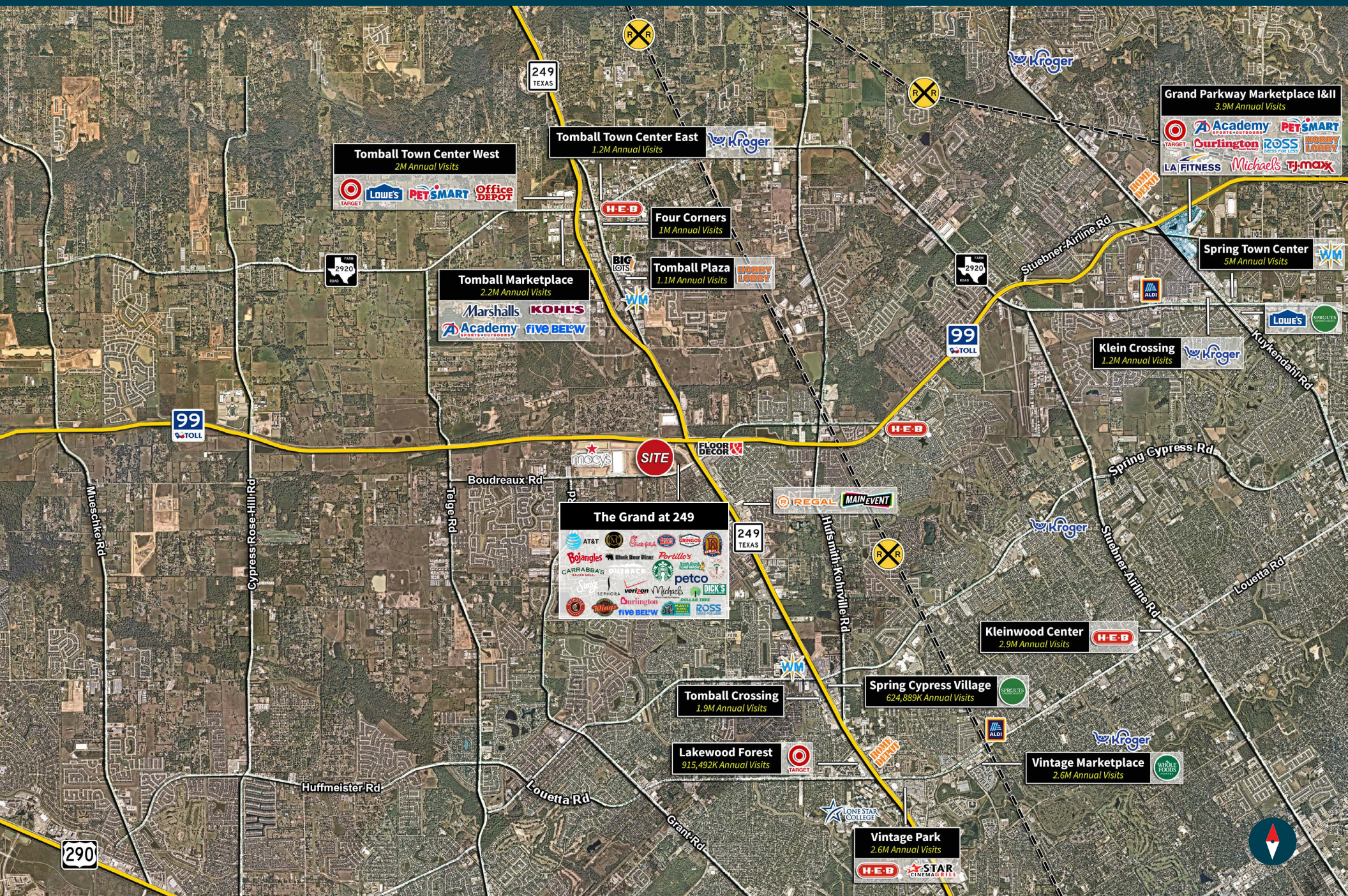

POTENTIAL SITE PLAN

STATE HIGHWAY 99 (GRAND PARKWAY)

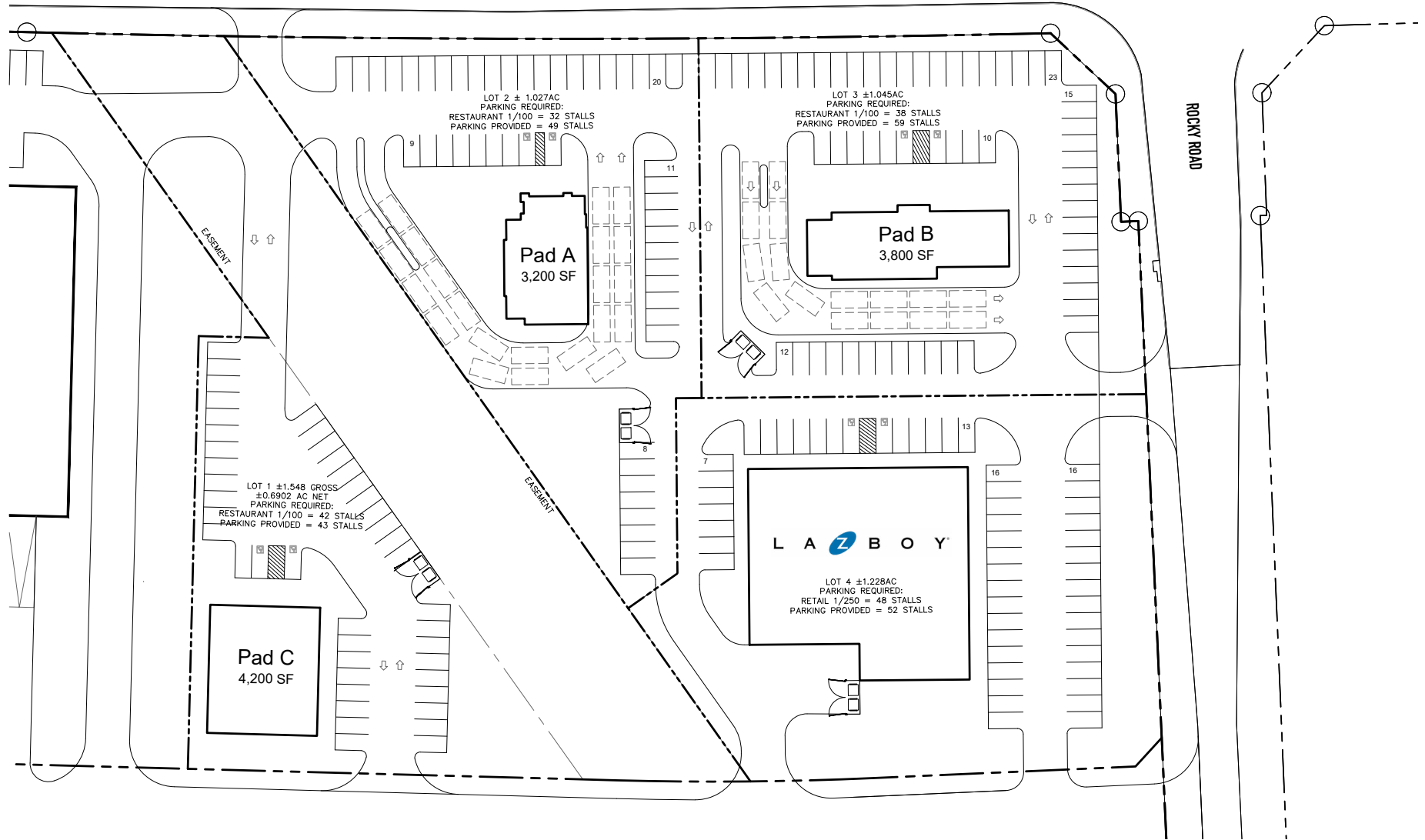

CUASO DESIGN STUDIO
PLANNING • DESIGN • GRAPHICS • ANIMATION

CUASO DESIGN STUDIO IS NOT RESPONSIBLE FOR ANY MODIFICATIONS MADE TO THIS DRAWING BY OTHER PARTIES. DIMENSIONS AND AREAS ON THIS DOCUMENT ARE APPROXIMATE AND SUBJECT TO CHANGE.

Grand Parkway

Houston, TX | June 3, 2024

© Cuaso Design Studio 2018

Conceptual Site Plan 6

SCALE: 1" = 50' | 0' | 50' | 100'

1

POTENTIAL SITE PLAN

STATE HIGHWAY 99 (GRAND PARKWAY)

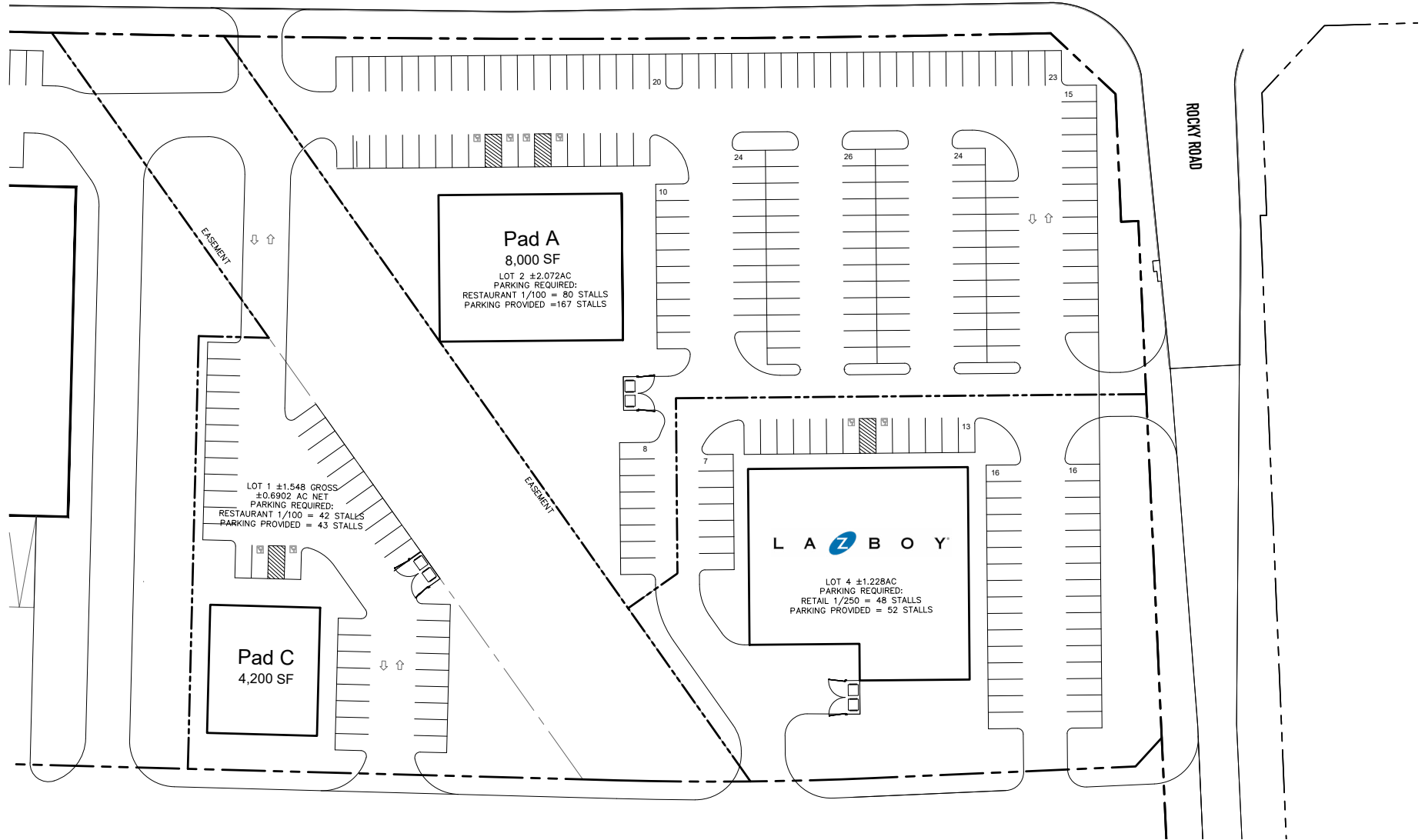

CUASO DESIGN STUDIO
PLANNING • DESIGN • GRAPHICS • ANIMATION

CUASO DESIGN STUDIO IS NOT RESPONSIBLE FOR ANY MODIFICATIONS MADE TO THIS DRAWING BY OTHER PARTIES. DIMENSIONS AND AREAS ON THIS DOCUMENT ARE APPROXIMATE AND SUBJECT TO CHANGE.

Grand Parkway

Houston, TX | June 3, 2024

© Cuaso Design Studio 2018

Conceptual Site Plan 7

SCALE: 1" = 50'

0

50'

100'



1

POTENTIAL SITE PLAN

STATE HIGHWAY 99 (GRAND PARKWAY)



CUASO DESIGN STUDIO
 PLANNING • DESIGN • GRAPHICS • ANIMATION

CUASO DESIGN STUDIO IS NOT RESPONSIBLE FOR ANY MODIFICATIONS MADE TO THIS DRAWING BY OTHER PARTIES. DIMENSIONS AND AREAS ON THIS DOCUMENT ARE APPROXIMATE AND SUBJECT TO CHANGE.

Grand Parkway

Houston, TX | June 3, 2024

© Cuaso Design Studio 2018

Conceptual Site Plan 8

SCALE: 1" = 50' 0' 50' 100'



POTENTIAL SITE PLAN

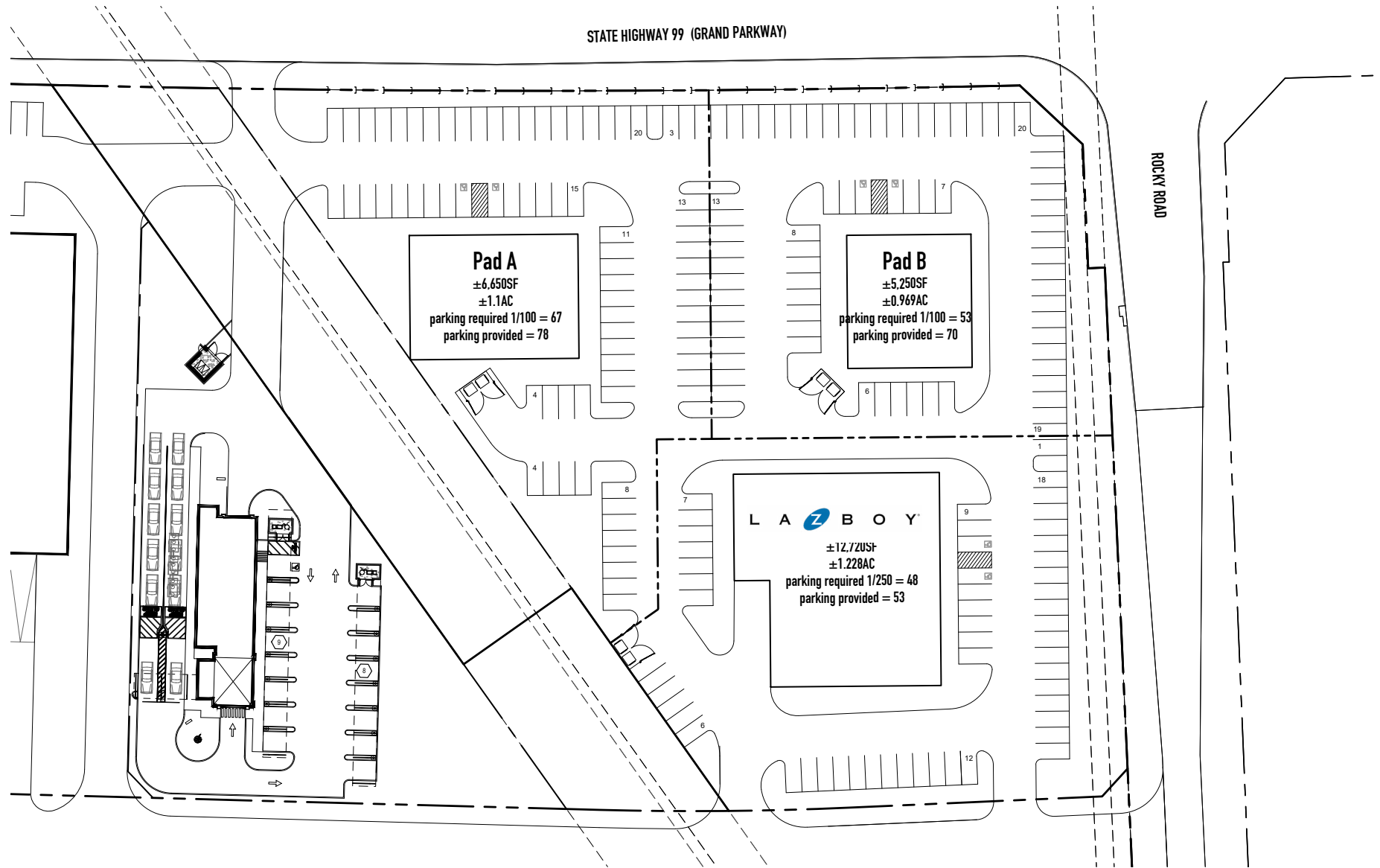

CUASO DESIGN STUDIO
 PLANNING • DESIGN • GRAPHICS • ANIMATION

CUASO DESIGN STUDIO IS NOT RESPONSIBLE FOR ANY MODIFICATIONS MADE TO THIS DRAWING BY OTHER PARTIES. DIMENSIONS AND AREAS ON THIS DOCUMENT ARE APPROXIMATE AND SUBJECT TO CHANGE.

Grand Parkway

Houston, TX | November 10, 2023

© Cuaso Design Studio 2018

Conceptual Site Plan 2

SCALE: 1" = 50'

0 | 50' | 100'



1

CONTACT

Mark Raines

Executive Vice President - Managing Director

+1 713 888 4037

mark.raines@jll.com

Alex Kelly

Vice President

+1 713 425 1863

alexh.kelly@jll.com



Although information has been obtained from sources deemed reliable, JLL does not make any guarantees, warranties or representations, express or implied, as to the completeness or accuracy as to the information contained herein. Any projections, opinions, assumptions or estimates used are for example only. There may be differences between projected and actual results, and those differences may be material. JLL does not accept any liability for any loss or damage suffered by any party resulting from reliance on this information. If the recipient of this information has signed a confidentiality agreement with JLL regarding this matter, this information is subject to the terms of that agreement. ©2024 Jones Lang LaSalle IP, Inc. All rights reserved.