



FOR SUBLEASE

±36,956 SF Industrial Building with Yard

402 N. 37th Dr. Suite 101-102
Phoenix, AZ 85009

Divisible to ±18,478 SF

Sublease Expires April 30, 2028

Chris Reese, SIOR
Vice President
+1 480 748 1834
chris.reese@colliers.com

Colliers
2390 E Camelback Rd, Ste 100
Phoenix, AZ 85016
www.colliers.com/arizona

Accelerating success.

Property Profile

402 N. 37th Dr. Suite 101-102
Phoenix, AZ 85009

Building Area ±36,956 Square Feet (SF)

Divisible To ±18,478 SF

Lot Area ±2.27 Acres (AC)

Cooling Evaporative Cooled Warehouse

Loading 6 Dock High Doors w/ 6 Edge of Dock
2 Grade Level Doors

Clear Height 18'

Zoning Ind-PK, City of Phoenix

Sprinklers Wet

Office 10%

North End ±10,000 SF Fenced Yard

South End ±12,500 SF Shared Fenced Yard



View from South End



View from North End



Large lot with yard space



Convenient access I-10 & I-17



Infill Southwest Phoenix location



Freestanding facility with quality office presence

Freestanding Industrial Building with Yard

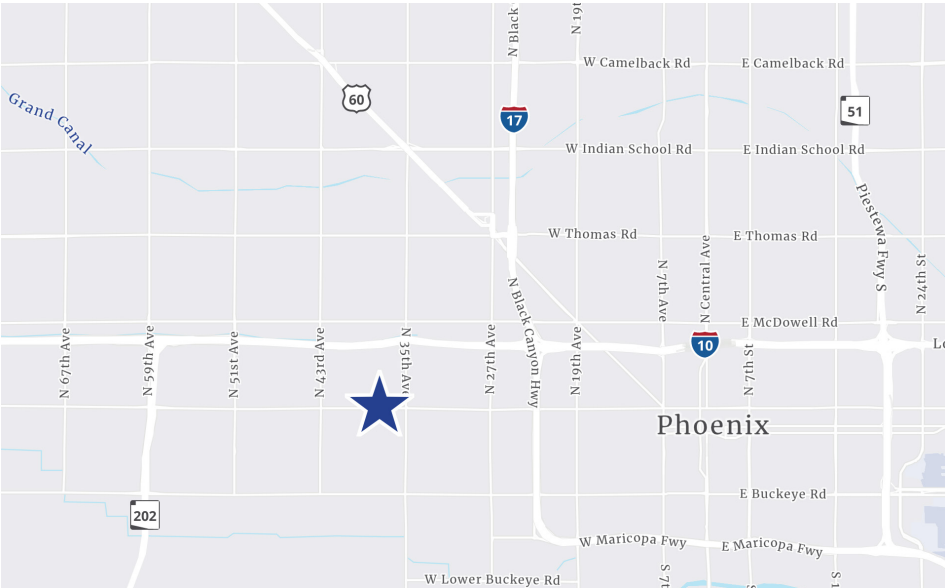

Chris Reese, SIOR
Vice President
+1 480 748 1834
chris.reese@colliers.com

Colliers
2390 E. Camelback Rd, Ste. 100
Phoenix, AZ 85016
colliers.com/arizona

This document has been prepared by Colliers for advertising and general information only. Colliers makes no guarantees, representations or warranties of any kind, expressed or implied, regarding the information including, but not limited to, warranties of content, accuracy and reliability. Any interested party should undertake their own inquiries as to the accuracy of the information. Colliers excludes unequivocally all inferred or implied terms, conditions and warranties arising out of this document and excludes all liability for loss and damages arising there from. This publication is the copyrighted property of Colliers and /or its licensor(s). © 2026. All rights reserved. This communication is not intended to cause or induce breach of an existing listing agreement. Colliers International AZ, LLC.