

## Excellent Location!

- +/-9,090 SF on +/-0.36 Acres
- Strong Visibility & Access Along Wornall Road
- Rare Owner-Occupant Opportunity In Waldo
- Billboard Lease Through 5/31/2033
- Call For Pricing!

## For more information:

Christian Wead  
816.412.8472  
cwead@blockllc.com

Michael R. Block, CPM  
816.932.5549  
mblock@blockllc.com

The information contained in this marketing flyer is presented as general information only. Block Real Estate Services, LLC makes no representation as to its accuracy. This information is not intended as legal, financial or real estate advice and must not be relied upon as such. You should make your own inquiries, obtain independent inspections, and seek professional advice tailored to your specific circumstances before making any legal, financial or real estate decisions.

## Building Specifications

Building Size:	+/- 9,090 SF
Lot Size:	+/- 0.36 AC
Year Built:	1963
Tenancy:	Single or Multi
Occupancy:	Vacant at Closing, Currently Leased to KC P.A.W.S.
Taxes (2025):	\$13,364.72 (\$1.47 PSF)
Zoning:	B3-2
Billboard:	Additional Income Via Billboard Lease Through 5/31/2033
Parking:	Striped Spaces Available to North and West of Property

### For more information:

Christian Wead  
816.412.8472  
cwead@blockllc.com

Michael R. Block, CPM  
816.932.5549  
mblock@blockllc.com

# 7829-7833 Wornall Road

Kansas City, Missouri 64114

# For Sale



**7829-7833 Wornall Rd**

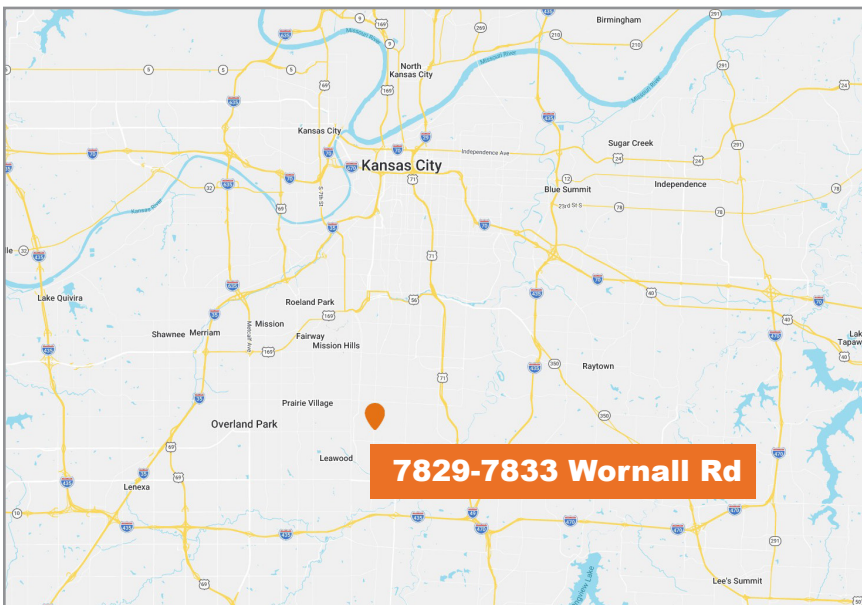

**7829-7833 Wornall Rd**

For more information:

Christian Wead

816.412.8472

[cwead@blockllc.com](mailto:cwead@blockllc.com)

Michael R. Block, CPM

816.932.5549

[mblock@blockllc.com](mailto:mblock@blockllc.com)

4622 Pennsylvania Ave., Suite 700  
Kansas City, MO 64112  
816.756.1400 | [www.BLOCKLLC.com](http://www.BLOCKLLC.com)

**BLOCK**  
REAL ESTATE SERVICES, LLC