

**4120 BILLY MITCHELL DRIVE**  
**ADDISON, TX**  
**24,050 SF**

**DJ DRAPER**

VICE PRESIDENT  
731.819.1008  
ddraper@stoicrep.com

**LANE CORLEY**

ASSOCIATE  
817.269.5399  
lcorley@stoicrep.com

**CHAD ALBERT, SIOR**

FOUNDER & MANAGING PARTNER  
214.287.4251  
calbert@stoicrep.com

# PROPERTY FEATURES



**Total Building Size**  
24,050 SF



**2 Drive-In Ramps**  
**2 Dock Doors**



**Office Space**  
1,950 SF



**Heavy Power**



**Clear Height**  
18 Feet



**100% HVAC**



**Parking Spaces**  
(+/-) 41 Cars Parked

# PROPERTY PHOTOS



# PROPERTY PHOTOS



# OFFICE FLOOR PLAN

1,950 SF

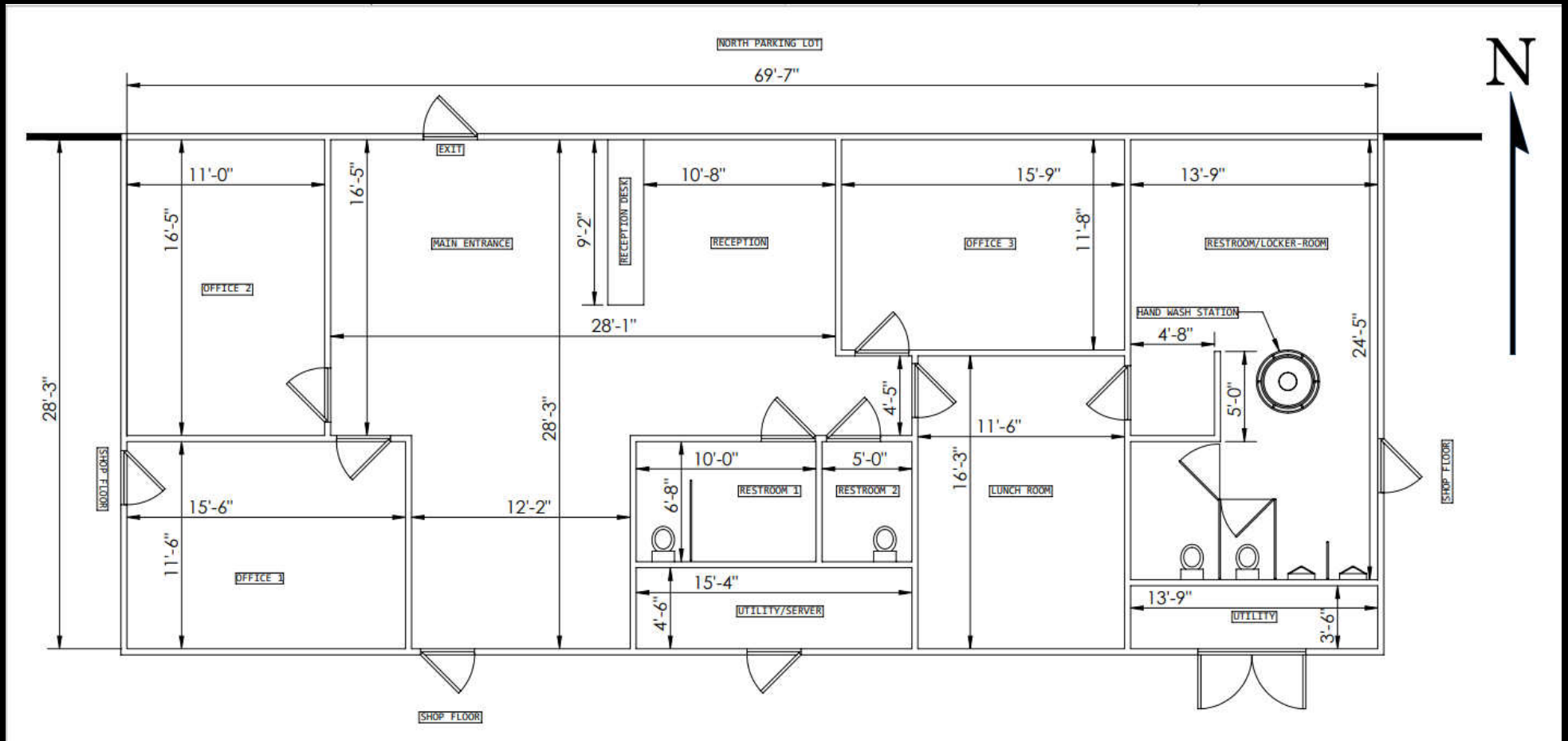

An aerial photograph of an industrial park. A central building is highlighted with a white border. A green callout box with white text points to this building. The surrounding area includes other industrial buildings, parking lots with cars, and some trees.

**4120**

**BILLY MITCHELL DRIVE  
ADDISON, TX**

**BILLY MITCHELL DR**

# PROPERTY SURROUNDINGS

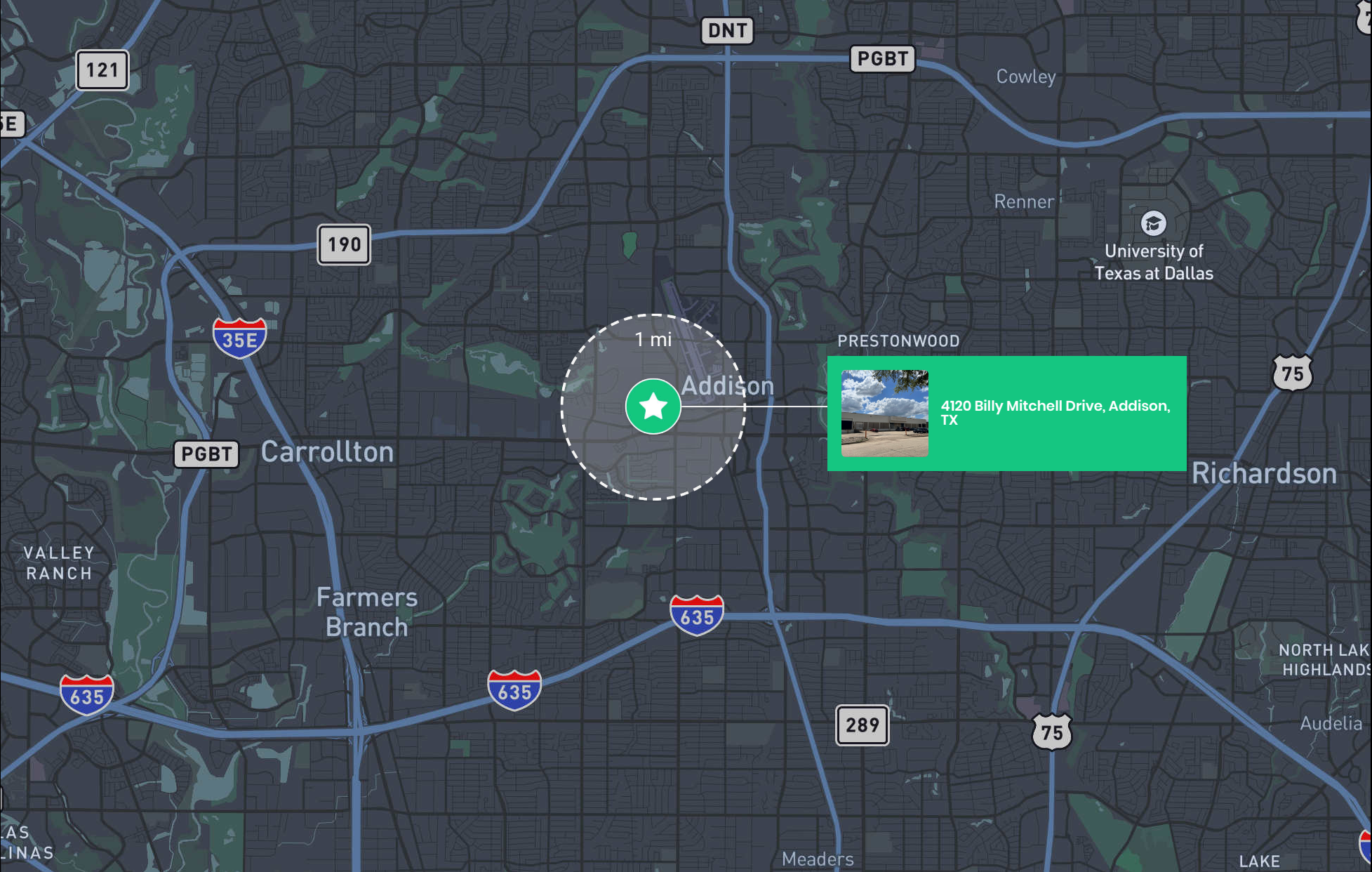

# CONTACT



**DJ DRAPER**  
VICE PRESIDENT  
731.819.1008  
[ddraper@stoicrep.com](mailto:ddraper@stoicrep.com)



**LANE CORLEY**  
ASSOCIATE  
817.269.5399  
[lcorley@stoicrep.com](mailto:lcorley@stoicrep.com)



**CHAD ALBERT, SIOR**  
FOUNDER & MANAGING  
PARTNER  
214.287.4251  
[calbert@stoicrep.com](mailto:calbert@stoicrep.com)

