

RETAIL & OFFICE SPACE AVAILABLE

3105 S SARE RD, BLOOMINGTON, IN 47401

9500 SQ FT | RETAIL • OFFICE • RESTAURANT | HIGH VISIBILITY & TRAFFIC COUNTS | AMPLE PARKING | BRAND NEW IN 2017



3105 S. Sare Rd., Bloomington, IN 47401
(first floor of Porto Flats)

- 9500 Sq. Ft. of Retail / Office space ready for coffee shops, restaurants, or professional service businesses in the Porto Flats buildings at the Verona Park neighborhood
(6000 Sq. Ft. in South building, 3500 Sq. Ft. in North building)
- High visibility and traffic counts from the many neighborhoods, businesses, and commuters along Sare Rd.
- Space can be divided
- Landlord will offer a tenant improvement allowance
- Location is adjacent to S. Sare Rd., just past the East Rogers roundabout on the near South East side of Bloomington, Indiana (across from Sherwood Oaks Christian Church)
- Brand new building in 2017 – customize the space to your needs
- Beautiful outdoor patio space with well-maintained landscaping



PORTO FLATS



1ST FLOOR RETAIL/OFFICE
SPACE AVAILABLE FOR
RESTAURANT, COFFEE SHOP
OR PROFESSIONAL SERVICES

VERONAPARKNEIGHBORHOOD.COM/PORTORETAIL



For more information
CALL CHRIS SMITH
(812) 219-3030



RENAISSANCE RENTALS
WE BUILD COMMUNITY

RETAIL & OFFICE SPACE AVAILABLE

3105 S SARE RD, BLOOMINGTON, IN 47401

9500 SQ FT | RETAIL • OFFICE • RESTAURANT | HIGH VISIBILITY & TRAFFIC COUNTS | AMPLE PARKING | BRAND NEW IN 2017



1st Floor Commercial Space opens onto Community Plaza



Fountain Area in the Community Plaza



Stunning Storefronts with Manicured Landscaping

Schedule Your Tour Today **CALL CHRIS SMITH • (812) 219 - 3030**

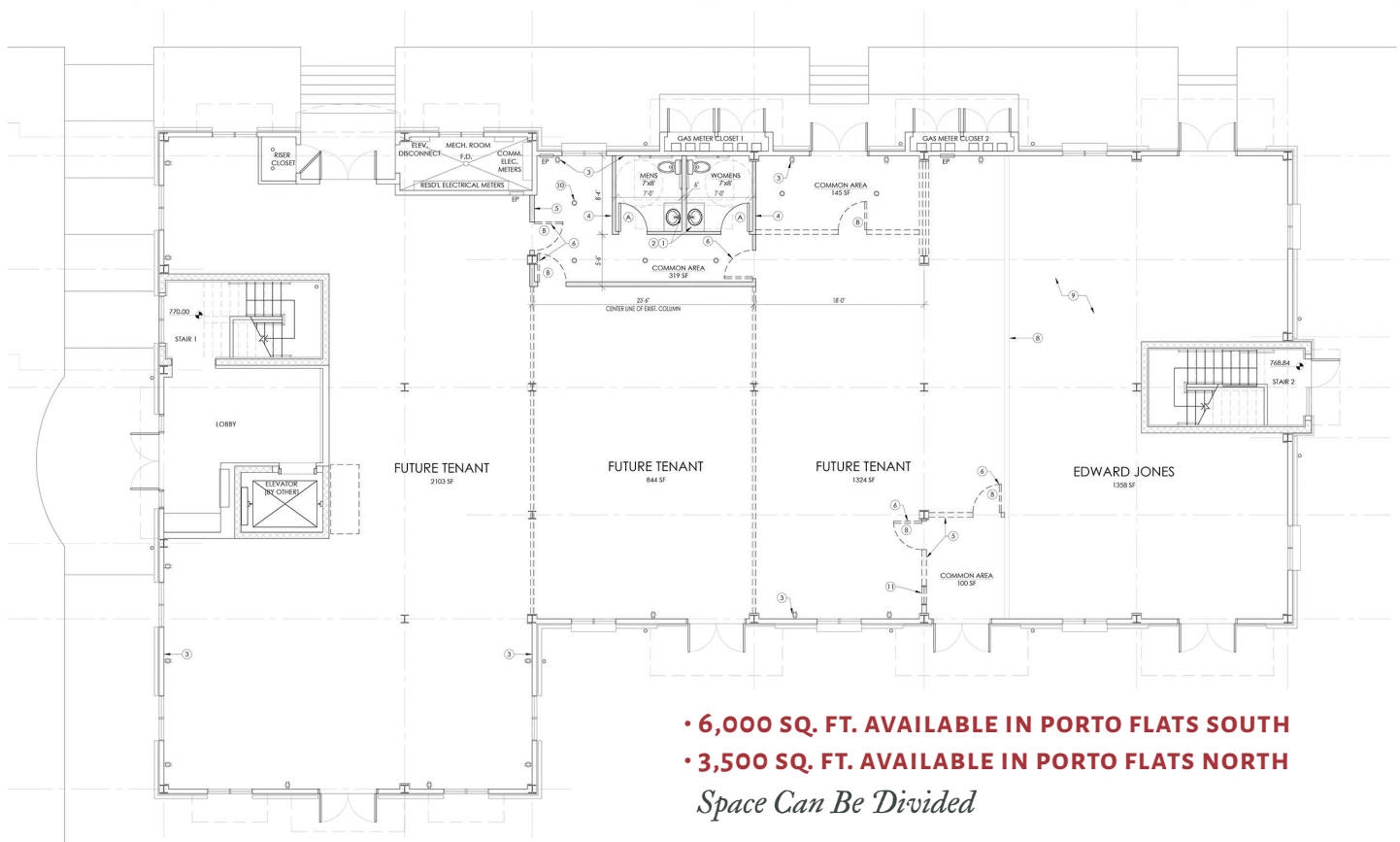

• 6,000 SQ. FT. AVAILABLE IN PORTO FLATS SOUTH
• 3,500 SQ. FT. AVAILABLE IN PORTO FLATS NORTH
Space Can Be Divided

VERONAPARKNEIGHBORHOOD.COM/PORTORETAIL



For more information
CALL CHRIS SMITH
(812) 219-3030

