

Suite #

Suite 100

Occupant Area

27,972 sq. ft.

Area Analysis performed in accordance with ANSI/BOMA Z65.2 - 2019.

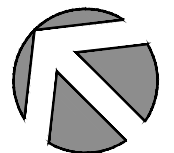

Warehouse
5422 Shilshole Avenue NW
Seattle, WA 98107

Client

Lease Plan

1

Floor

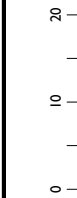

Scale

2DFLOORPLANS.COM
425-677-7511



600 NW Gilman Blvd. Suite E
Issaquah, WA 98027

Measured: May 2020
Project: C20-428

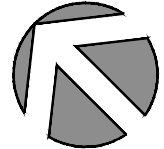
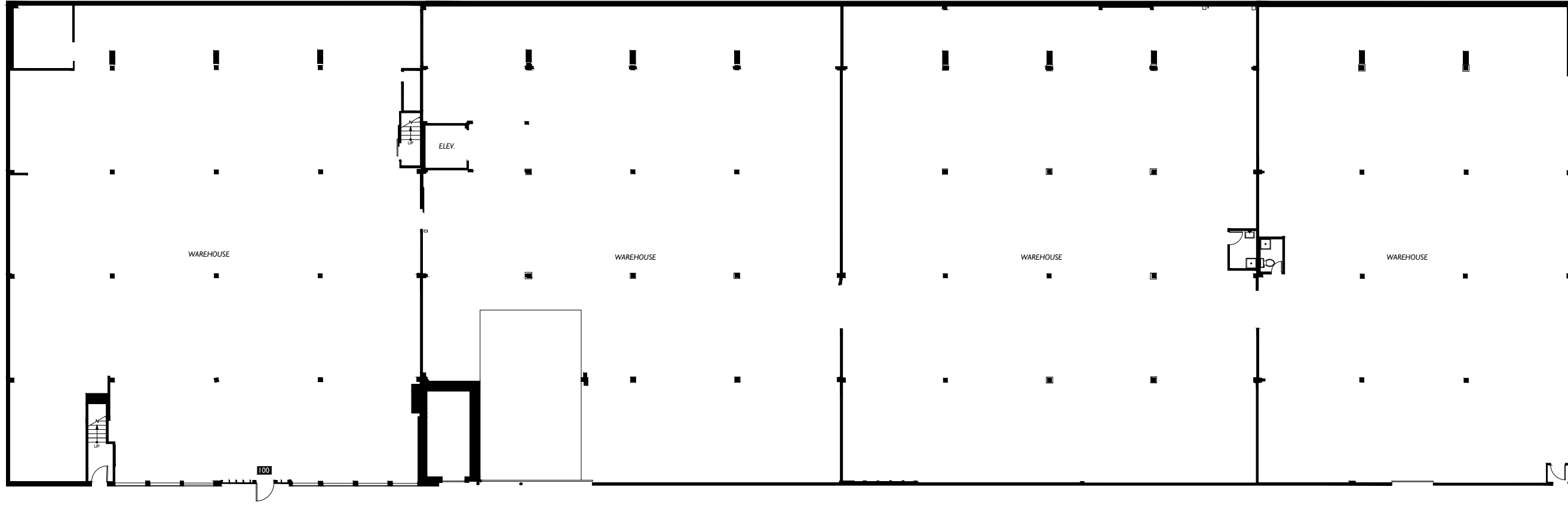

Warehouse
5422 Shilshole Avenue NW
Seattle, WA 98107

Client

Floor Plan

1

Floor

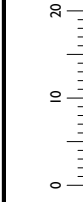

Scale



2DFLOORPLANS.COM
425-677-7511
600 NW Gilman Blvd. Suite E
Issaquah, WA 98027
Measured: May 2020
Project: C20-428

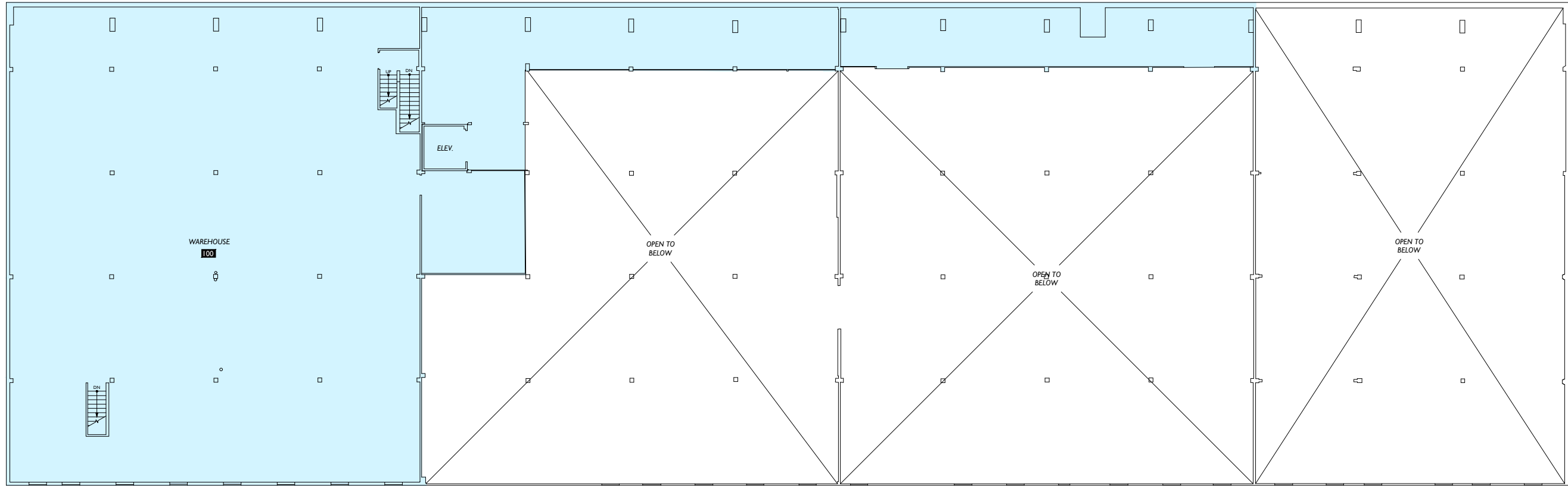

Suite #

Suite 100

Occupant Area

10,281 sq. ft.

Area Analysis performed in accordance with ANSI/BOMA Z65.2 - 2019.

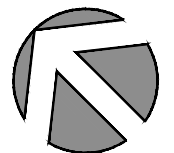

Warehouse
5422 Shilshole Avenue NW
Seattle, WA 98107

Client

Lease Plan

2

Floor

Scale

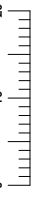

2-D
AS-BUILT
FLOOR PLANS

Measured: May 2020

425-677-7511

2DFLOORPLANS.COM

600 NW Gilman Blvd. Suite E
Issaquah, WA 98027

Project: C20-428

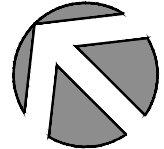
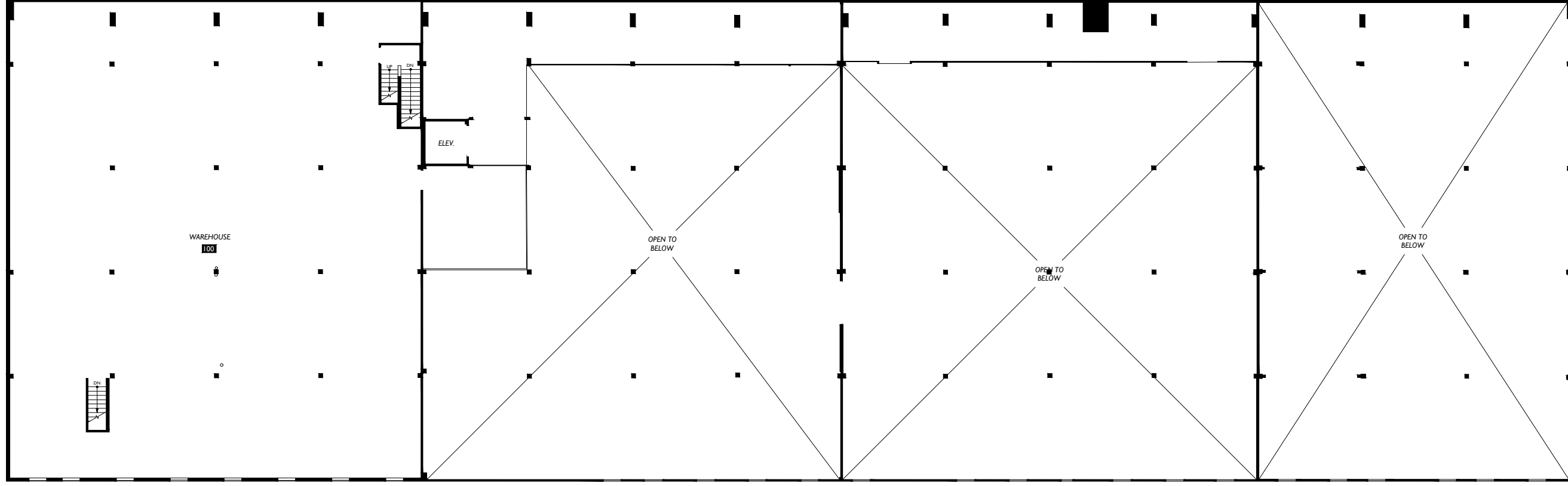

Warehouse
5422 Shilshole Avenue NW
Seattle, WA 98107

Client

Floor Plan

2

Floor

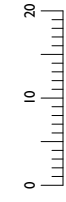

Scale



2DFLOORPLANS.COM
425-677-7511

600 NW Gilman Blvd. Suite E
Issaquah, WA 98027

Measured: May 2020
Project: C20-428

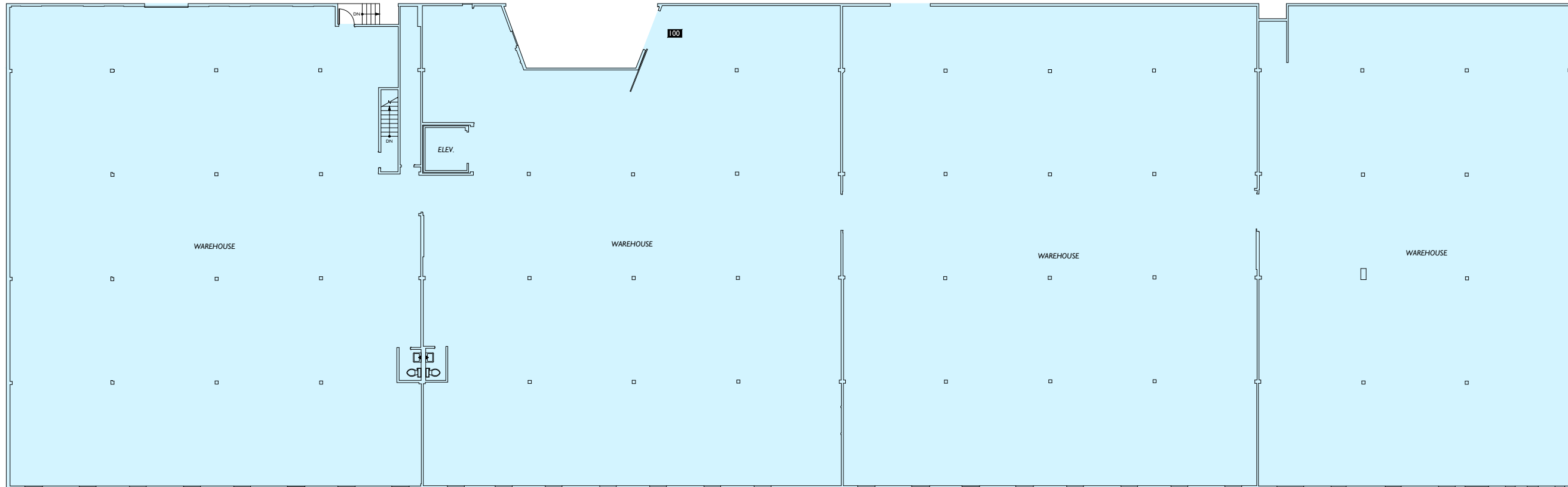

Suite #	Occupant Area
Suite 100	27,604 sq. ft.

Area Analysis performed in accordance with ANSI/BOMA Z65.2 - 2019.

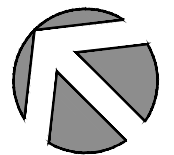

Warehouse 5422 Shilshole Avenue NW Seattle, WA 98107	Lease Plan	2DFLOORPLANS.COM 425-677-7511 600 NW Gilman Blvd. Suite E Issaquah, WA 98027
	3	AS-BUILT FLOOR PLANS
Client	Floor	Measured: May 2020 Project: C20-428
Subject	Scale	0 10 20

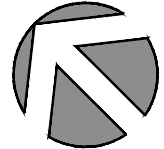
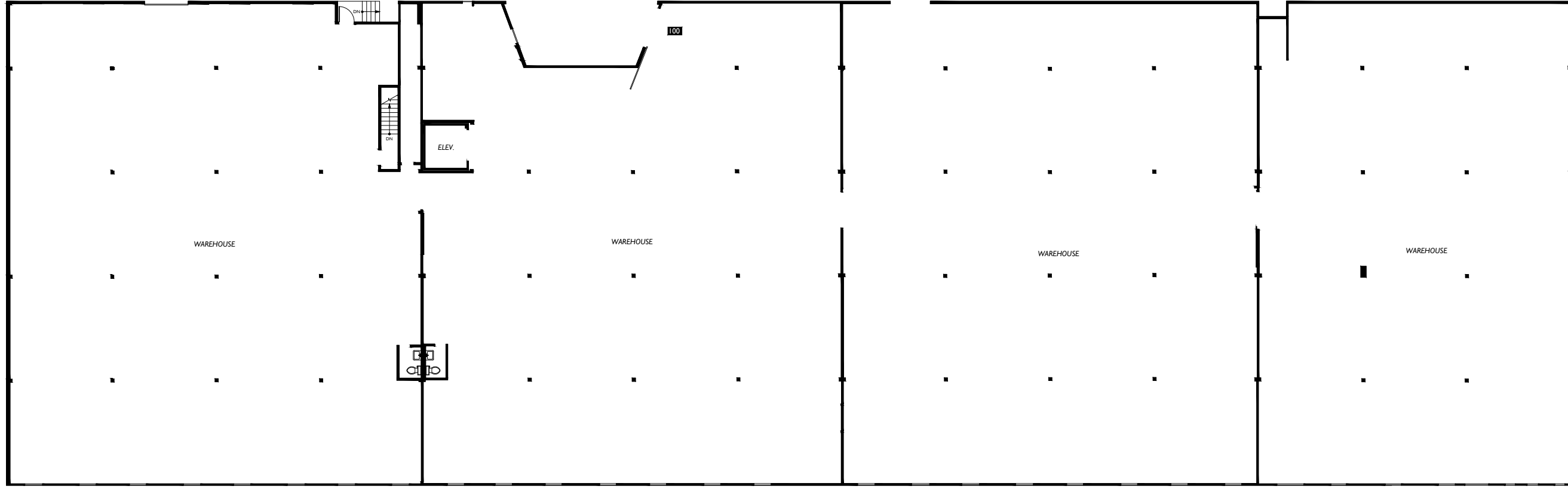

Warehouse
5422 Shilshole Avenue NW
Seattle, WA 98107

Subject

Floor Plan

3

Floor

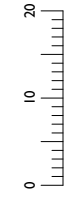

Scale

2DFLOORPLANS.COM
425-677-7511



600 NW Gilman Blvd. Suite E
Issaquah, WA 98027

Measured: May 2020

Project: C20-428

Client