

Retail Space for Lease

1400 1st Street E, Park Rapids, MN 56470

MLS #25-285



ABOUT THE PROPERTY

PROPERTY DESCRIPTION: Great visibility along the Highway 34 in Park Rapids, MN. With Pizza Ranch anchoring the retail center, this is a fantastic retail opportunity as well as Suite A offering drive thru capabilities.

AVAILABLE SPACES:

SUITE A:

1,962 SF

\$20 SF

SUITE B:

1,973 SF

\$18 SF

SUITE C:

1,749 SF

\$18 SF



PROPERTY RESOURCES GROUP

www.PropertyResourcesGroup.com

Tyler Brandt, REALTOR®

Owner/Agent

701.499.3905

tyler@prgcommercial.com

All information contained herein is believed to be true, but should be verified to the buyer's satisfaction in case of error, typographical or otherwise. All information is subject to change without further notice.

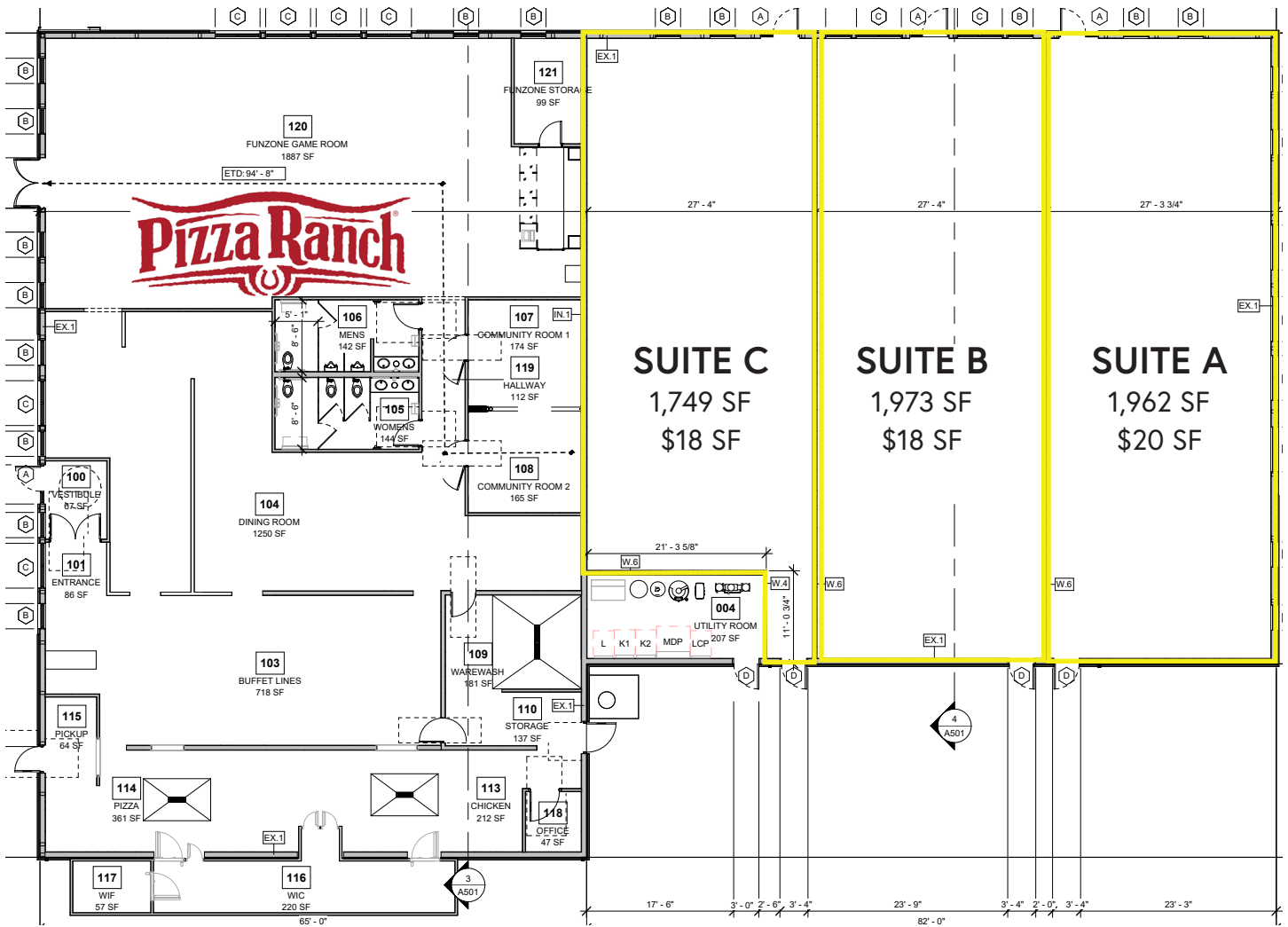

www.PropertyResourcesGroup.com

Tyler Brandt, REALTOR®
 Owner/Agent
 701.499.3905
 tyler@prgcommercial.com

All information contained herein is believed to be true, but should be verified to the buyer's satisfaction in case of error, typographical or otherwise. All information is subject to change without further notice.