

SUITE A
2,300 SF

Suite B
1,300 USF

Suite D
1,919 USF

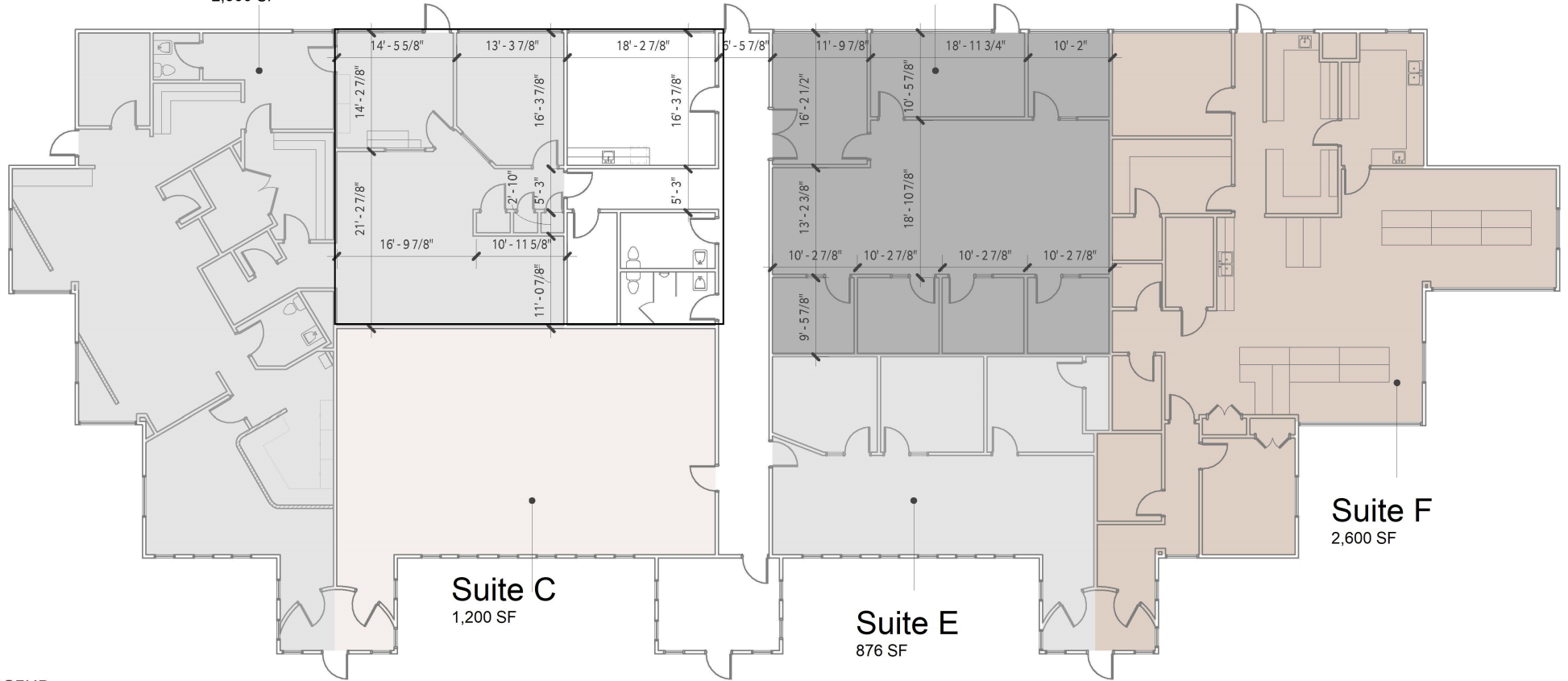

LEGEND
EXISTING OR NEW CONSTRUCTION

— EXISTING WALL

▨ PARTIAL HEIGHT WALL

⌋ EXISTING DOOR & FRAME



[SCALE]
NOT TO SCALE

AS-BUILT

1455 WEST OAK STREET
ZIONSVILLE INDIANA 46077

[DATE | REVISION]
10.28.21 | 00

