



MID-ATLANTIC
ACQUISITIONS LLC



3310 NOBLE POND WAY | WOODBRIDGE, VA

PRINCE WILLIAM COMMONS BUILDING 10



Property Features

- Office/Flex/Retail/R&D
- Potential Plug & Play Available with Flexible Terms and Shared Conference Rooms
- Ceiling Height: 24' R&D / 9'-10' Office
- Column Spacing: 40'w x 40'd
- Drive-in Doors: 12'w x 14'h
- Parking: 3.00 Ratio
- Amenities Close By
- Premier Signage
- MPSI 2010 Traffic Volume Estimate at Prince William Parkway and Golansky Blvd = 51,922
- Close to I-95 (1.4 Miles), Prince William Parkway, Ft. Belvoir, MCB Quantico and Potomac Hospital (2 Miles)
- **NOW OPEN!** New State-of-the-Art Assisted Living Facility within Prince William Commons
- **COMING SOON!** New 55+ Living Facility!



Traci Morris Cole | 703.328.7884 | tmcole@midacq.com

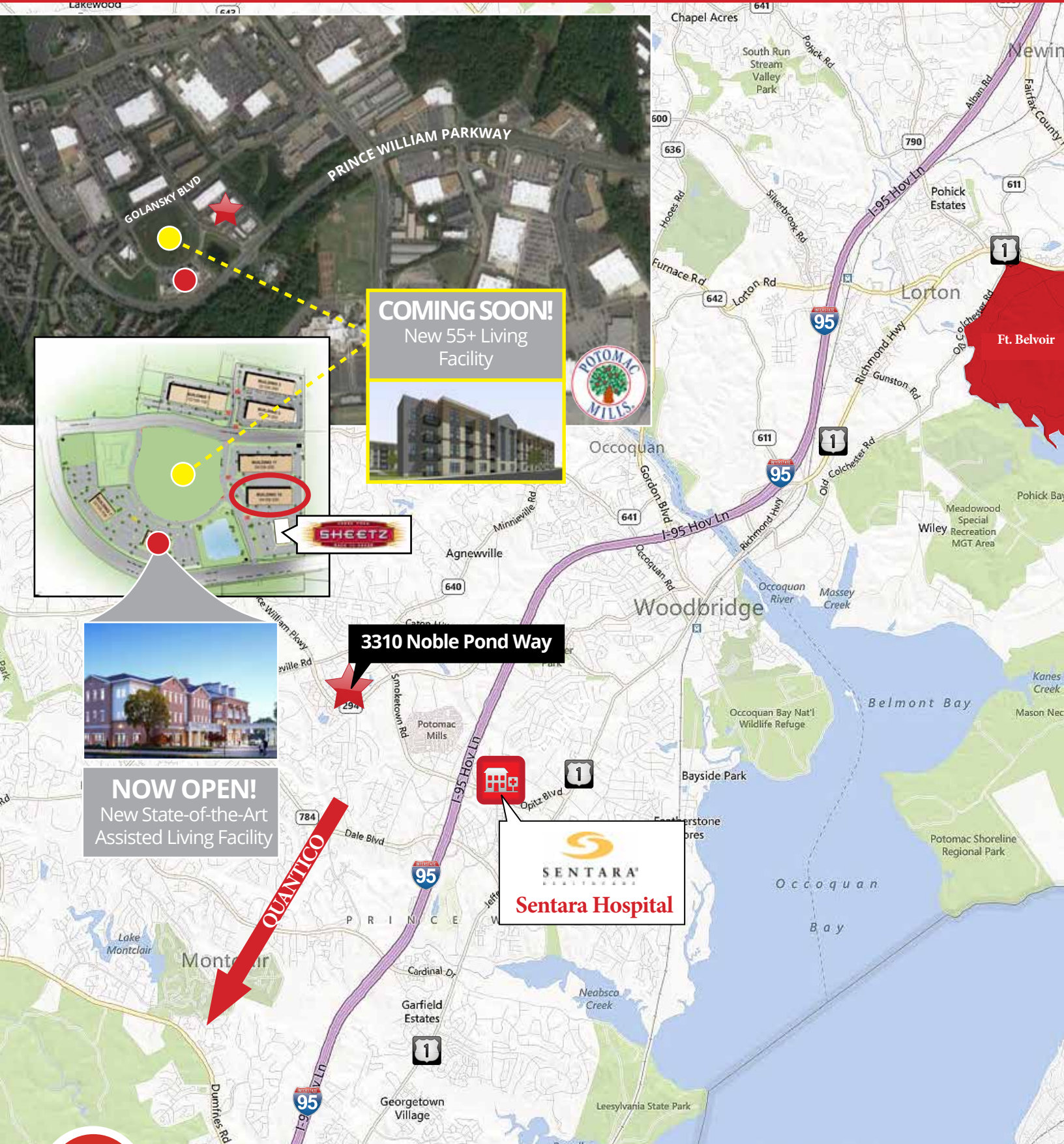

COMING SOON!
New 55+ Living Facility



3310 Noble Pond Way



NOW OPEN!
New State-of-the-Art Assisted Living Facility

Sentara Hospital



Traci Morris Cole | 703.328.7884 | tmcole@midacq.com

Second Floor

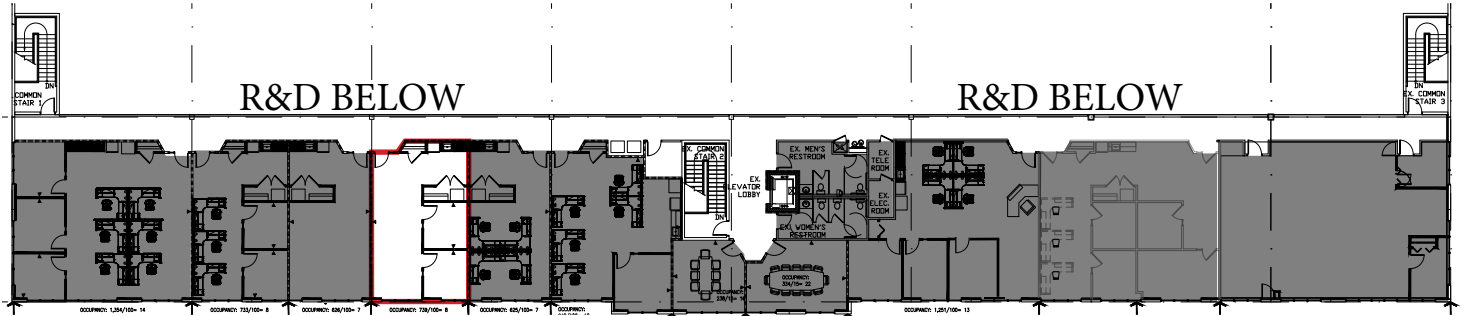

SUITE 217
901 SF

First Floor

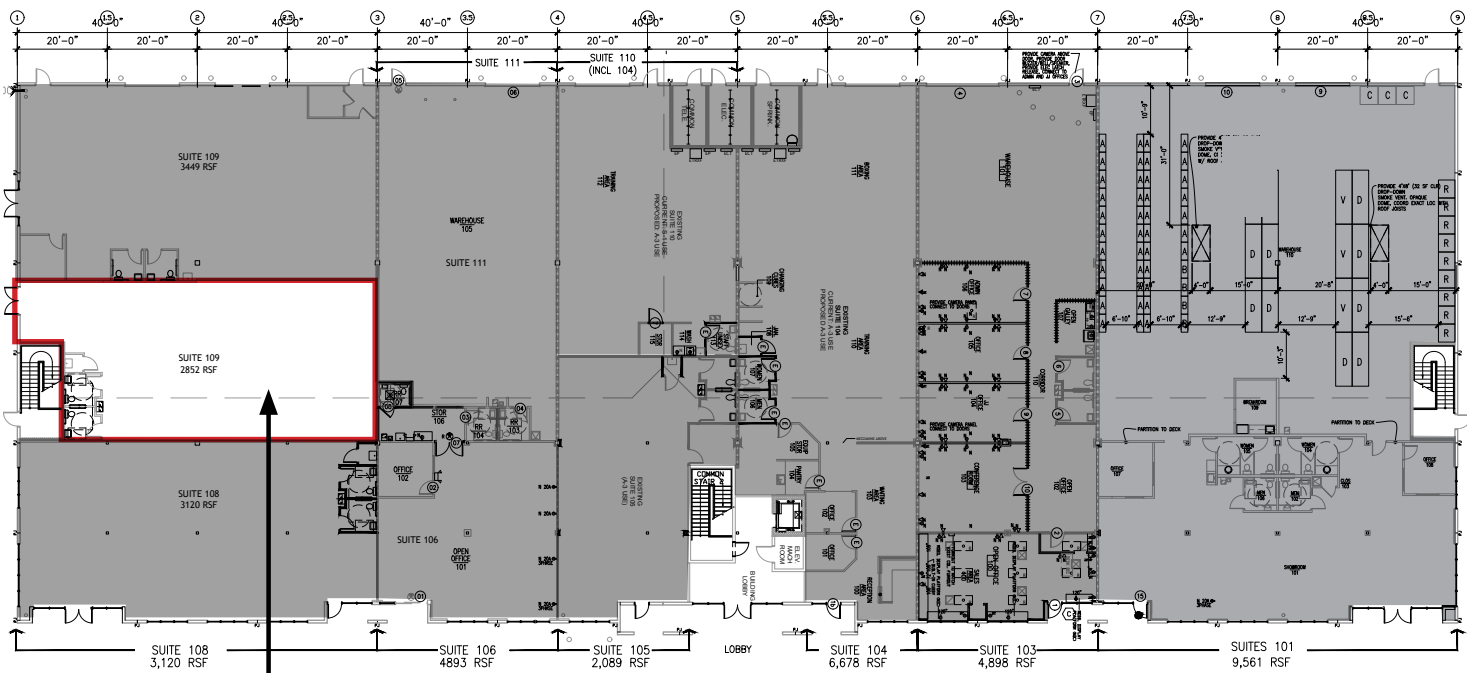

SUITE 109
2,852 SF

