

Landmark Business Park

LEASE EXHIBIT "A"

Leased Premises in office building located on Lot # 6 Landmark Business Center, Phase II commonly known as 417 and 421 S. Landmark Ave., Bloomington, Indiana.

Lease premises shown in cross-hatch below.

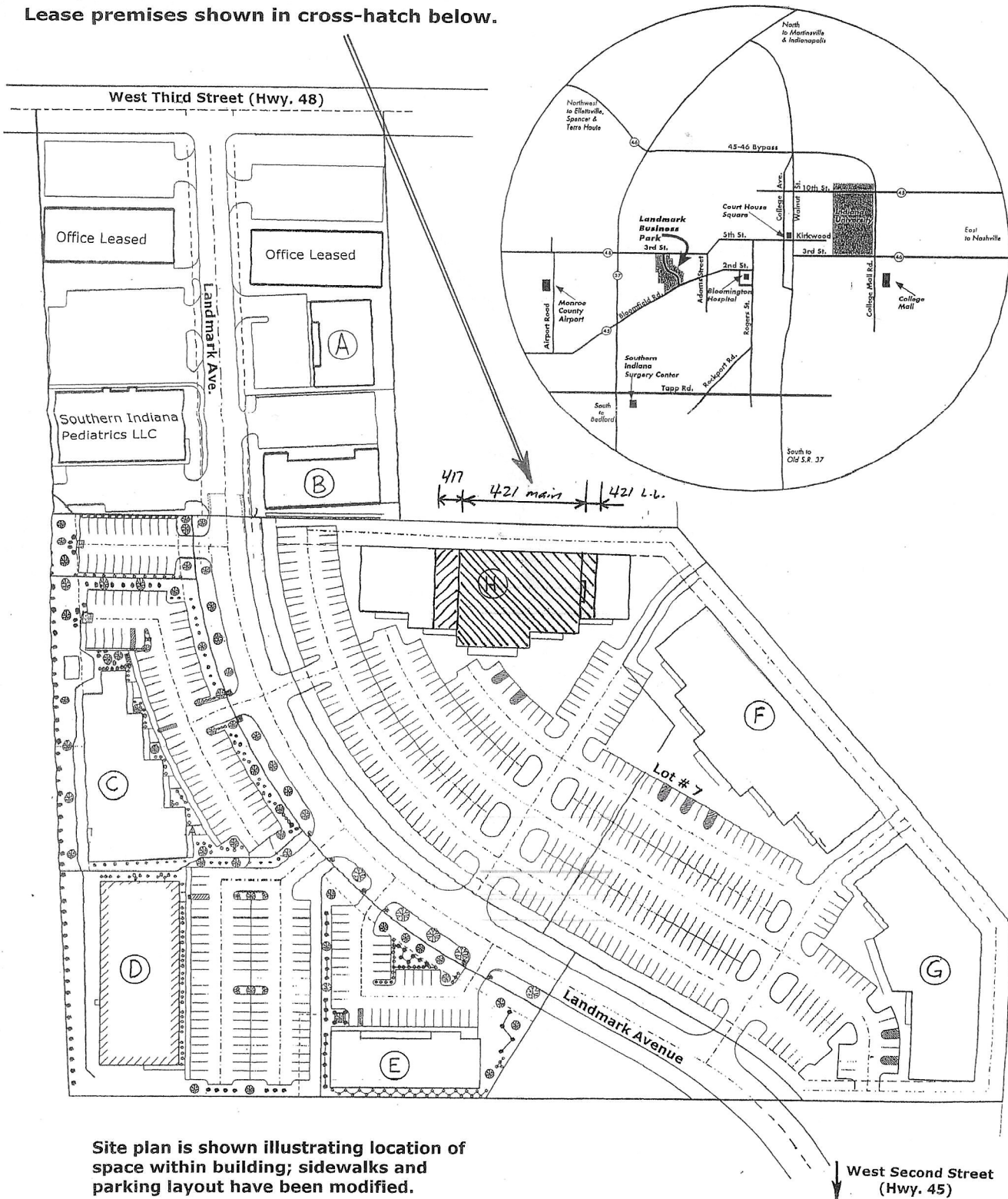

Site plan is shown illustrating location of space within building; sidewalks and parking layout have been modified.