

#1050 - 1188 West Georgia Street | Vancouver, BC

FOR SUBLEASE | View Office Space

- ▶ Class-B office building
- ▶ Fully improved, corner office premises
- ▶ Great views
- ▶ Elevator exposure
- ▶ Gym, bike storage & showers
- ▶ Great restaurants nearby

#1050 - 1188 West Georgia Street

Vancouver, BC



Building

1188 W. Georgia Street is located on the southwest corner of West Georgia and Bute Streets. The building is professionally managed by GWLRA and provides parking, secure bike storage, a (free) gym, showers & saunas, and a meeting room. Security and building operators are onsite.

The Building is conveniently located within walking distance of the Burrard Street SkyTrain station and steps away from many shops, services, restaurants and cafes found on Alberni and Robson Streets.

Premises

Beautifully well improved tech/office space with elevator exposure, double glass entry, reception area, 5 window offices, large boardroom, 2 internal offices or meeting rooms, server/storage room, large kitchen with appliances and beer taps, two open spaces with 26 and 6 workstations respectively.

The premises occupies approximately 1/2 floor and spans from across the north side with exposure on the west and east sides. Large windows and internal glazing provide abundant natural light throughout the space.

The furniture can be made available for the subtenant's use (with the sublandlord retaining ownership), if desired. The premises are located on a floor that recently had updates to the common areas and washrooms.

Property Details

Unit Size:	5,245 SF
Base Rent:	Contact Listing Broker
Additional Rent:	\$23.79/SF (2025 est.)
Availability:	Approx. 60 days notice
Sublease Expiry:	March 30, 2027



Floor Plan

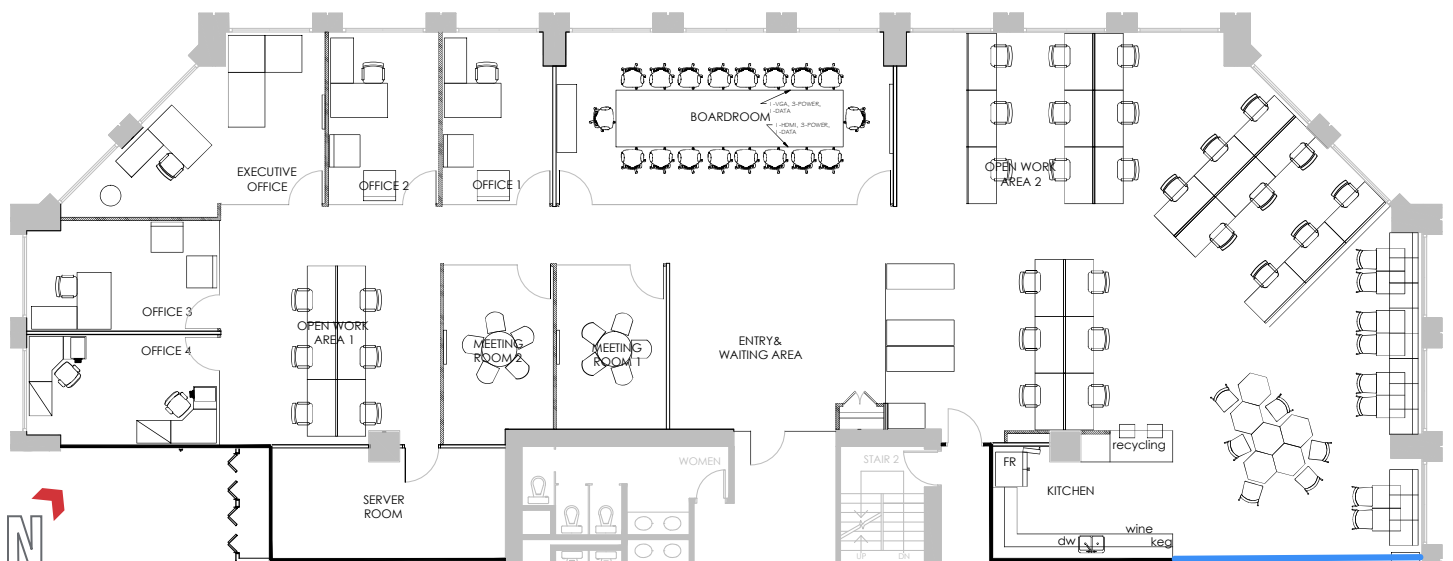





1188 WEST GEORGIA

W GEORGIA ST

BUTE ST

ROBSON ST



BUILDING GYM



WALKER'S PARADISE



RIDER'S PARADISE

Roy Gibbs, LL.B
Personal Real Estate Corporation
Commercial Leasing & Sales
778 834 4050
rgibbs@naicommercial.ca

NAICommercial

No warranty or representation, express or implied, is made as to the accuracy of the information contained herein, and the same is submitted subject to errors, omissions, change of price, rental or other conditions, prior sale, lease or financing, or withdrawal without notice, and of any special listing conditions imposed by our principals no warranties or representations are made as to the condition of the property or any hazards contained therein are any to be implied. Aerial image(s) courtesy of Google, Landsat/Copernicus

NAI Commercial
1075 W Georgia St, Suite 1300
Vancouver, BC V6E 3C9
+1 604 683 7535
naicommercial.ca