

COMMERCIAL SITE | FOR SALE

WOODLAKE COMMONS LOOP
MIDLOTHIAN, VA



ANDY WALSH
President/Principal Broker
804.308.1603
AndyW@sugaroak.com

ALLAN SHARRETT
Vice President Sales/Leasing
804.901.4454
AllanS@sugaroak.com

The Greater Richmond area is a dynamic and rapidly growing region known for its robust economy, strong transportation network, and business-friendly environment. As the capital of Virginia, Richmond boasts a thriving commercial sector, a highly skilled workforce, and a diverse mix of industries, including finance, healthcare, manufacturing, and logistics. With a strategic location along the I-95 corridor, Richmond offers excellent connectivity to major East Coast markets, making it an attractive destination for businesses looking to expand or establish operations.

Chesterfield County, one of the most sought-after areas within Greater Richmond, continues to experience significant economic development. Recognized for its excellent quality of life, top-rated schools, and a strong local economy, Chesterfield is home to a mix of residential, retail, and commercial developments. With ongoing infrastructure improvements and a growing population, the county presents a wealth of opportunities for businesses seeking strategic locations with high visibility and accessibility.



Area Overview



SITE OVERVIEW

- **Price:** \$800,000/acre
- 1.38 AC with development potential for a 2-story 24,000 SF building
- Zoned CC-1 to include retail, office and medical use
- 64,000+ potential customers in a 5-mile radius
- 2,700 homes located in Woodlake Community

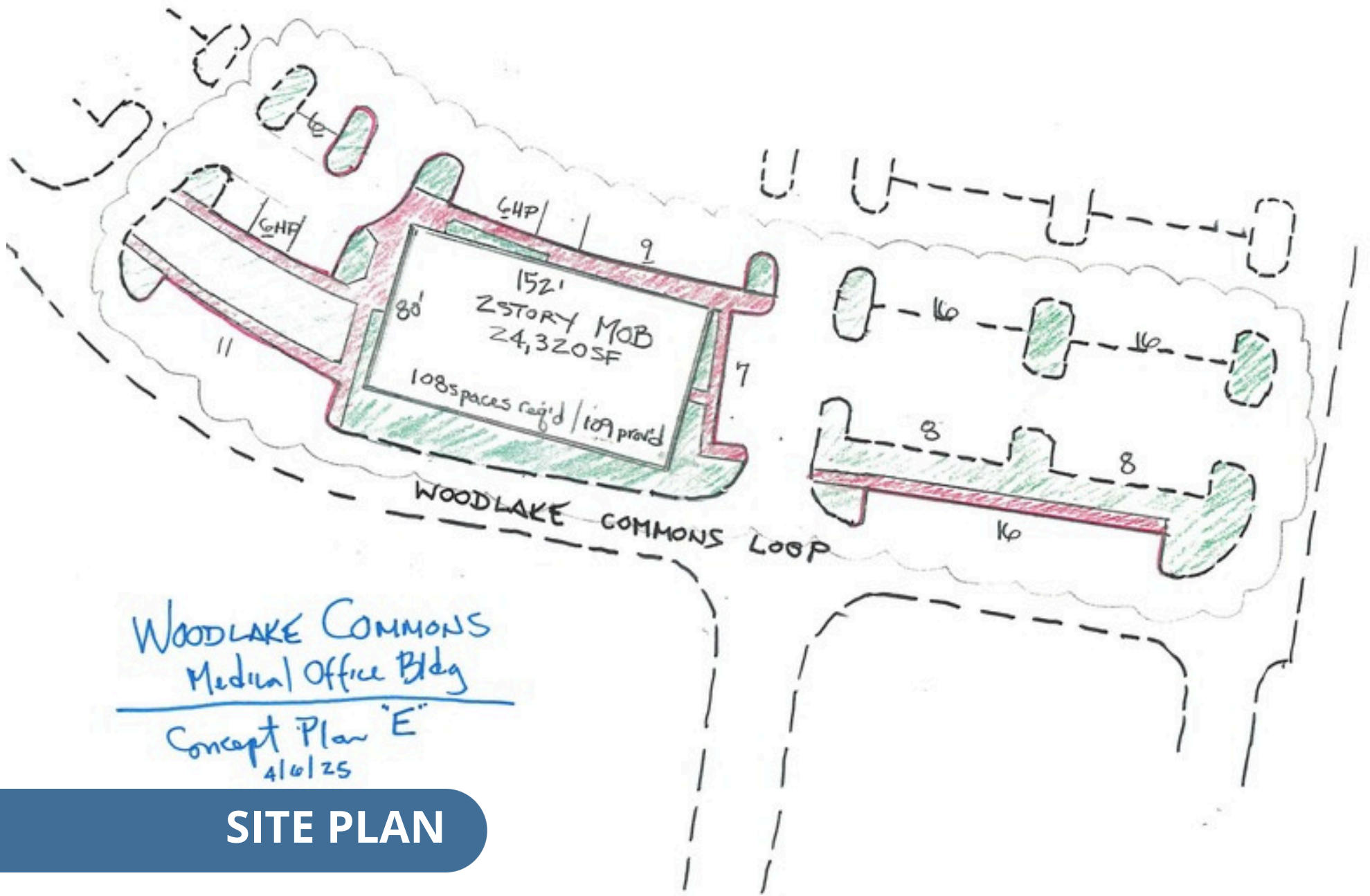

WOODLAKE COMMONS
Medical Office Bldg

Concept Plan "E"
4/6/25

SITE PLAN

Location

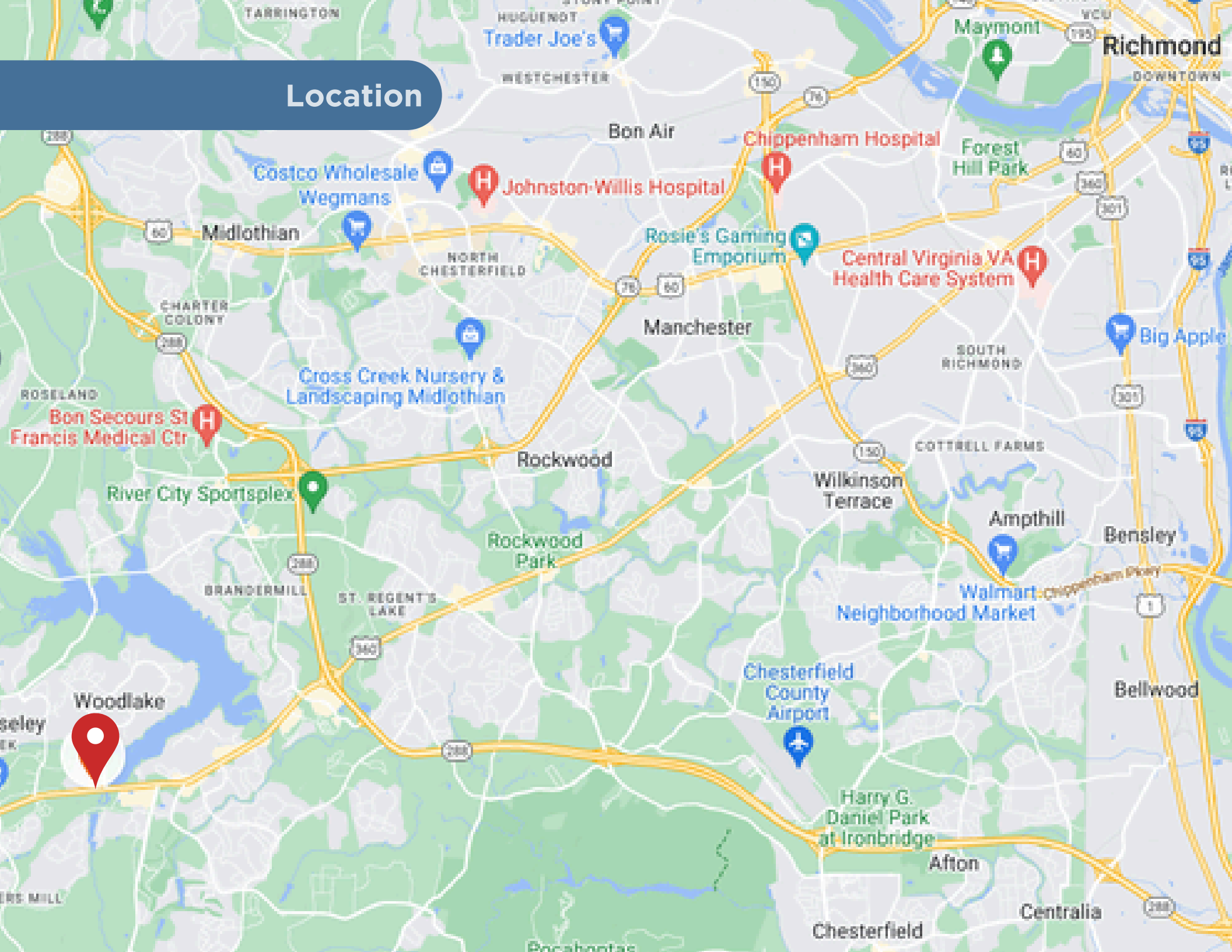

Market Aerial



TRACTOR SUPPLY CO **FERGUSON**
Wendy's **PAPA JOHN'S** **Children's Museum OF RICHMOND**
Cane's

ABC **9** **OLD PEPP**
Girl Scouts RVA **Goodwill**

LOWE'S **Chick-fil-A**
tazikis **MEDITERRANEAN CAFE**

FRANK'S **DUNKIN'** **Starbucks** **Tim Hortons**

FLOOR DECOR & **HOBBY LOBBY**
five BELOW **DICK'S SPORTING GOODS** **Walmart**
Burlington **DOLLAR TREE**

Millwood School

Cosby High School

Villas at Dogwood

Hull Street Rd

Sterling Glen Apartments