

I-610 SOUTH INDUSTRIAL FOR LEASE

1900 CROSSPOINT HOUSTON, TX 77054



Building Features

- 54,869 ± SF Total sq. ft.
 - ◊ 46,393 ± SF warehouse
 - ◊ 8,476 ± SF office
- 7 drive-ins, 2 dock wells; 1 semi-dock loading position
- 20' clear height
- 220/480 V - 800 amp service
- Fully sprinklered
- Free-standing building - tilt wall
- Fenced truck court
- Ample parking
- Estimated operating expenses: \$0.20 psf/mo.

**LEASE RATE:
\$0.68 PSF NNN**

54,869± SF Available



Walking distance to METRORail

Excellent proximity to the Texas Medical Center

Contact Broker For More Information:

Robyn Berry
713-629-5535
robyn@evtex.com

Joe Evans
281-955-5535
Joe@evtex.com



Evtex Companies
11777 Katy Fwy. | Ste. 320 South
Houston, TX 77079
713-629-5535

The information herein has been obtained from sources believed reliable. While we do not doubt its accuracy, we have not verified it and make no guarantee, warranty or representation about it. It is your responsibility to independently confirm its accuracy and completeness. Any projections, opinion, assumptions or estimates used are for example only and do not represent the current future performance of the property. The value of this transaction to you depends on tax and other factors which should be evaluated by your tax, financial, and legal advisors. You and your advisors should conduct a thorough independent investigation of this property to determine the suitability of the property for your needs.

SOUTH LOOP INDUSTRIAL FOR LEASE

1900 CROSSPOINT HOUSTON, TX 77054

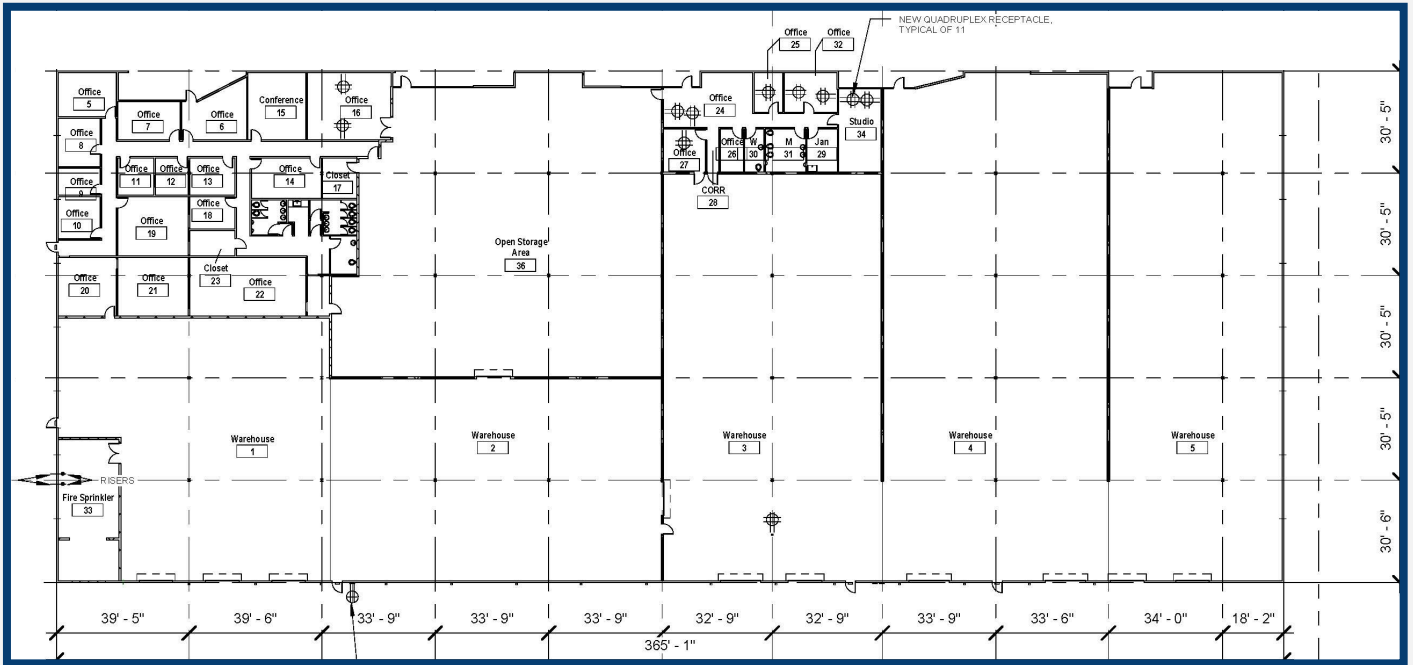

Contact Broker For More Information:

Robyn Berry
713-629-5535
robyn@evtex.com

Joe Evans
281-955-5535
Joe@evtex.com



Evtex Companies
11777 Katy Fwy. | Ste. 320 South
Houston, TX 77079
713-629-5535

The information herein has been obtained from sources believed reliable. While we do not doubt its accuracy, we have not verified it and make no guarantee, warranty or representation about it. It is your responsibility to independently confirm its accuracy and completeness. Any projections, opinion, assumptions or estimates used are for example only and do not represent the current future performance of the property. The value of this transaction to you depends on tax and other factors which should be evaluated by your tax, financial, and legal advisors. You and your advisors should conduct a thorough independent investigation of this property to determine the suitability of the property for your needs.