

Available SF 6,000 SF

Industrial For Sale

Building Size 6,000 SF



Address: 3408 Fowler St, Los Angeles, CA 90063

Cross Streets: Fowler St/Adkisson Ave

Immaculate Concrete Block Building / 1990 Construction
 10-Car Rooftop Parking
 18' Clearance, Fire Sprinklers
 Dock High Loading, 400 Amps of 3-Phase Power
 Immediate Access to (10), (710), (5) & (101) Fwys
 Ideal for Warehousing, Manufacturing & Creative Uses

Sale Price: \$1,595,000.00
Sale Price/SF: \$265.83
Available SF: 6,000 SF
Prop Lot Size: 0.11 Ac / 4,800 SF
Taxes:
Yard: Fenced / Paved
Zoning: LCM1

Sprinklered: Yes
Clear Height: 18'
GL Doors/Dim: 0
DH Doors/Dim: 1
A: 400 V: 240 O: 3 W: 4
Construction Type: Masonry
Const Status/Year Blt: Existing / 1990

Whse HVAC: No
Parking Spaces: 10 / **Ratio:** 1.7:1
Rail Service: No
Specific Use: Warehouse/Office

Office SF / #: 1,700 SF / 2
Restrooms: 2
Office HVAC: Heat & AC
Finished Ofc Mezz: 1,200 SF
Include In Available: Yes
Unfinished Mezz: 0 SF
Include In Available: No
Possession: COE
Vacant: Yes
To Show: Call broker
Market/Submarket: Outlying Los Angeles
APN#: 5224-015-011

Listing Company: Reavis Realty
Agents: [Eric Reavis 213-709-6760](mailto:eric@reavisrealty.com)

Listing #: 44754755 **Listing Date:** 04/23/2026 **FTCF:** CB000N000S250/A0AA

Notes: Buyer to independently verify all information and specifications. Unincorporated LA County - no municipal business tax. Dock height is 3'.





6,000 SF | 3408 FOWLER ST., LOS ANGELES 90063

SITE PLAN

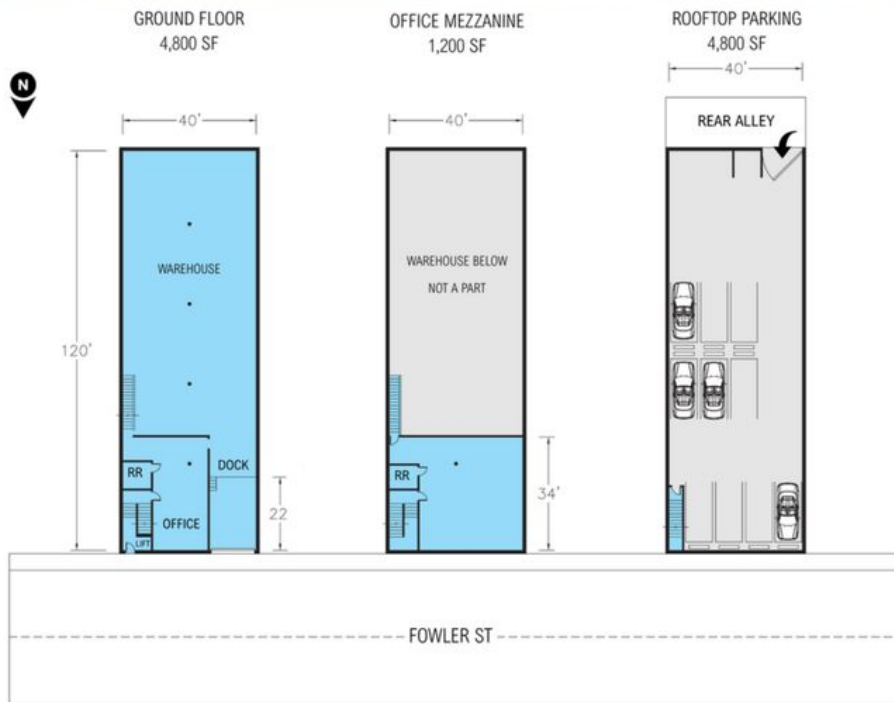

Not to scale. All measurements are approximate. Site plan may not reflect current office layout, parking layout and/or truck loading positions.

3408 FOWLER ST ERIC REAVIS, SIOR 01216423 213.709.6760 eric@reavisrealty.com

