

For Lease

RETAIL SPACE IN NORTHWEST WINNIPEG



STURGEON CREEK VILLAGE

3025 NESS AVENUE, WINNIPEG, MB

PROPERTY DETAILS

LAND AREA	1.6 acres (+/-)
CENTRE GLA	17,600 sq. ft. (+/-)
AREA AVAILABLE	Unit J: 1,000 sq. ft. (+/-)
ZONING	C2 Commercial
TRAFFIC COUNT	32,700 average vehicles per day (Ness Avenue & Sturgeon Road)
NET RENTAL RATE	\$17.50 per sq. ft. net per annum
ADDITIONAL RENT	\$9.13 per sq. ft. (plus mgmt fee of 5% of net rent)
AVAILABILITY	September 1, 2020

HIGHLIGHTS

- High visibility corner at light controlled intersection of Ness Avenue and Sturgeon Road
- Close proximity to Murray Industrial Park and Sturgeon Heights Collegiate
- Pylon signage available
- Ample parking on site

CONTACT

Bob Antymniuk

Senior Advisor - Sales & Leasing
(204) 985-1364
bob.antymniuk@capitalgrp.ca

STURGEON CREEK VILLAGE 3025 Ness Ave., Winnipeg, MB

LOCATION MAP

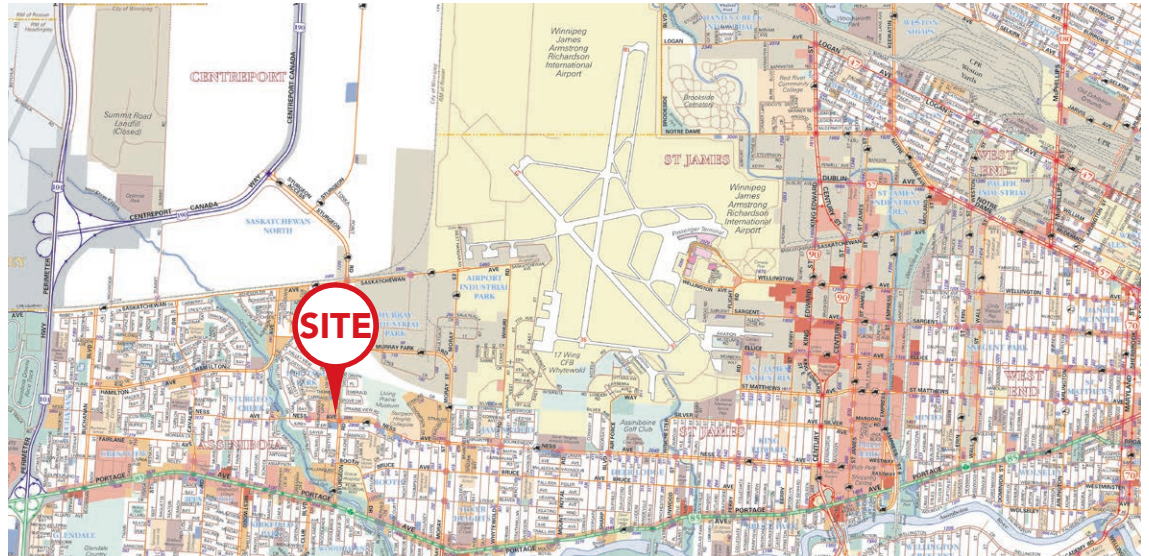

ZONING MAP



STURGEON CREEK VILLAGE

3025 Ness Ave., Winnipeg, MB

SITE PLAN

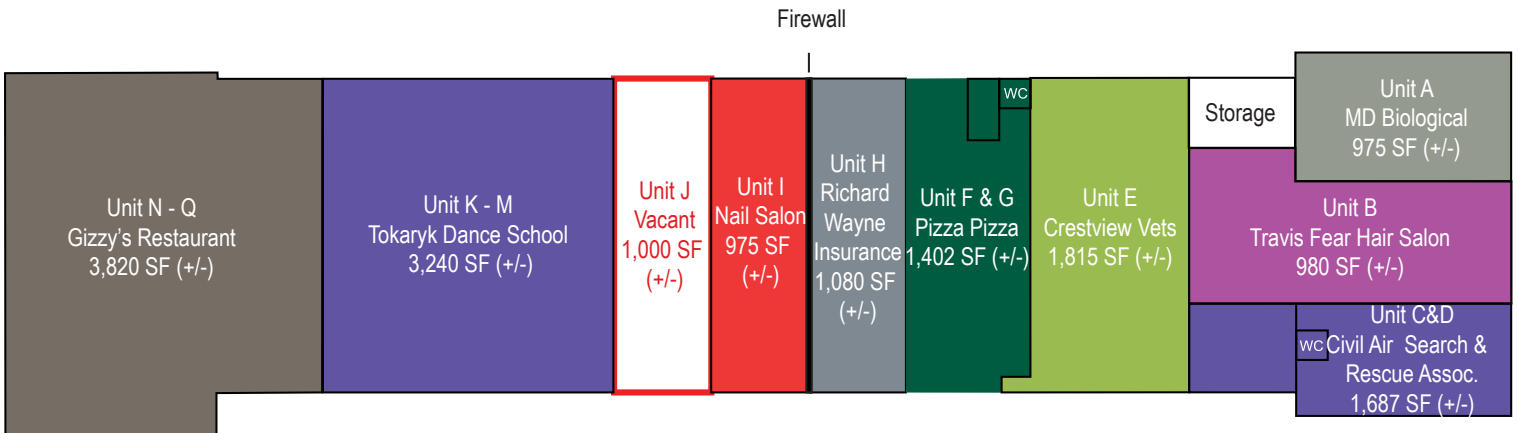

SITE AERIAL









STURGEON CREEK VILLAGE

3025 Ness Ave., Winnipeg, MB

DEMOGRAPHIC ANALYSIS



 POPULATION 1 KM 8,740 3 KM 51,575 5 KM 88,143	 PROJECTED POPULATION (2029) 1 KM 9,486 3 KM 58,726 5 KM 102,970	 MEDIAN AGE 1 KM 43 3 KM 43 5 KM 43
 TOTAL HOUSEHOLDS 1 KM 3,676 3 KM 22,234 5 KM 36,716	 AVERAGE HOUSEHOLD INCOME 1 KM \$79,413 3 KM \$96,315 5 KM \$110,365	 PROJECTED HOUSEHOLD INCOME (2029) 1 KM \$102,262 3 KM \$122,623 5 KM \$141,957

CONTACT

Bob Antymniuk
 Senior Advisor - Sales & Leasing
 (204) 985-1364
 bob.antymniuk@capitalgrp.ca

capitalgrp.ca



Disclaimer: Capital Commercial Real Estate Services Inc. ("Capital") does not accept or assume any responsibility or liability, direct or consequential, for the information set out herein, including, without limitation, any projections, images, opinions, assumptions and estimates obtained from third parties. This information has not been verified by Capital, and Capital does not guarantee the accuracy, correctness and completeness of this information. The recipient of this information should take such steps as the recipient may deem necessary to verify the information in this document prior to placing any reliance upon it. The information may change and any property described in this document may be withdrawn from the market at any time without notice or obligation to the recipient from Capital.