

Lowered Lease Rate!



2905 S. Cherry Lane

Fort Worth, TX 76116

OFFICE/RETAIL/FLEX SPACE FOR LEASE

 Transwestern

PROPERTY INFORMATION:

- 10,800 SF Building
- 100% HVAC
- Prime corner location with high visibility along S Cherry Lane
- Quick access to I-30, Loop 820, and major West Fort Worth corridors
- Surrounded by established residential neighborhoods and local businesses
- Zoned "E" Neighborhood Commercial
- Ideal for retail, office, service, or healthcare users
- Ample parking for tenants and customers
- Prominent building signage opportunities

PRICING INFORMATION:

- \$12,000/Month + NNN's
- NNN's Estimated at \$3.85/SF

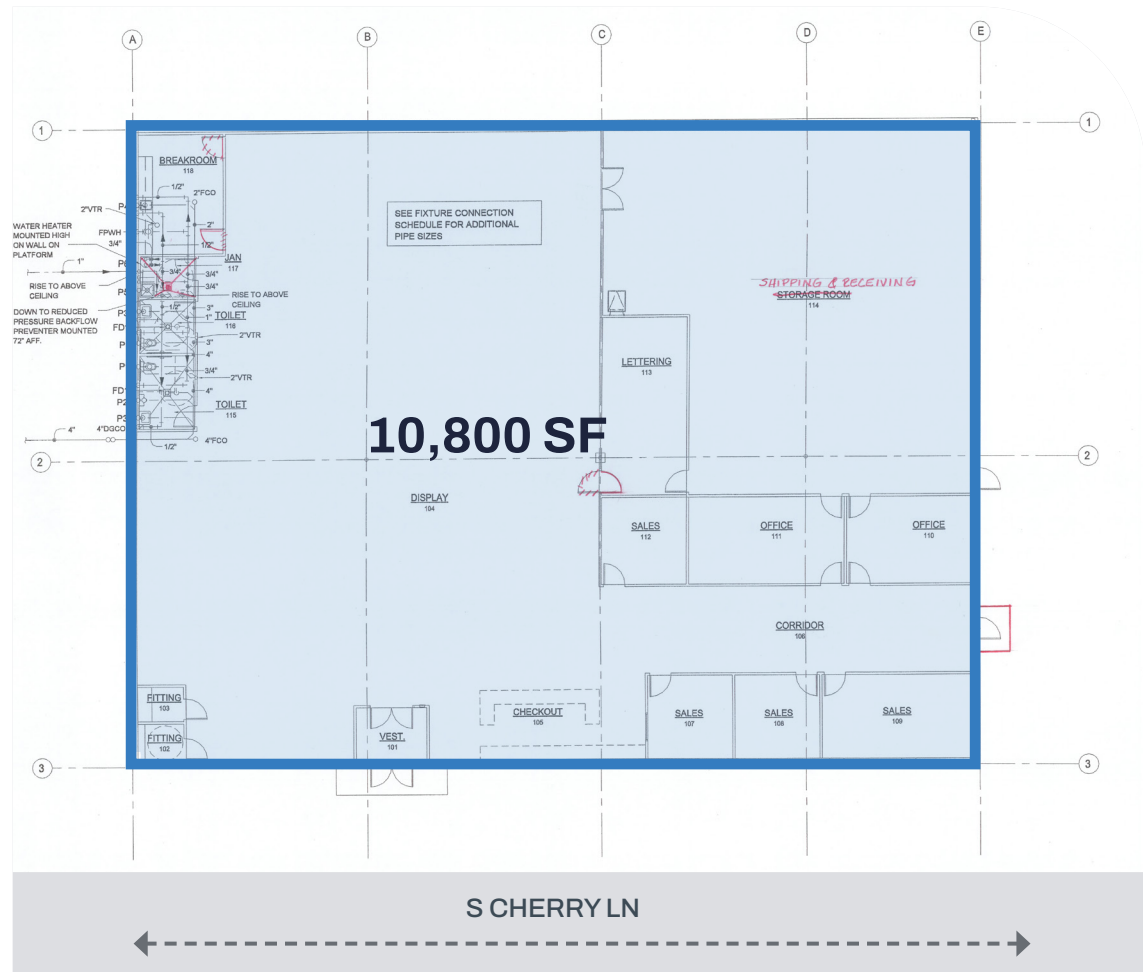

Gibson Duwe

(817) 713-9238
Gibson.Duwe@Transwestern.com

Kyle Poulson

(817)291-4455
Kyle.Poulson@transwestern.com



Get in Touch

Gibson Duwe

(817) 713-9238

Gibson.Duwe@Transwestern.com

Kyle Poulson

(817)291-4455

Kyle.Poulson@transwestern.com