

Rail served and fully air-conditioned



For Lease

80,000 RSF Available / 4.14 acres
Industrial Warehouse

**916 Commerce Circle
Hanahan, SC 29410**

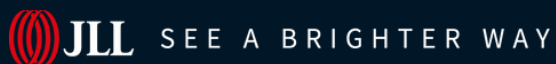

Lee Allen
Executive Managing Director
lee.allen@jll.com
+1 843 805 5111

Kevin Coats
Senior Managing Director
kevin.coats@jll.com
+1 843 805 5110

Tyler Smith
Senior Associate
tyler.smith@jll.com
+1 843 805 5118

Brooke Eyrich
Associate
brooke.eyrich@jll.co
m +1 301 525 3237

916 Commerce Circle Hanahan, SC 29410

Building SF	80,000 SF
Site size	4.20 acres
Office SF	1,600 SF
Clear height	24', 18.5' lowest part of joist
Column spacing	25' x 40', 80' x 25' centerline bay
Dock doors	80' loading docks, 8 dock positions
Drive-in doors	3
Rail doors	2, (1) positioned with 180' x 13' wide dock, (1) positioned with 14' x 13' dock
Sprinklers	Wet system
Lighting	LED
Flooring	SIKA Epoxy Mortar

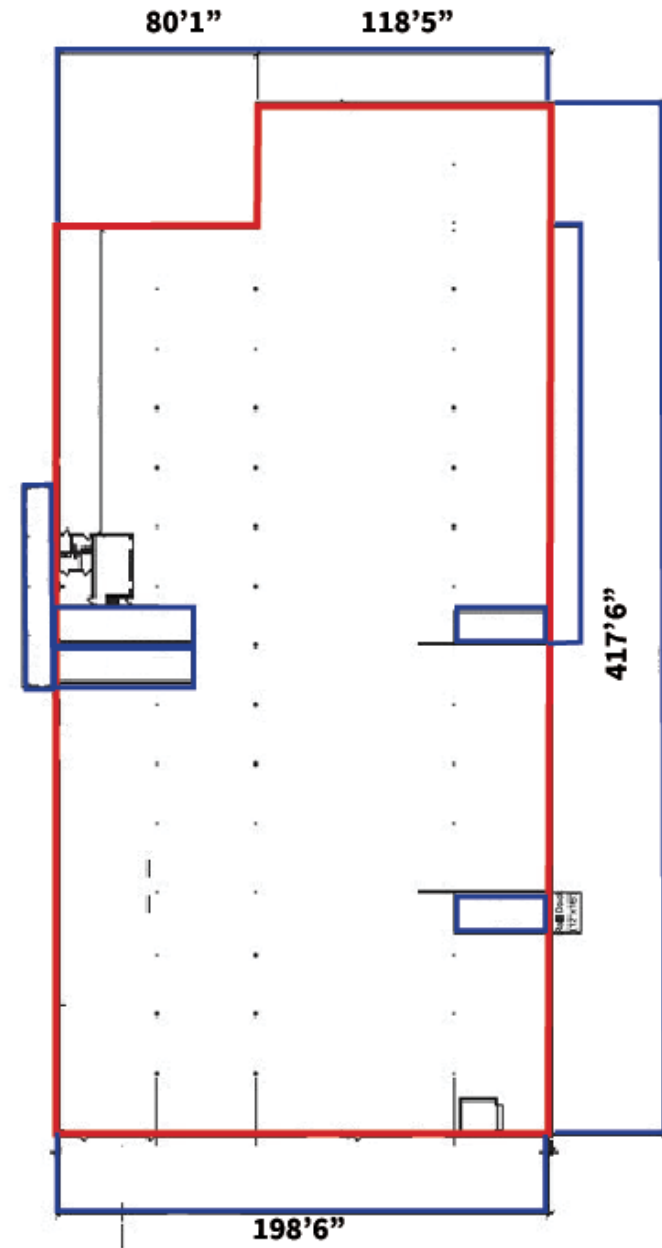

916 Commerce Circle Hanahan, SC 29410

- Superior access to Charleston's Industrial Ports
- 0.75 miles to I-526
- 3.0 miles to I-26
- 55 miles to I-95



The building underwent major improvements including new sprinkler and security systems, perimeter fencing, new lighting, and resealed floors